



LED UFO NSF HIGH BAY

► **DESIGN & OPTIONS** - NSF LED UFO HIGH BAY has best in class performance with a 130-150lm/W output. The fixtures feature a smooth dust-proof surface that can withstand frequent wash downs and is built with safety and sanitation in mind. It has an easy-to-clean, corrosion-resistant aluminum housing and comes with 120-277V or 200-480V and a 5000K color temperature. It is equipped with a 0-10V dimmable driver and comes with a WHITE finish.

► **INSTALLATION** - This fixture comes with a stainless steel hanging ring for suspended mounting and with a 6.5ft cable to make the installation process easier. Refer to install instructions for detailed steps.

► **APPLICATION** - NSF LED UFO HIGH BAY fixtures are ideal for areas with high sanitation standards and are required to be frequently washed down. Common applications include: poultry processing, food & beverage processing, commercial kitchens, and manufacturing facilities. These fixtures are Wet location rated with IP69K ingress protection rating, meaning they are resistant to high pressure, temperature, water, and dust. These lights can operate in temperatures between -40+122°F (-40+50°C).

► **ENERGY SAVINGS & EFFICIENCY** - This fixture provides a lumen output equal to MH/HPS and can cut your electric bill by up to 80% instantly. With a lifespan of 60,000 hours, these fixtures are made to last decades under normal operation! This fixture will save you a significant amount of money in its lifetime.

► **CERTIFICATION & WARRANTY** - Buy with confidence: ASD provides a 5-year warranty along with UL or ETL and DLC Premium certifications to guarantee top quality products and safety! Certified by the National Sanitation Foundation (NSF) as safe for food service processing facilities that require a higher level of sanitation.

Top US certifications allow participation in rebates; please check the rebate programs available in your state.

Catalog number	
Notes	
Type	

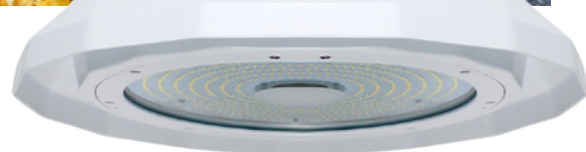

UHB-FS

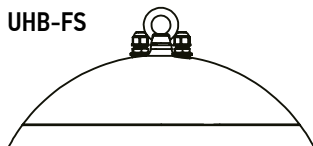

UHB2-FS

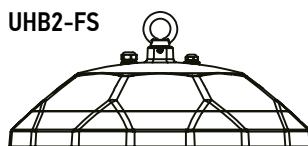

PRODUCT LEGEND:

Family	Voltage	NSF standard	Watts	Dimmable	CCT	Series
ASD-UHB	XX	XX	XXX	X	XX	XXX
LED UFO High Bay	Blank = 120-277V HV = 200-480V	FS = Food Safety	100 = 100 W 150 = 150 W 200 = 200 W	D = Dimmable	50 = 5,000 K	PRM = Premium Blank = Premium

LED UFO NSF HIGH BAY FIXTURE:

Model	Watts	Voltage	Dimmable	CCT	Lumens	Dimensions (LxWxH)	Cord
ASD-UHB-FS-100D50-PRM	100 W	120-277 V	0-10 V	5,000 K	13,069 lm	13 3/8" x 13 3/8" x 4 3/4"	6.5 ft
ASD-UHB-FS-150D50-PRM	150 W	120-277 V	0-10 V	5,000 K	20,142 lm	15 1/2" x 15 1/2" x 5 1/4"	6.5 ft
ASD-UHBHV-FS-150D50-PRM	150 W	200-480 V	0-10 V	5,000 K	21,356 lm	15 1/2" x 15 1/2" x 5 1/4"	6.5 ft
ASD-UHB2-FS-150D50	150 W	120-277 V	0-10 V	5,000 K	21,900 lm	17 1/8" x 17 1/8" x 7 9/16"	6.5 ft
ASD-UHB2-FS-200D50	200 W	120-277 V	0-10 V	5,000 K	29,200 lm	17 1/8" x 17 1/8" x 7 9/16"	6.5 ft

ORDERING INFORMATION:

Model	Pcs. per Carton	Carton Size	Carton Weight	UPC
ASD-UHB-FS-100D50-PRM	1	15.1" x 15.1" x 7.8"	14.6 lb	819201026036
ASD-UHB-FS-150D50-PRM	1	17.4" x 17.4" x 7.9"	16.5 lb	819201026050
ASD-UHBHV-FS-150D50-PRM	1	17.4" x 17.4" x 7.9"	16.8 lb	819201026043
ASD-UHB2-FS-150D50	1	18.7" x 18.7" x 7.5"	17.9 lb	810050734424
ASD-UHB2-FS-200D50	1	18.7" x 18.7" x 7.5"	18.7 lb	810050734431

For most up-to-date spec sheets please refer to asd-lighting.com

ASD LIGHTING CORP

E-mail: orders@asd-lighting.com | Web site: www.asd-lighting.com





LED UFO NSF HIGH BAY

PRODUCT SPECIFICATIONS:

Construction & Materials				
Housing	Die-cast Aluminum			
Finish	White			
Weight	ASD-UHB-FS-100D50-PRM 12.8 lb (5.8 kg)			
	ASD-UHB-FS-150D50-PRM 15 lb (6.8 kg)			
	ASD-UHBHV-FS-150D50-PRM 15.2 lb (6.9 kg)			
	ASD-UHB2-FS-150D50 15 lb (6.8 kg)			
ASD-UHB2-FS-200D50 15.9 lb (7.2 kg)				
Environmental System				
Work Environment	ASD-UHB-FS-100D50-PRM ASD-UHB-FS-150D50-PRM ASD-UHBHV-FS-150D50-PRM			
	Suitable for Wet Locations, IP65/69K			
	ASD-UHB2-FS-150D50 ASD-UHB2-FS-200D50			
	Suitable for Wet Locations, IP66/69K			
Operating Temperature	ASD-UHB-FS-100D50-PRM ASD-UHB-FS-150D50-PRM ASD-UHBHV-FS-150D50-PRM			
	-40°F to 122°F (-40°C to 50°C)			
	ASD-UHB2-FS-150D50 ASD-UHB2-FS-200D50			
	-40°F to 113°F (-40°C to 45°C)			
L-70 Life	ASD-UHB-FS-100D50-PRM ASD-UHB-FS-150D50-PRM ASD-UHBHV-FS-150D50-PRM			
	R > 54,000 hrs; C > 372,000 hrs			
	ASD-UHB2-FS-150D50 ASD-UHB2-FS-200D50			
	R > 60,000 hrs; C > 132,000 hrs			
Optical System				
Luminous Flux	ASD-UHB-FS-100D50-PRM 13,069 lm			
	ASD-UHB-FS-150D50-PRM 20,142 lm			
	ASD-UHBHV-FS-150D50-PRM 21,356 lm			
	ASD-UHB2-FS-150D50 21,900 lm			
	ASD-UHB2-FS-200D50 29,200 lm			
Color Temperature	5,000 K			
CRI	> 80			
Electrical System				
Input Voltage	Regular Voltage: 120-277 V High Voltage: 200-480 V			
	ASD-UHB-FS-100D50-PRM ASD-UHB-FS-150D50-PRM ASD-UHBHV-FS-150D50-PRM			
Max input current	0.6 A			
	ASD-UHB2-FS-150D50 1.25 A ASD-UHB2-FS-200D50 2.4 A			
Inrush current (Action time)	ASD-UHB-FS-100D50-PRM 35 A (1 S)			
	ASD-UHB-FS-150D50-PRM 35 A (0.79 S)			
	ASD-UHB2-FS-150D50 130 A (1 S)			
	ASD-UHB2-FS-200D50 130 A (1 S)			
AC input range	Regular Voltage: min 90 V max 305 V High Voltage: min 180 V max 528 V			
Off State Power	0 W			
Surge protection	4 kV			
Power Consumption	ASD-UHB-FS-100D50-PRM 100 W			
	ASD-UHB-FS-150D50-PRM ASD-UHBHV-FS-150D50-PRM ASD-UHB2-FS-150D50			
	150 W			
	ASD-UHB2-FS-200D50 200 W			
Power Factor	> 0.9			
Output voltage	ASD-UHB-FS-100D50-PRM ASD-UHB-FS-150D50-PRM ASD-UHBHV-FS-150D50-PRM ASD-UHB2-FS-150D50			
	48 V			
	ASD-UHB2-FS-200D50			
	180-260 V			
Max output current	ASD-UHB-FS-100D50-PRM 2.1 A			
	ASD-UHB-FS-150D50-PRM 3.16 A			
	ASD-UHBHV-FS-150D50-PRM 0.6 A			
	ASD-UHB2-FS-150D50 0.9 A			
	ASD-UHB2-FS-200D50 0.6 A			
	ASD-UHB2-FS-200D50 0.9 A			
LED driver class	ASD-UHB-FS-100D50-PRM ASD-UHB-FS-150D50-PRM ASD-UHBHV-FS-150D50-PRM			
	Class 2			
	ASD-UHB2-FS-150D50 ASD-UHB2-FS-200D50			
	Class 1			
Dimming compatible controls				
Brand	LTECH	LUTRON	LEVITON	RAB
Models	E610P	NFTV	ZS057-DOZ	LCLC3/D10

Regular and Voluntary Certifications	
5-year limited warranty	
DesignLights Consortium (DLC) listed (Classification: Premium) Main: Indoor Luminaires; General Application: High-Bay; Primary Use: High-Bay Luminaires for Commercial and Industrial Buildings	
cETLus certified 4010110	for models ASD-UHB-FS-100D50-PRM, ASD-UHB-FS-150D50-PRM, ASD-UHBHV-FS-150D50-PRM
cULus listed	for models ASD-UHB2-FS-150D50, ASD-UHB2-FS-200D50
National Sanitation Foundation	

PACKAGE CONTENTS:

Description	Q-ty
LED UFO NSF High Bay	1
Mounting ring (A)	1
Box	1
Cut sheet	2

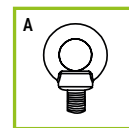

INSTALLATION GUIDE

IMPORTANT SAFETY INFORMATION:

Please read all the instructions below before installation.

- ▶ Make sure that the supply voltage corresponds to the rated product voltage.
- ▶ The product must be installed by a qualified electrician in accordance with the National Electrical Code and corresponding local codes.
- ▶ If the product is damaged, do not use it.

⚠ WARNING

RISK OF PERSONAL INJURY – READ and follow all WARNINGS and installation instructions.

Keep or give to the owner for future reference.

Risk of cuts: Wear gloves to prevent cuts or abrasions when removing from carton, handling, installing, and maintaining this product.

Risk of electric shock: This product must be installed in accordance with the applicable installation code by a person familiar with the construction and operation of the product and the hazards involved.

Risk of Fire: Minimum 194°F supply conductors. Consult a qualified electrician to ensure correct branch circuit conductor.

ASD® assumes no responsibility for claims arising out of improper or careless installation or handling of this product.

ELECTRICAL SCHEMATIC DIAGRAM:

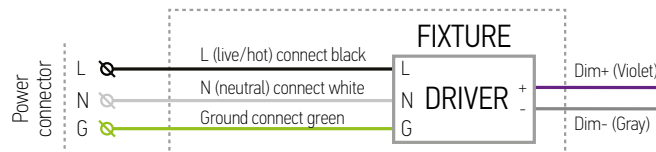

INSTALLATION STEPS:

1. Screw the mounting ring into the top of the fixture.
2. Hang the fixture from the ceiling or other surface using a hook or chain (not provided).
3. Connect the wiring in accordance with the wiring diagram in these specifications. If you are not using the dimming wires cap them off but not together. After the installation, please confirm whether the wiring is correct.

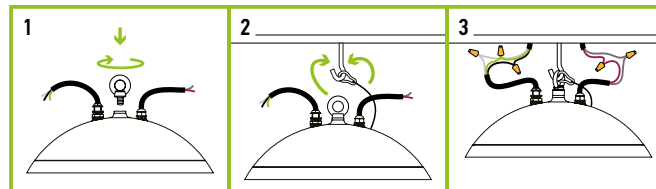

For most up-to-date spec sheets please refer to asd-lighting.com