



LED COMMERCIAL DOWNLIGHT

► **DESIGN** - LED COMMERCIAL DOWNLIGHT comes with a durable aluminum housing resistant to rust and impact, anti-glare PC lens, spring-loaded clips and 1.6 ft cord in metal hose. It is designed to operate on 120-277V circuits with a 0-10V dimmable driver.

► **BATTERY BACK-UP** - The built-in battery back-up provide 90 minutes of power in case of emergency.

► **COLOR AND POWER SELECTABLE** - You can choose either a 2,700K soft white, 3,000K warm white, 3,500K neutral white, 4,000K cool white, or 5,000K daylight color temperature, and change the power with a simple switch.

► **CRI90+** - Rating provides rich and natural colors and keeps your space looking and feeling vibrant. True bright colors also improve your mood and general health.

► **INSTALLATION** - This fixture is IC rated so there is no can or any other housing required. It is also Wet Locations rated, making it perfect for any spaces with humidity requirements. Perfect for retail, hospitality, or any other commercial space with a high ceiling.

► **ADVANTAGES** - With a lifespan of 50,000 hours, these fixtures are made to last decades under normal operation! ASD provides a 5-year limited warranty along with UL and Energy Star certifications to guarantee top quality products and safety!

Catalog number	
Notes	
Type	

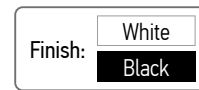

Model	Size	Watts	Voltage	Dimmable	Lumens	CCT	IC rated	Finish	Dimensions (DxH)	Cord	Option
CDL7 ROUND											
ASD-CDL7-4DA13AC	4 inch	7/10/13W	120-277 V	0-10 V	up to 1,050 lm	5CCT (2,700/3,000/3,500/4,000/5,000 K)	Yes	White	5-3/8" x 3-1/16"	1.6 ft	-
ASD-CDL7-6DA22AC	6 inch	10/15/22W	120-277 V	0-10 V	up to 1,850 lm	5CCT (2,700/3,000/3,500/4,000/5,000 K)	Yes	White	8-1/4" x 4"	1.6 ft	-
ASD-CDL7-6DA22AC-BK	6 inch	10/15/22W	120-277 V	0-10 V	up to 1,850 lm	5CCT (2,700/3,000/3,500/4,000/5,000 K)	Yes	Black	8-1/4" x 4"	1.6 ft	-
ASD-CDL7-6DA30AC	6 inch	20/25/30W	120-277 V	0-10 V	up to 2,487 lm	5CCT (2,700/3,000/3,500/4,000/5,000 K)	-	White	8-1/4" x 4"	1.6 ft	-
ASD-CDL7-8DA30AC	8 inch	12/20/30W	120-277 V	0-10 V	up to 2,400 lm	5CCT (2,700/3,000/3,500/4,000/5,000 K)	Yes	White	10-1/4" x 4-7/16"	1.6 ft	-
ASD-CDL7-8DA30AC-BK	8 inch	12/20/30W	120-277 V	0-10 V	up to 2,400 lm	5CCT (2,700/3,000/3,500/4,000/5,000 K)	Yes	Black	10-1/4" x 4-7/16"	1.6 ft	-
ASD-CDL7-8DA40AC	8 inch	30/35/40W	120-277 V	0-10 V	up to 3,250 lm	5CCT (2,700/3,000/3,500/4,000/5,000 K)	-	White	10-1/4" x 4-7/16"	1.6 ft	-
ASD-CDL7-10DA40AC	10 inch	20/30/40W	120-277 V	0-10 V	up to 3,000 lm	5CCT (2,700/3,000/3,500/4,000/5,000 K)	Yes	White	11-5/16" x 4-15/16"	1.6 ft	-
ASD-CDL7-10DA40AC-BK	10 inch	20/30/40W	120-277 V	0-10 V	up to 3,000 lm	5CCT (2,700/3,000/3,500/4,000/5,000 K)	Yes	Black	11-5/16" x 4-15/16"	1.6 ft	-
ASD-CDL7-10DA60AC	10 inch	40/50/60W	120-277 V	0-10 V	up to 4,903 lm	5CCT (2,700/3,000/3,500/4,000/5,000 K)	-	White	11-5/16" x 4-15/16"	1.6 ft	-
CDL7R ROUND 120lm/W											
ASD-CDL7R-6A30WH	6 inch	12/16/22/26/30W	120-277 V	0-10 V	up to 3,352 lm	5CCT (2,700/3,000/3,500/4,000/5,000 K)	Yes	White	8-3/8" x 4-13/16"	1.5 ft	-
ASD-CDL7R-8A35WH	8 inch	16/22/26/30/35W	120-277 V	0-10 V	up to 4,245 lm	5CCT (2,700/3,000/3,500/4,000/5,000 K)	Yes	White	10-5/16" x 5-5/16"	1.5 ft	-
ASD-CDL7R-10A40WH	10 inch	22/26/30/35/40W	120-277 V	0-10 V	up to 4,791 lm	5CCT (2,700/3,000/3,500/4,000/5,000 K)	Yes	White	11-9/16" x 5-15/16"	1.5 ft	-
CDL7S SQUARE											
ASD-CDL7S-6A30WH	6 inch	12/16/22/26/30W	120-277 V	0-10 V	up to 3,009 lm	5CCT (2,700/3,000/3,500/4,000/5,000 K)	Yes	White	8-11/16" x 8-11/16" x 4-5/16"	2.3 ft	-
ASD-CDL7S-8A35WH	8 inch	16/22/26/30/35W	120-277 V	0-10 V	up to 3,711 lm	5CCT (2,700/3,000/3,500/4,000/5,000 K)	Yes	White	10-1/4" x 10-1/4" x 4-1/4"	2.3 ft	-
CDL7R ROUND WITH BATTERY BACK-UP											
ASD-CDL7R-6A30WH-EM	6 inch	12/16/22/26/30W	120-277 V	0-10 V	up to 3,352 lm	5CCT (2,700/3,000/3,500/4,000/5,000 K)	Yes	White	8-11/16" x 4-5/16"	2.3 ft	15W Battery back-up
ASD-CDL7R-8A35WH-EM	8 inch	16/22/26/30/35W	120-277 V	0-10 V	up to 4,245 lm	5CCT (2,700/3,000/3,500/4,000/5,000 K)	Yes	White	10-1/4" x 4-5/16"	2.3 ft	15W Battery back-up

For detailed luminous flux information please refer to Annex 1, page 7.

For most up-to-date spec sheets please refer to asd-lighting.com

ASD LIGHTING CORP

E-mail: orders@asd-lighting.com | Web site: www.asd-lighting.com





LED COMMERCIAL DOWNLIGHT

PRODUCT SPECIFICATIONS:

Construction & Materials						
Housing	Aluminum					
Lens	PC					
Finish	White, Black					
Weight	ASD-CDL7-4DA13AC	0.7 lbs (0.3 kg)	ASD-CDL7-8DA40AC	1.8 lbs (0.8 kg)	ASD-CDL7R-10A40WH	1.8 lbs (0.8 kg)
	ASD-CDL7-6DA22AC	1.5 lbs (0.7 kg)	ASD-CDL7-10DA40AC	2.4 lbs (1.1 kg)	ASD-CDL7S-6A30WH	1.9 lbs (0.9 kg)
	ASD-CDL7-6DA22AC-BK		ASD-CDL7-10DA40AC-BK		ASD-CDL7S-8A35WH	2.6 lbs (1.2 kg)
	ASD-CDL7-6DA30AC	1.8 lbs (0.8 kg)	ASD-CDL7-10DA60AC	1.2 lbs (0.5 kg)	ASD-CDL7R-6A30WH-EM	3.4 lbs (1.6 kg)
	ASD-CDL7-8DA30AC		ASD-CDL7R-6A30WH		ASD-CDL7R-8A35WH-EM	3.8 lbs (1.7 kg)
ASD-CDL7-8DA30AC-BK	ASD-CDL7R-8A35WH		1.5 lbs (0.7 kg)			
Environmental system						
Work environment	Suitable for Wet Locations					
Operating temperature	-4°F to 104°F (-20°C to 40°C)			for CDL7 models: -13°F to 113°F (-25°C to 45°C)		
L-70 Life	> 50,000 hrs					
Optical system						
Color temperature	5CCT switch (2,700/3,000/3,500/4,000/5,000 K), 5,000 K by default					
CRI	> 90					
Electrical system						
Input voltage	120-277 V					
Max input current	ASD-CDL7-4DA13AC	0.15 A	ASD-CDL7-8DA40AC	0.43 A	ASD-CDL7R-10A40WH	0.33 A
	ASD-CDL7-6DA22AC	0.23 A	ASD-CDL7-10DA40AC	0.5 A	ASD-CDL7S-6A30WH	0.25 A
	ASD-CDL7-6DA22AC-BK		ASD-CDL7-10DA40AC-BK		ASD-CDL7S-8A35WH	0.29 A
	ASD-CDL7-6DA30AC	0.29 A	ASD-CDL7-10DA60AC	0.64 A	ASD-CDL7R-6A30WH-EM	0.25 A
	ASD-CDL7-8DA30AC	0.3 A	ASD-CDL7R-6A30WH	0.25 A	ASD-CDL7R-8A35WH-EM	0.29 A
ASD-CDL7-8DA30AC-BK	ASD-CDL7R-8A35WH		0.29 A			
Inrush current (Action time)	ASD-CDL7-4DA13AC	30 A (0.3 S)	ASD-CDL7-8DA40AC	44 A (0.3 S)	ASD-CDL7R-10A40WH	50 A (16 S)
	ASD-CDL7-6DA22AC	43 A (0.3 S)	ASD-CDL7-10DA40AC	50 A (0.3 S)	ASD-CDL7S-6A30WH	
	ASD-CDL7-6DA22AC-BK		ASD-CDL7-10DA40AC-BK		ASD-CDL7S-8A35WH	
	ASD-CDL7-6DA30AC	38 A (0.3 S)	ASD-CDL7-10DA60AC	50 A (16 S)	ASD-CDL7R-6A30WH-EM	
	ASD-CDL7-8DA30AC	37 A (0.3 S)	ASD-CDL7R-6A30WH		ASD-CDL7R-8A35WH-EM	
ASD-CDL7-8DA30AC-BK	ASD-CDL7R-8A35WH					
Off state power	0W					
Power consumption	ASD-CDL7-4DA13AC	7/10/13W	ASD-CDL7-8DA40AC	30/35/40W	ASD-CDL7R-10A40WH	22/26/30/35/40W
	ASD-CDL7-6DA22AC	10/15/22W	ASD-CDL7-10DA40AC	20/30/40W	ASD-CDL7S-6A30WH	12/16/22/26/30W
	ASD-CDL7-6DA22AC-BK		ASD-CDL7-10DA40AC-BK		ASD-CDL7S-8A35WH	16/22/26/30/35W
	ASD-CDL7-6DA30AC	20/25/30W	ASD-CDL7-10DA60AC	40/50/60W	ASD-CDL7R-6A30WH-EM	12/16/22/26/30W
	ASD-CDL7-8DA30AC	12/20/30W	ASD-CDL7R-6A30WH	12/16/22/26/30W	ASD-CDL7R-8A35WH-EM	16/22/26/30/35W
ASD-CDL7-8DA30AC-BK	ASD-CDL7R-8A35WH		16/22/26/30/35W			
Power factor	> 0.9					
Output voltage	ASD-CDL7-4DA13AC	36 V	ASD-CDL7-8DA40AC	30-42 V	ASD-CDL7R-10A40WH	75 A
	ASD-CDL7-6DA22AC	30-42 V	ASD-CDL7-10DA40AC	36 V	ASD-CDL7S-6A30WH	
	ASD-CDL7-6DA22AC-BK		ASD-CDL7-10DA40AC-BK		ASD-CDL7S-8A35WH	
	ASD-CDL7-6DA30AC	30-42 V	ASD-CDL7-10DA60AC	30-42 V	ASD-CDL7R-6A30WH-EM	
	ASD-CDL7-8DA30AC		ASD-CDL7R-6A30WH	75 A	ASD-CDL7R-8A35WH-EM	
ASD-CDL7-8DA30AC-BK	ASD-CDL7R-8A35WH					
Max output current	ASD-CDL7-4DA13AC	0.33 A	ASD-CDL7-8DA40AC	1 A	ASD-CDL7R-10A40WH	0.52 A
	ASD-CDL7-6DA22AC	0.55 A	ASD-CDL7-10DA40AC		ASD-CDL7S-6A30WH	0.37 A
	ASD-CDL7-6DA22AC-BK		ASD-CDL7-10DA40AC-BK	ASD-CDL7S-8A35WH	0.45 A	
	ASD-CDL7-6DA30AC	0.75 A	ASD-CDL7-10DA60AC	1.6 A	ASD-CDL7R-6A30WH-EM	0.37 A
	ASD-CDL7-8DA30AC	0.75 A	ASD-CDL7R-6A30WH	0.37 A	ASD-CDL7R-8A35WH-EM	0.45 A
ASD-CDL7-8DA30AC-BK	ASD-CDL7R-8A35WH		0.45 A			
Surge protection DM/CM	2 kV / 2.5 kV		for CDL7 models: 2.5 kV / 2.5 kV			
Dimming compatible controls				Regular and voluntary certifications		
Brand	Lutron		Leviton	5-year limited warranty		
Models	DVSTV-WH	DVSTV-LA	DVTV-WH	DS 710-10Z	UL certified E473854 (for CDL7 models)	
	DVSTV-BR	DVSTV-BL	DVSTV-IV	AWSMT-7DW	cETLus certified 5005153 (except CDL7 models)	
	DVSTV-GR	DVSTV-AL			Energy Star listed (for CDL7 models)	
Dimming compatible controls						
Brand	Lutron		Leviton			
Models	MS-Z101		IP710-LFZ			

For most up-to-date spec sheets please refer to asd-lighting.com



LED COMMERCIAL DOWNLIGHT

PACKAGE CONTENTS:

Description	Q-ty
LED Commercial Downlight Fixture	1
Wire nut (A)	3
Template for 4, 6, 8 or 10 inch (B)	1
Box	1

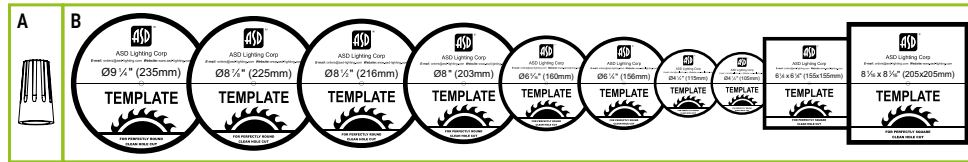

ACCESSORIES (sold separately):

Battery back-up kit

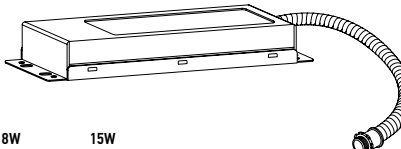

8W BLD-HM08D
15W BLD-HM15D

New construction flat mounting plate with asymmetric round holes 8-10-12"
ASD-MPLR-81012-FA-6PACK

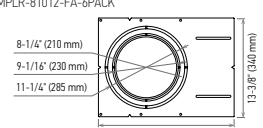

8-1/4" (210 mm)
9-1/16" (230 mm)
11-1/4" (285 mm)
13-3/8" (340 mm)
18-1/2" (470 mm)

New construction flat mounting plate with symmetric square holes 3-4-6"
ASD-MPLS-346-FA-6PACK

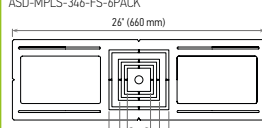

26" (660 mm)
2-15/16" (75 mm)
4-5/16" (110 mm)
6-1/8" (154 mm)
8-1/4" (210 mm)

New construction mounting plate with round holes and sliding clips 3-4-6"
ASD-MPLS-346-SC-6PACK

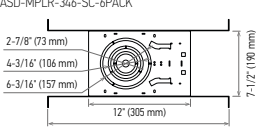

2-7/8" (73 mm)
4-3/16" (106 mm)
6-3/16" (157 mm)
12" (305 mm)
13-3/4" (350 mm) - 25-3/16" (640 mm)
7-1/2" (190 mm)

New construction flat mounting plate with asymmetric round holes 3-4-6"
ASD-MPLR-346-FA-6PACK

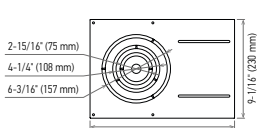

2-15/16" (75 mm)
4-1/4" (108 mm)
6-3/16" (157 mm)
13-1/4" (337 mm)
9-1/16" (230 mm)

New construction flat mounting plate with asymmetric square holes 3-4-6"
ASD-MPLS-346-FA-6PACK

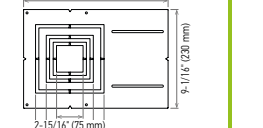

13-1/4" (337 mm)
2-15/16" (75 mm)
4-5/16" (110 mm)
6-1/8" (156 mm)
9-1/16" (230 mm)

New construction flat mounting plate with asymmetric square holes 8-10-12"
ASD-MPLS-81012-FA-6PACK

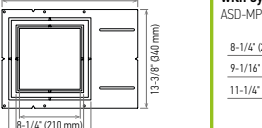

18-1/2" (470 mm)
9-1/4" (210 mm)
9-1/16" (230 mm)
11-1/4" (285 mm)
13-3/8" (340 mm)

New construction mounting plate with square holes and sliding clips 3-4-6"
ASD-MPLS-346-SC-6PACK

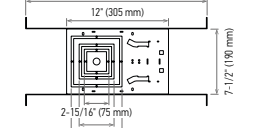

13-3/4" (350 mm) - 25-3/16" (640 mm)
12" (305 mm)
2-15/16" (75 mm)
4-5/16" (110 mm)
6-1/8" (156 mm)
7-1/2" (190 mm)

New construction flat mounting plate 18" with asymmetric round holes 3-4-6"
ASD-MPLR18-346-FA-6PACK

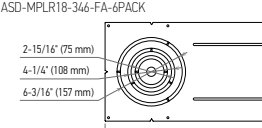

2-15/16" (75 mm)
4-1/4" (108 mm)
6-3/16" (157 mm)
18" (457 mm)
9-1/16" (230 mm)

New construction flat mounting plate with symmetric round holes 3-4-6"
ASD-MPLR-346-FS-6PACK

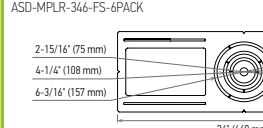

2-15/16" (75 mm)
4-1/4" (108 mm)
6-3/16" (157 mm)
26" (660 mm)
8-1/4" (210 mm)

New construction flat mounting plate with symmetric square holes 8-10-12"
ASD-MPLS-81012-FS-6PACK

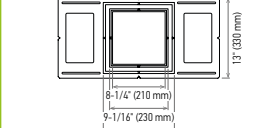

26" (660 mm)
13" (330 mm)
8-1/4" (210 mm)
9-1/16" (230 mm)
11-1/4" (285 mm)

New construction mounting plate with square holes and sliding clips 8-10-12"
ASD-MPLS-81012-SC-6PACK

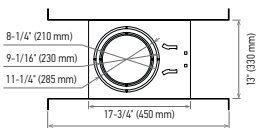

26" (660 mm)
13" (330 mm)
8-1/4" (210 mm)
9-1/16" (230 mm)
11-1/4" (285 mm)
17-3/4" (450 mm) - 25-3/16" (640 mm)
17-3/4" (450 mm)

ACCESSORY COMPATIBILITY LIST:

Models	Accessories	Compatibility												
		Battery back-up kit 8W BLD-HM08D	Battery back-up kit 15W BLD-HM15D	New construction flat mounting plate with asymmetric round holes 3-4-6" ASD-MPLR-346-FA-6PACK	New construction flat mounting plate 18" with asymmetric round holes 3-4-6" ASD-MPLR18-346-FA-6PACK	New construction flat mounting plate with asymmetric square holes 3-4-6" ASD-MPLS-346-FA-6PACK	New construction flat mounting plate with asymmetric round holes 8-10-12" ASD-MPLR-81012-FA-6PACK	New construction flat mounting plate with asymmetric square holes 8-10-12" ASD-MPLS-81012-FA-6PACK	New construction flat mounting plate with symmetric round holes 3-4-6" ASD-MPLR-346-FS-6PACK	New construction flat mounting plate with symmetric square holes 3-4-6" ASD-MPLS-346-FS-6PACK	New construction flat mounting plate with symmetric round holes 8-10-12" ASD-MPLR-81012-FS-6PACK	New construction flat mounting plate with symmetric square holes 8-10-12" ASD-MPLS-81012-FS-6PACK	New construction mounting plate with round holes and sliding clips 3-4-6" ASD-MPLR-346-SC-6PACK	New construction mounting plate with square holes and sliding clips 3-4-6" ASD-MPLS-346-SC-6PACK
ASD-CDL7/ ASD-CDL7R	4"	•	•	•	•	•	•	•	•	•	•	•	•	•
	6"	•	•	•	•	•	•	•	•	•	•	•	•	•
	8"	•	•	•	•	•	•	•	•	•	•	•	•	•
	10"	•	•	•	•	•	•	•	•	•	•	•	•	•
ASD-CDL7S	6"	•	•	•	•	•	•	•	•	•	•	•	•	•
	8"	•	•	•	•	•	•	•	•	•	•	•	•	•
ASD-CDL7R-EM	6"	•	•	•	•	•	•	•	•	•	•	•	•	•
	8"	•	•	•	•	•	•	•	•	•	•	•	•	•

For most up-to-date spec sheets please refer to asd-lighting.com





LED COMMERCIAL DOWNLIGHT

BUILT-IN BACK-UP BATTERY INFORMATION

Model	Battery watts	Lumens in emergency mode	Battery capacity	Emergency mode	Charging time
ASD-CDL7R-6A30WH-EM	15W	1,719 lm	2600 mAh * 4	> 90 min	≥ 24 hours
ASD-CDL7R-8A35WH-EM	15W	1,756 lm	2600 mAh * 4	> 90 min	≥ 24 hours

- ▶ Has a self-checking function.
- ▶ AC operation, indicator light will stay on.
- ▶ Emergency operation, indicator light will flash slowly (light on for 2 seconds, lightoff for 2 seconds).
- ▶ In a failure, indicator light will flash quickly (light on for 0.2 seconds, light off for 0.2 seconds).
- ▶ In order to test the Battery back-up, press test switch one time to switch to emergency mode. Press one more time to get back to AC mode.

STANDARD OPERATION DISPLAY STATUS:

Operating condition	 ON
Charging	 ON
Emergency mode	Flash slowly
Test failure	Flash quickly

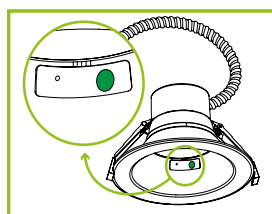

BATTERY BACK-UP KIT INFORMATION

BLD-HM08D **BLD-HM15D** sold separately:

Specifications	model: BLD-HM08D	model: BLD-HM15D
Input voltage	120-347 Vac, 50/60 Hz	
Input current	≤ 100 mA	
Output voltage	≤ 170 Vdc	≤ 175 Vdc
Output power	8W	15W
Lumen	800 lm	1,000 lm
Application	< 60W (0-10 V dimmable fixture)	< 100W (0/1-10 V dimmable fixture)
Ambient temperature	32°F to 122°F (0°C to 50°C)	

INSTALLATION GUIDE

IMPORTANT SAFETY INFORMATION:

Please read all the instructions below before installation.

- ▶ Make sure that the supply voltage corresponds to the rated product voltage.
- ▶ The product must be installed by a qualified electrician in accordance with the National Electrical Code and corresponding local codes.
- ▶ If the product is damaged, do not use it.

⚠ WARNING

RISK OF PERSONAL INJURY – READ and follow all WARNINGS and installation instructions. Keep or give to the owner for future reference.

Risk of cuts: Wear gloves to prevent cuts or abrasions when removing from carton, handling, installing, and maintaining this product.

Risk of electric shock: This product must be installed in accordance with the applicable installation code by a person familiar with the construction and operation of the product and the hazards involved.

Risk of Fire: Minimum 194°F supply conductors. Consult a qualified electrician to ensure correct branch circuit conductor.

ASD® assumes no responsibility for claims arising out of improper or careless Installation or handling of this product.

ELECTRICAL SCHEMATIC DIAGRAM:

CDL7

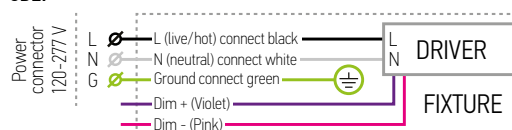

CDL7R-EM with battery back-up

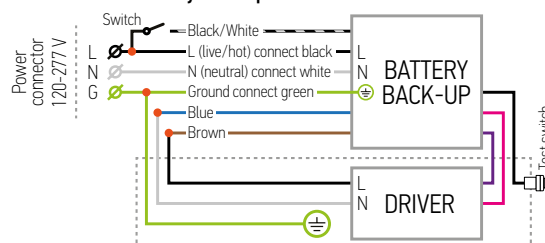

CDL7 with battery back-up kit

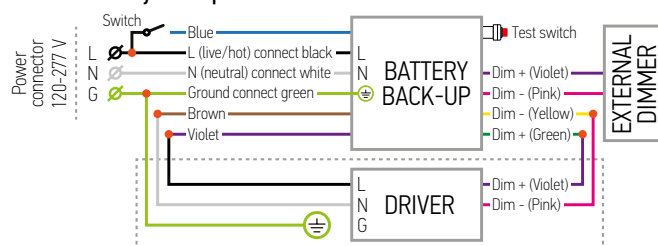

For most up-to-date spec sheets please refer to asd-lighting.com



LED COMMERCIAL DOWNLIGHT

INSTALLATION STEPS:

1. Use template to cut an appropriate sized hole. Before inserting the fixture into the mounting surface opening, choose power and color temperature with a simple switch.
2. Connect the wires using wire nuts: Black to Black, White to White, Green to Green.
3. Fold up the two spring mounting tabs and release as the fixture is placed into the mounting surface. Ensure that the spring mounting tabs have securely mounted the fixture so that the front trim is flush against the mounting surface.

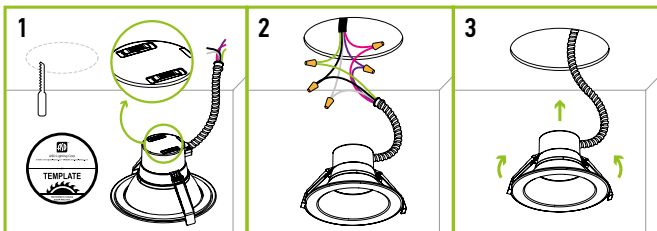

BATTERY BACK-UP KIT INSTALLATION

BLD-HM08D **BLD-HM15D** sold separately:

1. Secure the battery back-up to the ceiling.
2. Connect wires as shown on electrical diagram.
3. Connect test switch and affix it in the hole on surface.

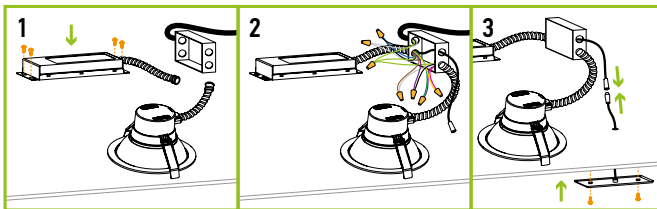

MOUNTING PLATE INSTALLATION

ASD-MPLR-346-FA	ASD-MPLR-346-SC	ASD-MPLS-81012-FA
ASD-MPLS-346-FA	ASD-MPLS-346-SC	ASD-MPLR-81012-FS
ASD-MPLR-346-FS	ASD-MPLR18-346-FA	ASD-MPLS-81012-FS
ASD-MPLS-346-FS	ASD-MPLR-81012-FA	ASD-MPLR-81012-SC

sold separately:

1. Remove the metal ring from the mounting plate according to the size of fixture.
2. Place the mounting plate and secure its position with screws on the beams.

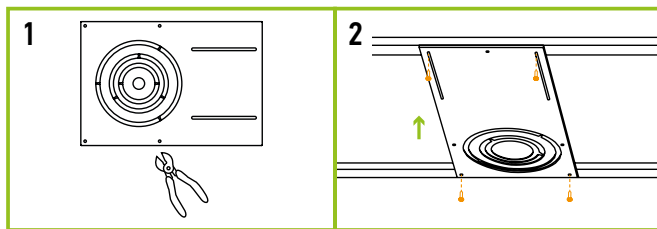

For most up-to-date spec sheets please refer to asd-lighting.com

ASD LIGHTING CORP

E-mail: orders@asd-lighting.com | Web site: www.asd-lighting.com





LED COMMERCIAL DOWNLIGHT

ORDERING INFORMATION

Model	UPC	Pcs. per carton	Carton size	Carton weight	GTIN 14
CDL7 ROUND					
ASD-CDL7-4DA13AC	810050736121	8	16.1" x 14.4" x 7.1"	9.3 lbs	30810050736122
ASD-CDL7-6DA22AC	810050736022	8	19.1" x 18.1" x 10"	15.7 lbs	30810050736023
ASD-CDL7-6DA22AC-BK	810050739443	8	19.1" x 18.1" x 10"	15.7 lbs	10810050739440
ASD-CDL7-6DA30AC	810050739825	8	19.1" x 18.1" x 10"	15.7 lbs	10810050739822
ASD-CDL7-8DA30AC	810050736039	4	18.9" x 11.4" x 11.6"	9.1 lbs	10810050736036
ASD-CDL7-8DA30AC-BK	810050739450	4	18.9" x 11.4" x 11.6"	9.1 lbs	10810050739457
ASD-CDL7-8DA40AC	819201025459	4	18.9" x 11.4" x 11.6"	9.1 lbs	10819201025456
ASD-CDL7-10DA40AC	810050736046	4	23.6" x 12.6" x 13"	12.1 lbs	10810050736043
ASD-CDL7-10DA40AC-BK	810050739832	4	23.6" x 12.6" x 13"	12.1 lbs	10810050739839
ASD-CDL7-10DA60AC	819201023721	4	23.6" x 12.6" x 13"	12.1 lbs	10819201023728
CDL7R ROUND 120lm/W					
ASD-CDL7R-6A30WH	810128113359	8	18.9" x 18.5" x 12.2"	14.4 lbs	10810128113356
ASD-CDL7R-8A35WH	810128113366	4	22.8" x 11.8" x 13"	9.9 lbs	10810128113363
ASD-CDL7R-10A40WH	810128113373	4	25.6" x 13.2" x 14.2"	12.3 lbs	10810128113370
CDL7S SQUARE					
ASD-CDL7S-6A30WH	810128114981	8	22.1" x 22.1" x 12.8"	23.6 lbs	10810128114988
ASD-CDL7S-8A35WH	810128114998	4	25.2" x 25.2" x 6.7"	16.4 lbs	10810128114995
CDL7R ROUND WITH BATTERY BACK-UP					
ASD-CDL7R-6A30WH-EM	810128114394	8	23.2" x 16.3" x 26"	36.5 lbs	10810128114391
ASD-CDL7R-8A35WH-EM	810128114400	4	25.2" x 16.3" x 13.9"	22.4 lbs	10810128114407

ACCESSORIES:

Model	Description	UPC	Pcs. per carton	Carton size	Carton weight	GTIN 14 in carton
BLD-HM08D	Battery back-up kit 8W	810128111508	10	17.1" x 14.6" x 11"	19.6 lbs	10810128111505
BLD-HM15D	Battery back-up kit 15W	810050734882	10	17.8" x 13.5" x 9.5"	25.1 lbs	10810050734889
ASD-MPLR-346-FA-6PACK	New construction flat mounting plate with asymmetric round holes 3-4-6"	810050739344	4	14.4" x 9.8" x 3.2"	18.1 lbs	10810050739341
ASD-MPLR18-346-FA-6PACK	New construction flat mounting plate 18" with asymmetric round holes 3-4-6"	810128112826	4	18.9" x 9.8" x 3.2"	32.9 lbs	10810128112823
ASD-MPLR-81012-FA-6PACK	New construction flat mounting plate with asymmetric round holes 8-10-12"	810128111553	4	19.5" x 14.2" x 3.2"	37.2 lbs	10810128111550
ASD-MPLS-346-FA-6PACK	New construction flat mounting plate with asymmetric square holes 3-4-6"	810128110303	4	14.4" x 9.8" x 3.2"	17.7 lbs	10810128110300
ASD-MPLS-81012-FA-6PACK	New construction flat mounting plate with asymmetric square holes 8-10-12"	810128112833	4	19.5" x 14.2" x 3.2"	36.3 lbs	10810128112830
ASD-MPLR-346-FS-6PACK	New construction flat mounting plate with symmetric round holes 3-4-6"	810050739351	4	27" x 9.1" x 3.2"	21 lbs	10810050739358
ASD-MPLR-81012-FS-6PACK	New construction flat mounting plate with symmetric round holes 8-10-12"	810128111577	4	27" x 13.8" x 3.2"	42.3 lbs	10810128111574
ASD-MPLS-346-FS-6PACK	New construction flat mounting plate with symmetric square holes 3-4-6"	810128110310	4	27" x 9.1" x 3.2"	20.7 lbs	10810128110317
ASD-MPLS-81012-FS-6PACK	New construction flat mounting plate with symmetric square holes 8-10-12"	810128112840	4	27" x 13.8" x 3.2"	40.7 lbs	10810128112847
ASD-MPLR-346-SC-6PACK	New construction mounting plate with round holes and sliding clips 3-4-6"	810050739337	2	17.3" x 11.9" x 13.4"	17 lbs	10810050739334
ASD-MPLR-81012-SC-6PACK	New construction mounting plate with round holes and sliding clips 8-10-12"	810128111607	2	21.3" x 17.5" x 15.6"	24 lbs	10810128111604
ASD-MPLS-346-SC-6PACK	New construction mounting plate with square holes and sliding clips 3-4-6"	810128110327	2	17.3" x 11.9" x 13.4"	16.5 lbs	10810128110324

For most up-to-date spec sheets please refer to asd-lighting.com

ASD LIGHTING CORP

E-mail: orders@asd-lighting.com | Web site: www.asd-lighting.com





LED COMMERCIAL DOWNLIGHT

ANNEX 1

Model	Watts	2,700 K	3,000 K	3,500 K	4,000 K	5,000 K
ASD-CDL7-4DA13AC	7W	591 lm	621 lm	640 lm	645 lm	655 lm
	10W	847 lm	882 lm	910 lm	923 lm	917 lm
	13W	1,063 lm	1,118 lm	1,161 lm	1,170 lm	1,050 lm
ASD-CDL7-6DA22AC ASD-CDL7-6DA22AC-BK	10W	822 lm	830 lm	842 lm	833 lm	924 lm
	15W	1,219 lm	1,227 lm	1,242 lm	1,243 lm	1,384 lm
	22W	1,769 lm	1,811 lm	1,853 lm	1,812 lm	1,850 lm
ASD-CDL7-6DA30AC	20W	1,784 lm	1,805 lm	1,883 lm	1,846 lm	1,830 lm
	25W	2,117 lm	2,139 lm	2,253 lm	2,206 lm	2,161 lm
	30W	2,437 lm	2,552 lm	2,624 lm	2,577 lm	2,487 lm
ASD-CDL7-8DA30AC ASD-CDL7-8DA30AC-BK	12W	1,084 lm	1,119 lm	1,160 lm	1,177 lm	1,189 lm
	20W	1,707 lm	1,765 lm	1,836 lm	1,851 lm	1,818 lm
	30W	2,440 lm	2,514 lm	2,630 lm	2,640 lm	2,400 lm
ASD-CDL7-8DA40AC	30W	2,589 lm	2,615 lm	2,714 lm	2,614 lm	2,603 lm
	35W	2,949 lm	3,012 lm	3,152 lm	3,128 lm	2,981 lm
	40W	3,224 lm	3,292 lm	3,439 lm	3,312 lm	3,250 lm
ASD-CDL7-10DA40AC ASD-CDL7-10DA40AC-BK	20W	1,743 lm	1,771 lm	1,832 lm	1,851 lm	1,837 lm
	30W	2,315 lm	2,371 lm	2,469 lm	2,483 lm	2,427 lm
	40W	3,068 lm	3,157 lm	3,146 lm	3,143 lm	3,000 lm
ASD-CDL7-10DA60AC	40W	3,328 lm	3,403 lm	3,552 lm	3,514 lm	3,477 lm
	50W	4,106 lm	4,191 lm	4,362 lm	4,277 lm	4,148 lm
	60W	4,835 lm	4,876 lm	5,154 lm	4,972 lm	4,903 lm
ASD-CDL7R-6A30WH	12W	1,332 lm	1,351 lm	1,393 lm	1,423 lm	1,450 lm
	16W	1,737 lm	1,771 lm	1,832 lm	1,873 lm	1,915 lm
	22W	2,320 lm	2,377 lm	2,459 lm	2,502 lm	2,527 lm
	26W	2,641 lm	2,715 lm	2,813 lm	2,861 lm	2,881 lm
ASD-CDL7R-8A35WH	30W	3,018 lm	3,119 lm	3,242 lm	3,304 lm	3,352 lm
	16W	1,928 lm	1,953 lm	2,015 lm	2,095 lm	2,613 lm
	22W	2,569 lm	2,613 lm	2,702 lm	2,757 lm	2,796 lm
	26W	2,702 lm	2,796 lm	3,048 lm	3,205 lm	3,241 lm
ASD-CDL7R-10A40WH	30W	3,377 lm	3,452 lm	3,578 lm	3,645 lm	3,681 lm
	35W	3,838 lm	3,935 lm	4,093 lm	4,178 lm	4,246 lm
	22W	2,644 lm	2,691 lm	2,842 lm	2,999 lm	3,162 lm
	26W	2,999 lm	3,058 lm	3,162 lm	3,219 lm	3,260 lm
ASD-CDL7R-6A30WH	30W	3,260 lm	3,459 lm	3,640 lm	3,679 lm	3,863 lm
	35W	3,960 lm	4,103 lm	4,167 lm	4,200 lm	4,363 lm
	40W	4,363 lm	4,487 lm	4,659 lm	4,736 lm	4,791 lm
	12W	1,190 lm	1,202 lm	1,234 lm	1,255 lm	1,274 lm
ASD-CDL7S-6A30WH	16W	1,639 lm	1,669 lm	1,720 lm	1,750 lm	1,780 lm
	22W	2,270 lm	2,330 lm	2,407 lm	2,438 lm	2,442 lm
	26W	2,639 lm	2,721 lm	2,818 lm	2,851 lm	2,839 lm
	30W	2,992 lm	3,101 lm	3,218 lm	3,257 lm	3,273 lm
ASD-CDL7S-8A35WH	16W	1,715 lm	1,731 lm	1,781 lm	1,815 lm	1,846 lm
	22W	2,399 lm	2,458 lm	2,495 lm	2,534 lm	2,557 lm
	26W	2,798 lm	2,854 lm	2,948 lm	2,991 lm	3,007 lm
	30W	3,209 lm	3,283 lm	3,399 lm	3,445 lm	3,450 lm
ASD-CDL7R-6A30WH-EM	35W	3,711 lm	3,816 lm	3,969 lm	4,094 lm	4,046 lm
	12W	1,332 lm	1,351 lm	1,393 lm	1,423 lm	1,450 lm
	16W	1,737 lm	1,771 lm	1,832 lm	1,873 lm	1,915 lm
	22W	2,320 lm	2,377 lm	2,459 lm	2,502 lm	2,527 lm
ASD-CDL7R-8A35WH-EM	26W	2,641 lm	2,715 lm	2,813 lm	2,861 lm	2,881 lm
	30W	3,018 lm	3,119 lm	3,242 lm	3,304 lm	3,352 lm
	16W	1,928 lm	1,953 lm	2,015 lm	2,095 lm	2,613 lm
	22W	2,569 lm	2,613 lm	2,702 lm	2,757 lm	2,796 lm
ASD-CDL7R-8A35WH-EM	26W	2,702 lm	2,796 lm	3,048 lm	3,205 lm	3,241 lm
	30W	3,377 lm	3,452 lm	3,578 lm	3,645 lm	3,681 lm
	35W	3,838 lm	3,935 lm	4,093 lm	4,178 lm	4,246 lm

For most up-to-date spec sheets please refer to asd-lighting.com

ASD LIGHTING CORP

E-mail: orders@asd-lighting.com | Web site: www.asd-lighting.com

