



# LED ADJUSTABLE CUTOFF WALLPACK

► **DESIGN & OPTIONS** - LED ADJUSTABLE CUTOFF WALLPACK is a contemporary commercial-grade area luminaire. It has a 0-90° adjustable head and cut-off design for controllable illumination. The housing is made of die-cast aluminum, which provides excellent heat dissipation. The impact-resistant polycarbonate lens protects the LEDs and prevents glare. It is CCT selectable, letting you set it to 3,000K, 4,000K or 5,000K with a simple switch. It comes with a 120-277V dimmable driver and a BLACK finish.

 **The PC** automatically turns on/off depending on the time of day.

► **INSTALLATION** - This durable fixture works great as a downlight or up-light. The housing features a removable hinge door and multiple points of entry, making installation quick and easy. The fixture can be mounted to a junction box or directly to a wall. Refer to installation instructions for detailed steps.

► **APPLICATION** - These wallpacks are ideal for multi-family and commercial applications such as outdoor building facades, patios, porches, driveways, walkways, decks, parking garages and many other outdoor spaces. They are IP65 rated and will stand up to many years of harsh environmental conditions. These fixtures can also operate in temperatures between -40° to 122°F (-40° to 50°C), allowing them to be utilized in a wide variety of applications and climates.

► **ENERGY SAVING & EFFICIENCY** - With a calculated lifespan up to 143,000 hours, these fixtures are made to last decades under normal operation! This fixture can cut your electric bill by up to 80% instantly and will save you a significant amount of money in its lifetime.

► **CERTIFICATION & WARRANTY** - Buy with confidence: ASD provides a 5-year limited warranty along with UL certification to guarantee top quality products and safety!

DLC Premium classification allow participation in rebates; please check the rebate programs available in your state.

<i>Catalog number</i>	
<i>Notes</i>	
<i>Type</i>	



Model	Watts	Voltage	Dimmable	Lumens	CCT	Finish	Dimensions (LxWxH)
ASD-WLP02A-12DAC-BK	12W	120-277 V	0-10 V	1,500/1,686/1,574 lm	3CCT (3,000/4,000/5,000 K)	Black	6" x 5-1/16" x 3-9/16"
ASD-WLP02A-30DAC-BK	30W	120-277 V	0-10 V	3,750/4,058/3,772 lm	3CCT (3,000/4,000/5,000 K)	Black	9-1/8" x 7-5/8" x 4-5/8"
ASD-WLP02A-50DAC-BK	50W	120-277 V	0-10 V	6,250/7,047/6,644 lm	3CCT (3,000/4,000/5,000 K)	Black	9-1/8" x 7-5/8" x 4-5/8"

## ORDERING INFORMATION

Model	UPC	Pcs. per carton	Carton size	Carton weight	GTIN 14
ASD-WLP02A-12DAC-BK	810050737104	12	15.4" x 13.2" x 15"	25.7 lb	10810050737101
ASD-WLP02A-30DAC-BK	810050737111	6	18.4" x 17.9" x 10.9"	28.3 lb	10810050737118
ASD-WLP02A-50DAC-BK	810050737128	6	18.4" x 17.9" x 10.9"	30.6 lb	10810050737125

### ACCESSORIES:

Model	Name	UPC	Pcs. per carton	Carton size	Carton weight	GTIN 14
ASD-PC-WLP	Photocell	810050735773	100	5.1" x 4.1" x 10.2"	1.1 lb	30810050735774

For most up-to-date spec sheets please refer to [asd-lighting.com](http://asd-lighting.com)



# LED ADJUSTABLE CUTOFF WALLPACK

## PRODUCT SPECIFICATIONS:

Construction & Materials			
Housing	Aluminum		
Lens	PC		
Finish	Black		
Weight	ASD-WLP02A-12DAC-BK	1.9 lb (0.9 kg)	
	ASD-WLP02A-30DAC-BK	4.3 lb (2 kg)	
	ASD-WLP02A-50DAC-BK	4.7 lb (2.1 kg)	
Environmental system			
Work environment	Suitable for Wet Locations, IP65		
Operating temperature	-40°F to 122°F (-40°C to 50°C)		
L-70 Life	R > 44,000 hrs; C > 143,000 hrs		
Optical system			
Luminous flux	ASD-WLP02A-12DAC-BK	1,500/1,686/1,574 lm	
	ASD-WLP02A-30DAC-BK	3,750/4,058/3,772 lm	
	ASD-WLP02A-50DAC-BK	6,250/7,047/6,644 lm	
Color temperature	3CCT (3,000/4,000/5,000 K)		
CRI	> 70		
Electrical system			
Input voltage	120-277 V		
Max input current	ASD-WLP02A-12DAC-BK	0.2 A	
	ASD-WLP02A-30DAC-BK	0.4 A	
	ASD-WLP02A-50DAC-BK	0.6 A	
Inrush current (Action time)	ASD-WLP02A-12DAC-BK	0.4 A (0.75 S)	
	ASD-WLP02A-30DAC-BK	0.8 A (0.75 S)	
	ASD-WLP02A-50DAC-BK	1.2 A (0.75 S)	
Off state power	0W		
Power consumption	ASD-WLP02A-12DAC-BK	12W	
	ASD-WLP02A-30DAC-BK	30W	
	ASD-WLP02A-50DAC-BK	50W	
Power factor	> 0.9		
Output voltage	30-50 V		
Max output current	ASD-WLP02A-12DAC-BK	0.28 A	
	ASD-WLP02A-30DAC-BK	0.7 A	
	ASD-WLP02A-50DAC-BK	1.15 A	
Surge protection DM/CM	4 kV / 6 kV		
Dimming compatible controls			
Brand	Leviton	Lutron	
Models	IP710-LFZ	NTSTV	DVSTV
Regular and voluntary certifications			
5-year limited warranty			
DesignLights Consortium (DLC) listed (Classification: Premium)			
UL certified			

## PACKAGE CONTENTS:

Description	Q-ty
LED Adjustable Cutoff Wallpack	1
Box	1

## ACCESSORIES (SOLD SEPARATELY):



## ACCESSORY COMPATIBILITY LIST:

Models	Accessories	Photocell ASD-PC-WLP
ASD-WLP02A-12DAC-BK		•
ASD-WLP02A-30DAC-BK		•
ASD-WLP02A-50DAC-BK		•

## PHOTOCELL INFORMATION



The dusk-to-dawn photocell automatically turns the fixture off during daylight hours.

- The light is always ON when luminance is < 30 Lx (2.8 Fc) (night time)
- The light is always OFF when luminance is > 60 Lx (5.6 Fc) (day time)

## INSTALLATION GUIDE

### IMPORTANT SAFETY INFORMATION:

Please read all the instructions below before installation.

- ▶ Make sure that the supply voltage corresponds to the rated product voltage.
- ▶ The product must be installed by a qualified electrician in accordance with the National Electrical Code and corresponding local codes.
- ▶ If the product is damaged, do not use it.

### ⚠ WARNING

**RISK OF PERSONAL INJURY – READ and follow all WARNINGS and installation instructions.** Keep or give to the owner for future reference.

**Risk of cuts:** Wear gloves to prevent cuts or abrasions when removing from carton, handling, installing, and maintaining this product.

**Risk of electric shock:** This product must be installed in accordance with the applicable installation code by a person familiar with the construction and operation of the product and the hazards involved.

**Risk of Fire:** Minimum 194°F supply conductors. Consult a qualified electrician to ensure correct branch circuit conductor.

ASD® assumes no responsibility for claims arising out of improper or careless Installation or handling of this product.

## ELECTRICAL SCHEMATIC DIAGRAM:

### WLP02A

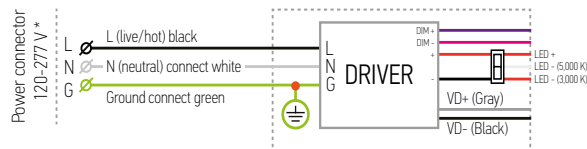

### WLP02A with photocell

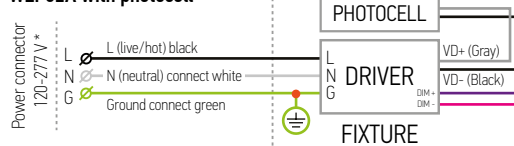

\* The regular voltage 120-277V fixtures can be alternatively powered without neutral by two-phase circuit with phase-to-phase voltage of 208V (L1-120V & L2-120V).

**WARNING:** Phase-to-phase voltage should be less than 277V (160V per each phase) and more than 120V (70V per each phase)! Do not confuse Regular Voltage fixtures of 120-277V with High Voltage ones of 277-480V!

For most up-to-date spec sheets please refer to [asd-lighting.com](http://asd-lighting.com)



# LED ADJUSTABLE CUTOFF WALLPACK

## JUNCTION BOX INSTALLATION:

1. Tilt the fixture up at least 90°, use a screwdriver to loosen the screws securing the driver box cover, take off driver box back plate.
2. Secure the driver box back plate to the junction box. Hang the fixture on the back plate, insert the power cord. Connect the wires: Black to Black, White to White, Green to Green. Choose needed color temperature by adjusting switch.
3. Close fixture and tighten the 2 screws. Adjust the fixture to the desired angle.

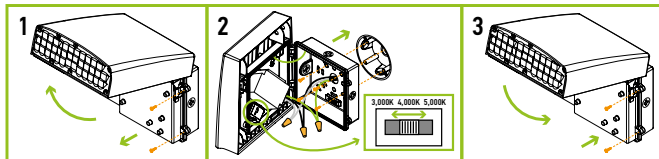

## PHOTOCELL INSTALLATION

ASD-PC-WLP

### sold separately:

1. Unscrew the side knockout on the housing. Screw the photocell into the knockout hole.
2. Unscrew two screws on the side of the fixture, open the fixture, insert connector on black-grey wire to the photocell.
3. Close the fixture and tighten two screws back.

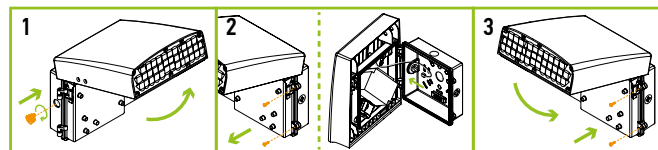

## WALL INSTALLATION:

1. Tilt the fixture up at least 90°, use a screwdriver to loosen the screws securing the driver box cover, take off driver box back plate.
2. Secure the driver box back plate to the wall and remove one of the side caps, insert the power cord. Hang the fixture on the back plate. Connect the wires: Black to Black, White to White, Green to Green. Choose needed color temperature by adjusting switch.
3. Close fixture and tighten the 2 screws. Adjust the fixture to the desired angle. For outdoor locations it is recommended to use silicone (not included).

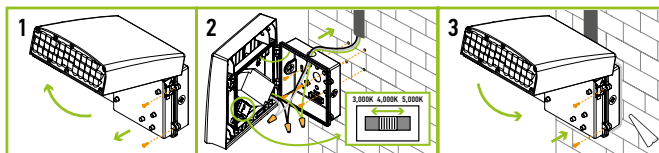

For most up-to-date spec sheets please refer to [asd-lighting.com](http://asd-lighting.com)

