



LED ROUND LOW BAY LIGHT WITH MOTION SENSOR

► **DESIGN & OPTIONS** - LED ROUND LOW BAY WITH MOTION SENSOR has vandal-proof and powder coated die-cast aluminum housing that provides excellent heat dissipation. The built-in bi-level microwave motion sensor will turn off the fixture automatically when no motion is detected. It comes with 120-277V and a 0-10V dimmable driver. This fixture also includes a color selectable option, letting you set it to 3,000K, 4,000K or 5,000K with a simple switch. It comes with a BRONZE or WHITE finish.

► **INSTALLATION** - The fixture can be either surface mounted (directly on surface or with surface mounting bracket, sold separately) or pendant mounted. Refer to installation instructions for detailed steps.

► **APPLICATION** - The LED ROUND LOW BAYS WITH MOTION SENSOR are a durable and efficient solution for lighting parking garages, gas stations, tunnels, train stations, underpasses, storefront soffits, and more. The fixture is Wet Locations rated and can operate in temperatures between -22 to 122°F (-30 to 50°C), allowing it to be utilized in a wide variety of applications and climates.

► **ENERGY SAVINGS & EFFICIENCY** - With a calculated lifespan up to 174,000 hours, these fixtures are made to last decades under normal operation! This fixture can cut your electric bill by up to 80% instantly and will save you a significant amount of money in its lifetime.

► **CERTIFICATION & WARRANTY** - Buy with confidence: ASD provides a 5-year limited warranty along with UL certification to guarantee top quality products and safety!

DLC Premium classification allow participation in rebates; please check the rebate programs available in your state.

Catalog number	
Notes	
Type	

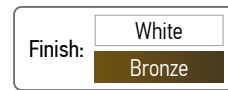
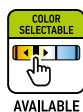

Model	Watts	Voltage	Dimmable	Lumens	CCT	Finish	Dimensions (LxWxH)
ASD-LRLB-100D50-MS-PRM	100W	120-277 V	1-10 V	12,487 lm	5,000 K	White	11" x 11" x 3-1/8"
ASD-LRLB-55DCC-MS-WH-PRM	55W	120-277 V	1-10 V	6,297/7,312/6,987 lm	3CCT (3,000/4,000/5,000 K)	White	10" x 10" x 3-1/8"
ASD-LRLB-55DCC-MS-BZ-PRM	55W	120-277 V	1-10 V	6,297/7,312/6,987 lm	3CCT (3,000/4,000/5,000 K)	Bronze	10" x 10" x 3-1/8"

PRODUCT SPECIFICATIONS:

Construction & Materials			Electrical system		
Housing	Aluminum		Input voltage	120-277 V	
Lens	PC		Max input current	ASD-LRLB-100D50-MS-PRM	1.0 A
Finish	White, Bronze			ASD-LRLB-55DCC-MS-WH-PRM	0.55 A
Weight	ASD-LRLB-100D50-MS-PRM	5.5 lb (2.5 kg)	ASD-LRLB-55DCC-MS-BZ-PRM	35 A (0.065 S)	
	ASD-LRLB-55DCC-MS-WH-PRM	4.4 lb (2 kg)	ASD-LRLB-100D50-MS-PRM		
	ASD-LRLB-55DCC-MS-BZ-PRM		ASD-LRLB-55DCC-MS-WH-PRM		30 A (0.415 S)
Environmental system			Inrush current (Action time)	ASD-LRLB-55DCC-MS-BZ-PRM	
Work environment	Suitable for Wet Locations, IP65		Off state power	0W	
Operating temperature	-22°F to 122°F (-30°C to 50°C)		Power consumption	ASD-LRLB-100D50-MS-PRM	100W
L-70 Life	R > 54,000 hrs; C > 174,000 hrs			ASD-LRLB-55DCC-MS-WH-PRM	55W
				ASD-LRLB-55DCC-MS-BZ-PRM	
Optical system			Power factor	> 0.9	
Luminous flux	ASD-LRLB-100D50-MS-PRM	12,487 lm	Output voltage	ASD-LRLB-55D50-MS-PRM	60-80 V
	ASD-LRLB-55DCC-MS-WH-PRM	6,297/7,312/6,987 lm	Max output current	ASD-LRLB-100D50-MS-PRM	0.69 A
	ASD-LRLB-55DCC-MS-BZ-PRM			ASD-LRLB-55DCC-MS-WH-PRM	0.75 A
Color temperature	5,000 K; 3CCT (3,000/4,000/5,000 K)			ASD-LRLB-55DCC-MS-BZ-PRM	
CRI	> 80				
Dimming compatible controls					
Brand	Lutron			Leviton	Legrand
Models	NTSTV-DV	DVTV-WH	NFTV	DS710	IP710 H4FBL3PW

For most up-to-date spec sheets please refer to asd-lighting.com



LED ROUND LOW BAY LIGHT WITH MOTION SENSOR

Regular and voluntary certifications

5-year limited warranty
 DesignLights Consortium (DLC) listed (Classification: Premium) Main: Outdoor luminaires;
 General application: Low output; Primary Use: Parking garage luminaires
 UL certified E473804

PACKAGE CONTENTS:

Description	Q-ty
LED Round Low Bay Light with Motion Sensor	1
Template (A)	1
Box	1

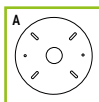

ACCESSORIES (sold separately):

Surface mount bracket ASD-SMB-CAN04

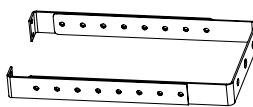

ACCESSORY COMPATIBILITY LIST:

Models	Accessories	Surface mount bracket ASD-SMB-CAN04
ASD-LRLB-100D50-MS-PRM		•
ASD-LRLB-55DCC-MS-WH-PRM		•
ASD-LRLB-55DCC-MS-BZ-PRM		•

BUILT-IN MOTION SENSOR INFORMATION

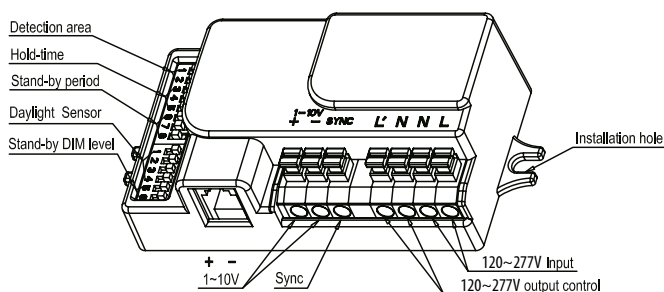

- ▶ Microwave technology allows for active motion sensing regardless of background temperature or line of sight issues
- ▶ Motion easily detected through plastic, glass and other thin non-metal material
- ▶ Sensors are completely contained within the enclosure for IP65 rating
- ▶ 1-10V interface allows for multiple dimming levels and functionality (see below)
- ▶ Integral daylight sensor allows light activation at defined brightness threshold
- ▶ Precise daylight thresholds, time delays and detection areas set via DIP switch (see sensor settings)

Specifications	Model: MC605V
Operating voltage	120-277 V AC
Rated load	400W @120 Vac, 800W @ 220-277 Vac (inductive)
Microwave frequency	5.8 GHz ± 75 MHz, ISM wave band
Microwave power	< 0.5 mW
Stand-by power	< 1W
Detection range	8 m (@3 m mounting height)
Detection area	25%/50%/75%/100%
Hold time	5 s/30 s/90 s/3 min/20 min/+∞
Daylight sensor	5 Lux (0.5 Fc)/15 Lux (1.4 Fc)/30 Lux(2.8 Fc)/50 Lux (4.7 Fc)/100 Lux (9.3 Fc)/150 Lux (14 Fc)/Disable
Stand-by period	0 s/5 s/5 min/10 min/30 min/1 h/+∞
Stand-by dimming level	10%/20%/30%/50%
Mounting height	10 m max
Motion detection	0.5-3 m/s
Detection angle	150° (wall installation) 360° (ceiling installation)

 RF interference may affect the operation of this sensor

DIMMING FUNCTION (3 STEP 100% - LOW LIGHT - OFF):

Situation	Sufficient light	Insufficient light and motion	After hold time no further motion	After stand-by period
Light status	OFF	ON - 100%	Low light	Off

For motion sensor adjustment – open the driver box cover. Use the following DIP switch settings to set dimming levels, hold times, standby periods, detection area and daylight sensor mode. By selecting the combination switches to reach the desired sensor settings. Each switch will indicate ON when moved up. Close the driver box cover when the setup is complete.

ON	1	2	
I	ON	ON	100%
II	ON	-	75%
III	-	ON	50%
IV	-	-	25%

Detection area:

Reduce detection area by selecting these switch combinations.

ON	3	4	5	
I	ON	ON	ON	5 s
II	-	ON	ON	30 s
III	ON	-	ON	90 s
IV	-	-	ON	3 min
V	ON	ON	-	20 min
VI	-	-	-	+∞

Hold time:

Refers to the time the lamp remains at 100% after no further motion is detected.

ON	6	7	8	
I	ON	ON	ON	0 s
II	-	ON	ON	5 s
III	ON	-	ON	5 min
IV	-	-	ON	10 min
V	ON	ON	-	30 min
VI	-	ON	-	1 h
VII	-	-	-	+∞

Stand by period:

Refers to the time the light stays on at low light level before it shuts completely off in the long absence of motion. Daylight sensor switch must be enabled.

ON	1	2	
I	ON	ON	50%
II	-	ON	30%
III	ON	-	20%
IV	-	-	10%

Stand by dimming period:

This is the low light level after the hold time in the long absence of motion.

ON	3	4	5	6	
I	ON	ON	ON	ON	5 Lux (0.5 Fc)
II	-	ON	ON	ON	15 Lux (1.4 Fc)
III	ON	-	ON	ON	30 Lux (2.8 Fc)
IV	-	-	ON	ON	50 Lux (4.7 Fc)
V	ON	ON	-	ON	100 Lux (9.3 Fc)
VI	ON	ON	ON	-	150 Lux (14 Fc)
VII	-	-	-	-	Disable

Daylight sensor:

The sensor can be set to allow for illumination at a desired brightness. When set to disable mode, the daylight sensor will turn on the light when there is motion regardless of the ambient light level 100 Lux (9.3 Fc), 50 Lux (4.7 Fc); for darkness operation only.

Note: the sensor is only active when the light is totally off.

DIMMING FUNCTION (2 STEP 100% - LOW LIGHT):

Situation	No motion	Motion	After hold up time no further motion
Light status	Low light	On - 100%	Low light

Note: 2 step dimming requires that daylight sensor be set to disable mode.

For most up-to-date spec sheets please refer to asd-lighting.com



LED ROUND LOW BAY LIGHT WITH MOTION SENSOR

INSTALLATION GUIDE

IMPORTANT SAFETY INFORMATION:

Please read all the instructions below before installation.

- ▶ Make sure that the supply voltage corresponds to the rated product voltage.
- ▶ The product must be installed by a qualified electrician in accordance with the National Electrical Code and corresponding local codes.
- ▶ If the product is damaged, do not use it.

POLE MOUNTING:

1. Disassemble the fixture by removing the four screws along the perimeter of the fixture. Remove the 3/4 inch plug in the center knockout on top.
2. Thread the top of the fixture on to a 3/4 inch conduit pipe.
3. Attach the safety wire from the base to the top. Connect the wires: Black to Black, White to White, Green to Green. Secure the connection with wire nuts. Choose needed color temperature by adjusting the switch. Reassemble the housing by screwing the perimeter screws back into place.

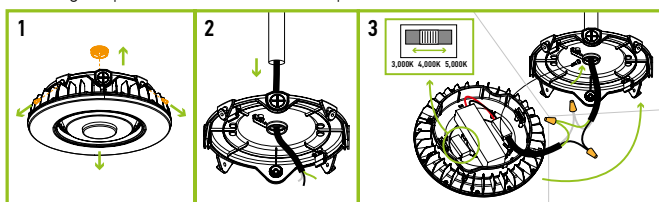

SURFACE MOUNTING:

1. Disassemble the fixture by removing the four screws along the perimeter of the fixture. Remove the 3/4 inch plug in the center knockout on top.
2. Drill pilot holes. Bolt the top to the ceiling.
3. Attach the safety wire from the base to the top. Connect the wires: Black to Black, White to White, Green to Green. Secure the connection with wire nuts. Choose needed color temperature by adjusting the switch. Reassemble the housing by screwing the perimeter screws back into place.

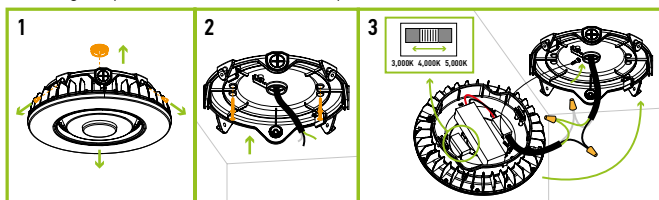

⚠ WARNING

RISK OF PERSONAL INJURY – READ and follow all WARNINGS and installation instructions. Keep or give to the owner for future reference.

Risk of cuts: Wear gloves to prevent cuts or abrasions when removing from carton, handling, installing, and maintaining this product.

Risk of electric shock: This product must be installed in accordance with the applicable installation code by a person familiar with the construction and operation of the product and the hazards involved.

Risk of Fire: Minimum 194°F supply conductors. Consult a qualified electrician to ensure correct branch circuit conductor.

ASD® assumes no responsibility for claims arising out of improper or careless installation or handling of this product.

ELECTRICAL SCHEMATIC DIAGRAM:

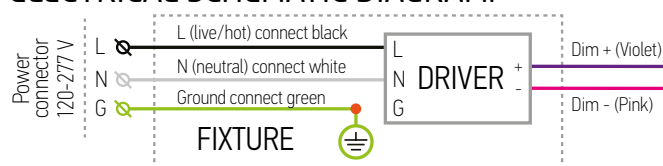

SURFACE MOUNTING BRACKET

ASD-SMB-CAN04 sold separately:

1. Disassemble the fixture by removing the four screws along the perimeter of the fixture. Remove the 3/4 inch plug in the center knockout on top. Screw one side of the mounting bracket to the ceiling.
2. Screw the other side to the top of the fixture. Align both halves of the bracket and screw them together.
3. Attach the safety wire from the base to the top. Connect the wires: Black to Black, White to White, Green to Green. Secure the connection with Wire Nuts. Choose needed color temperature by adjusting the switch. Reassemble the housing by screwing the perimeter screws back into place.

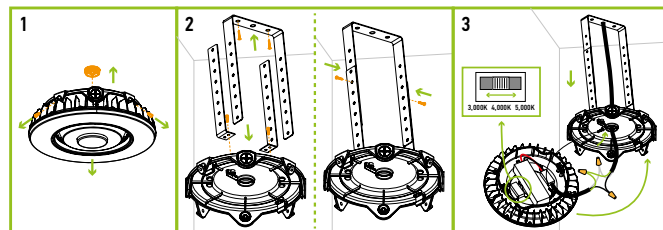

ORDERING INFORMATION

Model	UPC	Pcs. per carton	Carton size	Carton weight	GTIN 14
ASD-LRLB-100D50-MS-PRM	819201025602	2	13.6' x 11.8' x 13.6'	13.4 lb	10819201025609
ASD-LRLB-55DCC-MS-WH-PRM	810050730143	2	12.6' x 11.8' x 12.6'	12.1 lb	10810050730140
ASD-LRLB-55DCC-MS-BZ-PRM	810050731348	2	12.6' x 11.8' x 12.6'	12.1 lb	10810050731345

ACCESSORIES:

Model	Name	UPC	Pcs. per carton	Carton size	Carton weight	GTIN 14
ASD-SMB-CAN04	Surface mounting bracket	819201023219	20	16.7' x 14.2' x 12.8'	33.07 lbs	10819201023216

For most up-to-date spec sheets please refer to asd-lighting.com