



# LED POST TOP CORN BULB

## Standard Series

► **DESIGN & OPTIONS** - LED POST TOP CORN BULB has a traditional design that gives it a stylish look with effective illumination. This super bright, energy-efficient LED BULB is designed to replace metal-halide (MH) and other high-intensity discharge (HID) fixtures. These non-weatherproof bulbs have shatterproof polycarbonate lenses and operates within a wide 120-277V range.

► **INSTALLATION** - Mogul EX39 and Medium E26 screw bases allow for easy installation in MH fixtures (ballast can be removed or bypassed) and can be installed at either end of the bulb for maximum illumination. By using the TP24 connector, the revisable mogul base can change the light distribution depending on your needs.

► **APPLICATION** - This fixture is a direct replacement for metal-halide in outdoor pole or arm-mounted decorative luminaires and was designed for both indoor and outdoor lighting. This makes it the perfect bulb for garages, driveways, barns, patios, gardens, shopping malls and anywhere else that needs a bright light. The LED POST TOP CORN BULB can also retrofit conventional fixtures with operating temperatures between -4+113°F (-20+45°C).

► **ENERGY SAVING & EFFICIENCY** - This fixture provides a lumen output equal to MH/HPS and will save you up to 80% on your electric bill instantly. With a lifespan of 36,000 hours, these fixtures are made to last decades under normal operation! This fixture will save you a lot of money in its lifetime.

► **CERTIFICATION & WARRANTY** - Buy with confidence: ASD provides a 5-year warranty along with UL and DLC Standard certifications to guarantee top quality products and safety!

Top US certifications allow participation in rebates; please check the rebate programs available in your state.

Catalog number	
Notes	
Type	



### PRODUCT LEGEND:

Family	Watts	Dimmable	CCT	Base
ASD-LED-PCR	XX	X	XX	XXXX
LED Post Top Corn light	30 = 30 W 50 = 50 W 80 = 80 W	N = Non-dimmable	50 = 5,000 K	E26 EX39

### LED POST TOP CORN BULB:

Model	Watts	Lumens	CCT	Dimensions (LxWxH)	Base
ASD-LED-PCR-30N50-E26	30 W	3,688 lm	5,000 K	5 1/8" x 5 1/8" x 7"	E26
ASD-LED-PCR-50N50-E26	50 W	5,633 lm	5,000 K	5 1/8" x 5 1/8" x 7"	E26
ASD-LED-PCR-50N50-EX39	50 W	5,633 lm	5,000 K	5 1/8" x 5 1/8" x 7"	EX39
ASD-LED-PCR-80N50-EX39	80 W	9,325 lm	5,000 K	5 1/8" x 5 1/8" x 8"	EX39

### ORDERING INFORMATION:

Model	UPC	Pcs per Carton	Carton Size	Carton Weight	GTIN-14
ASD-LED-PCR-30N50-E26	819201025015	6	22" x 10" x 15.2"	12.3 lb	10819201025012
ASD-LED-PCR-50N50-E26	819201026319	6	22" x 10" x 15.2"	13.4 lb	10819201026316
ASD-LED-PCR-50N50-EX39	819201025022	6	22" x 10" x 15.2"	13.4 lb	10819201025029
ASD-LED-PCR-80N50-EX39	819201025039	6	22" x 11" x 15.2"	15.4 lb	10819201025036

For most up-to-date spec sheets please refer to [asd-lighting.com](http://asd-lighting.com)



# LED POST TOP CORN BULB

Standard Series

## PRODUCT SPECIFICATIONS:

Construction & Materials				
Housing	Plastic			
Finish	White			
Cover	Clear			
Weight	ASD-LED-PCR-30N50-E26	1.3 lb (0.6 kg)	ASD-LED-PCR-50N50-EX39	1.5 lb (0.7 kg)
	ASD-LED-PCR-50N50-E26	1.5 lb (0.7 kg)	ASD-LED-PCR-80N50-EX39	1.7 lb (0.8 kg)
Environmental System				
Work Environment	Suitable for Damp Locations, IP64			
Operating Temperature	-4°F to 113°F / -20°C to 45°C			
L-70 Life	R > 36,000 hrs, C > 141,000 hrs			
Optical System				
Luminous Flux	ASD-LED-PCR-30N50-E26	3,688 lm	ASD-LED-PCR-50N50-EX39	5,633 lm
	ASD-LED-PCR-50N50-E26	5,633 lm	ASD-LED-PCR-80N50-EX39	9,325 lm
Color Temperature	5,000 K			
CRI	> 80			
Electrical System				
Input Voltage	120-277V AC			
Max input current	ASD-LED-PCR-30N50-E26	0.33 A	ASD-LED-PCR-50N50-EX39	0.55 A
	ASD-LED-PCR-50N50-E26	0.55 A	ASD-LED-PCR-80N50-EX39	0.88 A
Inrush current (Action time)	ASD-LED-PCR-30N50-E26	30 A (0.35 S)	ASD-LED-PCR-50N50-EX39	40 A (0.45 S)
	ASD-LED-PCR-50N50-E26	40 A (0.45 S)	ASD-LED-PCR-80N50-EX39	50 A (0.5 S)
AC input range	min 100 V max 277 V			
Power Factor	≥ 0.9			
Off State Power	0 W			
Power Consumption	ASD-LED-PCR-30N50-E26	30 W	ASD-LED-PCR-50N50-EX39	50 W
	ASD-LED-PCR-50N50-E26	50 W	ASD-LED-PCR-80N50-EX39	80 W
Output voltage	ASD-LED-PCR-30N50-E26	40-50 V	ASD-LED-PCR-50N50-EX39	40-50 V
	ASD-LED-PCR-50N50-E26	40-50 V	ASD-LED-PCR-80N50-EX39	35-45 V
Max output current	ASD-LED-PCR-30N50-E26	570 mA	ASD-LED-PCR-50N50-EX39	940 mA
	ASD-LED-PCR-50N50-E26	940 mA	ASD-LED-PCR-80N50-EX39	1,75 A
LED Driver Class	Class 2			

### Warranty & Certifications

5-year limited warranty

DesignLights Consortium (DLC) listed (Classification: Standard) E488932  
 Main: Mogul (E39) Screw-Base Replacements for HID Lamps; General Application: Low Output;  
 Primary Use: Replacement Lamps for Outdoor Pole/Arm-mounted Decorative Luminaires (Type B)

The LED Post Top Corn Bulb designed as a Lamp Replacement of Outdoor Pole/Arm-mounted Decorative Luminaires.

## PACKAGE CONTENTS:

Description	Q-ty
LED Post Top Corn Light Fixture	1
Box	1
Cut sheet	2

## INSTALLATION GUIDE

### IMPORTANT SAFETY INFORMATION:

Please read all the instructions below before installation.

- ▶ Make sure that the supply voltage corresponds to the rated product voltage.
- ▶ The product must be installed by a qualified electrician in accordance with the National Electrical Code and corresponding local codes.
- ▶ If the product is damaged, do not use it.

### ⚠ WARNING

**RISK OF PERSONAL INJURY – READ and follow all WARNINGS and installation instructions.**

Keep or give to the owner for future reference.

**Risk of cuts:** Wear gloves to prevent cuts or abrasions when removing from carton, handling, installing, and maintaining this product.

**Risk of electric shock:** This product must be installed in accordance with the applicable installation code by a person familiar with the construction and operation of the product and the hazards involved.

**Risk of Fire:** Minimum 194°F supply conductors. Consult a qualified electrician to ensure correct branch circuit conductor.

ASD® assumes no responsibility for claims arising out of improper or careless installation or handling of this product.

### INSTALLATION:

Turn off the power. Screw the bulb into a lamp holder in the vertex-down-oriented position. Change the position of the bulb cup if necessary. Ensure that the bulb is seated firmly, turn on the power.

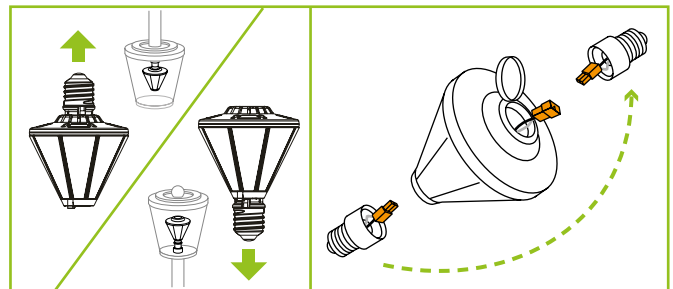

### TO CHANGE THE BULB CAP POSITION:

Remove the bulb cap and unplug the TP24 connector, remove a cover from the opposite side of the bulb. Connect the TP24 connector on the required side of the bulb. Place the bulb cap into the socket and then set and fix the cover on the opposite side.

For most up-to-date spec sheets please refer to [asd-lighting.com](http://asd-lighting.com)

ASD LIGHTING CORP

E-mail: [orders@asd-lighting.com](mailto:orders@asd-lighting.com) | Web site: [www.asd-lighting.com](http://www.asd-lighting.com)

