



LED ADJUSTABLE CUTOFF WALLPACK

► **DESIGN** - LED ADJUSTABLE CUTOFF WALLPACK has a die-cast aluminum housing with excellent heat dissipation, anti-glare PC lens with even light distribution, and anti-leakage silicone gaskets. It is equipped with a removable hinge door for quick and easy installation and wiring. With 6kV surge protection, it is designed to operate on 120-277 circuits with a 0-10V dimmable driver.

► **0-90°** - adjustable head and cut-off design for controllable illumination.

► **COLOR SELECTABLE** - You can choose either a 3,000K warm white, 4,000K cool white or 5,000K daylight color temperature.

► **PHOTOCELL** - The built-in Dusk to Dawn Photocell will automatically turn the fixture on/off depending on the time of day.

► **INSTALLATION** - The fixture can be mounted to a junction box or directly to a wall. Perfect commercial or industrial solution for outdoor building facades, patios, porches, driveways, walkways, decks, parking garages, and many other applications. It is also Wet Locations rated.

► **ADVANTAGES** - With calculated lifespan up to 143,000 hours, these fixtures are made to last decades under normal operation! ASD provides a 5-year limited warranty along with UL and DLC Premium certifications to guarantee top quality products and safety!

Catalog number	
Notes	
Type	



Model	Watts	Voltage	Dimmable	Lumens	CCT	Finish	Dimensions (LxWxH)	Option
ASD-WLP02A-12DAC-BK	12W	120-277 V	0-10 V	1,521/1,686/1,574 lm	3CCT (3,000/4,000/5,000 K)	Black	5-7/8" x 5-1/16" x 3-9/16"	-
ASD-WLP02A-30DAC-BK	30W	120-277 V	0-10 V	3,675/4,058/3,772 lm	3CCT (3,000/4,000/5,000 K)	Black	9-1/8" x 7-5/8" x 4-5/8"	-
WLP02A-PC WITH PHOTOCELL								
ASD-WLP02A-12DAC-PC-BK	12W	120-277 V	0-10 V	1,500/1,686/1,574 lm	3CCT (3,000/4,000/5,000 K)	Black	5-7/8" x 5-1/16" x 3-9/16"	Photocell
ASD-WLP02A-30DAC-PC-BK	30W	120-277 V	0-10 V	3,750/4,058/3,772 lm	3CCT (3,000/4,000/5,000 K)	Black	9-1/8" x 7-5/8" x 4-5/8"	Photocell
ASD-WLP02A-50DAC-PC-BK	50W	120-277 V	0-10 V	6,250/7,047/6,644 lm	3CCT (3,000/4,000/5,000 K)	Black	9-1/8" x 7-5/8" x 4-5/8"	Photocell

ORDERING INFORMATION

Model	UPC	Pcs. per carton	Carton size	Carton weight	GTIN 14
ASD-WLP02A-12DAC-BK	810050737104	12	15.4" x 13.2" x 15"	25.7 lbs	10810050737101
ASD-WLP02A-30DAC-BK	810050737111	6	18.4" x 17.9" x 10.9"	28.3 lbs	10810050737118
WLP02A-PC WITH PHOTOCELL					
ASD-WLP02A-12DAC-PC-BK	810128110563	12	15.4" x 13.2" x 15"	25.7 lbs	10810128110560
ASD-WLP02A-30DAC-PC-BK	810128110273	6	18.4" x 17.9" x 10.9"	28.3 lbs	10810128110270
ASD-WLP02A-50DAC-PC-BK	810128110280	6	18.4" x 17.9" x 10.9"	30.6 lbs	10810128110287

ACCESSORIES:

Model	Description	UPC	Pcs. per carton	Carton size	Carton weight	GTIN 14
ASD-PC-WLP	Photocell	810050735773	100	5.1" x 4.1" x 10.2"	1.1 lbs	30810050735774

For most up-to-date spec sheets please refer to asd-lighting.com

ASD LIGHTING CORP

E-mail: orders@asd-lighting.com | Web site: www.asd-lighting.com





LED ADJUSTABLE CUTOFF WALLPACK

PRODUCT SPECIFICATIONS:

Construction & Materials			
Housing	Aluminum		
Lens	PC		
Finish	Black		
Weight	ASD-WLP02A-12DAC-BK	1.9 lbs (0.9 kg)	
	ASD-WLP02A-30DAC-BK	4.3 lbs (2 kg)	
	ASD-WLP02A-12DAC-PC-BK	1.9 lbs (0.9 kg)	
	ASD-WLP02A-30DAC-PC-BK	4.3 lbs (2 kg)	
	ASD-WLP02A-50DAC-PC-BK	4.7 lbs (2.1 kg)	
Environmental system			
Work environment	Suitable for Wet Locations, IP65		
Operating temperature	-40°F to 122°F (-40°C to 50°C)		
L-70 Life	R > 44,000 hrs; C > 143,000 hrs		
Optical system			
Luminous flux	ASD-WLP02A-12DAC-BK	1,521/1,686/1,574 lm	
	ASD-WLP02A-30DAC-BK	3,675/4,058/3,772 lm	
	ASD-WLP02A-12DAC-PC-BK	1,500/1,686/1,574 lm	
	ASD-WLP02A-30DAC-PC-BK	3,750/4,058/3,772 lm	
	ASD-WLP02A-50DAC-PC-BK	6,250/7,047/6,644 lm	
Color temperature	3CCT switch (3,000/4,000/5,000 K), 5,000 K by default		
CRI	> 70		
Electrical system			
Input voltage	120-277 V		
Max input current	ASD-WLP02A-12DAC-BK	0.2 A	
	ASD-WLP02A-30DAC-BK	0.4 A	
	ASD-WLP02A-12DAC-PC-BK	0.2 A	
	ASD-WLP02A-30DAC-PC-BK	0.4 A	
	ASD-WLP02A-50DAC-PC-BK	0.6 A	
Inrush current (Action time)	ASD-WLP02A-12DAC-BK	0.4 A (0.75 S)	
	ASD-WLP02A-30DAC-BK	0.8 A (0.75 S)	
	ASD-WLP02A-12DAC-PC-BK	0.4 A (0.75 S)	
	ASD-WLP02A-30DAC-PC-BK	0.8 A (0.75 S)	
	ASD-WLP02A-50DAC-PC-BK	1.2 A (0.75 S)	
Off state power	0W		
Power consumption	ASD-WLP02A-12DAC-BK	12W	
	ASD-WLP02A-30DAC-BK	30W	
	ASD-WLP02A-12DAC-PC-BK	12W	
	ASD-WLP02A-30DAC-PC-BK	30W	
	ASD-WLP02A-50DAC-PC-BK	50W	
Power factor	> 0.9		
Output voltage	30-50 V		
Max output current	ASD-WLP02A-12DAC-BK	0.28 A	
	ASD-WLP02A-30DAC-BK	0.7 A	
	ASD-WLP02A-12DAC-PC-BK	0.28 A	
	ASD-WLP02A-30DAC-PC-BK	0.7 A	
	ASD-WLP02A-50DAC-PC-BK	1.15 A	
Surge protection DM/CM	4 kV / 6 kV		
Dimming compatible controls			
Brand	Leviton	Lutron	
Models	IP710-LFZ	NTSTV	DVSTV
Regular and voluntary certifications			
5-year limited warranty			
DesignLights Consortium (DLC) listed (Classification: Premium) Main: Outdoor luminaires; General application: Low/Mid output; Primary use: Outdoor full-cutoff wall-mounted area luminaires			
UL certified E473804			

PACKAGE CONTENTS:

Description	Q-ty
LED Adjustable Cutoff Wallpack or LED Adjustable Cutoff Wallpack with photocell	1
Box	1

ACCESSORIES (sold separately):

Photocell

ASD-PC-WLP

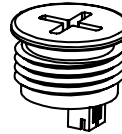

ACCESSORY COMPATIBILITY LIST:

Models	Accessories	Photocell ASD-PC-WLP
ASD-WLP02A-12DAC-BK		
ASD-WLP02A-30DAC-BK		•
ASD-WLP02A-12DAC-PC-BK		
ASD-WLP02A-30DAC-PC-BK		
ASD-WLP02A-50DAC-PC-BK		

BUILT-IN PHOTOCELL INFORMATION



The dusk-to-dawn photocell automatically turns the fixture off during daylight hours.

For models ASD-WLP02A-12DAC-PC-BK and ASD-WLP02A-30DAC-PC-BK:

- The light will turn on at < 30 lux (2.8 fc)
- The light will turn off at > 60 lux (5.6 fc)

For model ASD-WLP02A-50DAC-PC-BK:

- The light will turn on at < 20 lux (1.9 fc)
- The light will turn off at > 70 lux (6.5 fc)

PHOTOCELL INFORMATION



The dusk-to-dawn photocell automatically turns the fixture off during daylight hours.

For model ASD-PC-WLP:

- The light is always ON when luminance is < 30 lux (2.8 fc) (night time)
- The light is always OFF when luminance is > 60 lux (5.6 fc) (day time)

For most up-to-date spec sheets please refer to asd-lighting.com



LED ADJUSTABLE CUTOFF WALLPACK

INSTALLATION GUIDE

IMPORTANT SAFETY INFORMATION:

Please read all the instructions below before installation.

- ▶ Make sure that the supply voltage corresponds to the rated product voltage.
- ▶ The product must be installed by a qualified electrician in accordance with the National Electrical Code and corresponding local codes.
- ▶ If the product is damaged, do not use it.

⚠ WARNING

RISK OF PERSONAL INJURY – READ and follow all WARNINGS and installation instructions. Keep or give to the owner for future reference.

Risk of cuts: Wear gloves to prevent cuts or abrasions when removing from carton, handling, installing, and maintaining this product.

Risk of electric shock: This product must be installed in accordance with the applicable installation code by a person familiar with the construction and operation of the product and the hazards involved.

Risk of Fire: Minimum 194°F supply conductors. Consult a qualified electrician to ensure correct branch circuit conductor.

ASD® assumes no responsibility for claims arising out of improper or careless installation or handling of this product.

ELECTRICAL SCHEMATIC DIAGRAM:

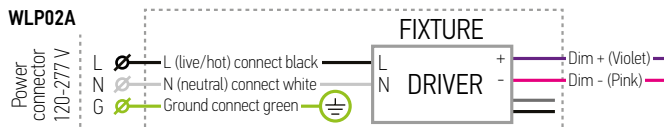

WLP02A with photocell and ASD-WLP02A-12DAC-PC-BK, WLP02A-30DAC-PC with included photocell

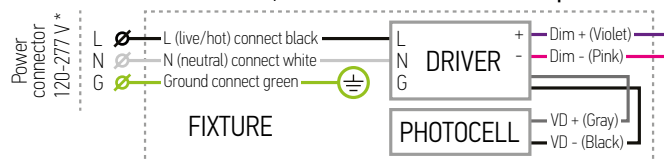

WLP02A-50DAC-PC with included photocell

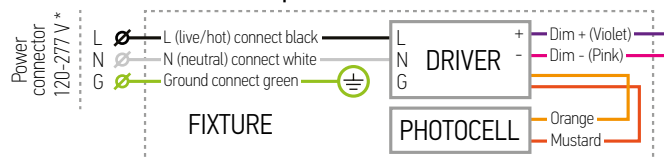

* The regular voltage 120-277V fixtures can be alternatively powered without neutral by two-phase circuit with phase-to-phase voltage of 208V (L1-120V & L2-120V).

WARNING: Phase-to-phase voltage should be less than 277V (160V per each phase) and more than 120V (70V per each phase)! Do not confuse Regular Voltage fixtures of 120-277V with High Voltage ones of 277-480V!

JUNCTION BOX INSTALLATION:

1. Tilt the fixture up at least 90°, use a screwdriver to loosen the screws securing the driver box cover, take off driver box back plate.
2. Secure the driver box back plate to the junction box. Hang the fixture on the back plate, insert the power cord. Connect the wires: Black to Black, White to White, Green to Green. Choose needed color temperature by adjusting switch.
3. Close fixture and tighten the 2 screws. Adjust the fixture to the desired angle.

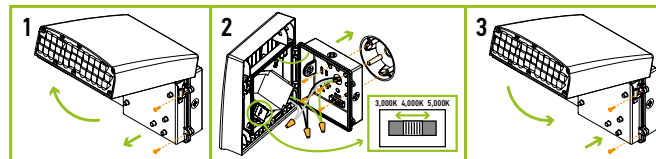

WALL INSTALLATION:

1. Tilt the fixture up at least 90°, use a screwdriver to loosen the screws securing the driver box cover, take off driver box back plate.
2. Secure the driver box back plate to the wall and remove one of the side caps, insert the power cord. Hang the fixture on the back plate. Connect the wires: Black to Black, White to White, Green to Green. Choose needed color temperature by adjusting switch.
3. Close fixture and tighten the 2 screws. Adjust the fixture to the desired angle. For outdoor locations it is recommended to use silicone (not included).

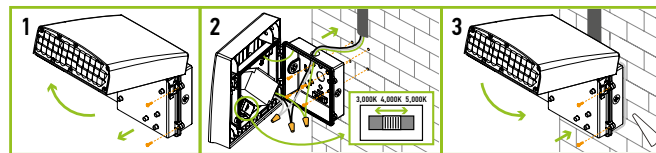

PHOTOCELL INSTALLATION

ASD-PC-WLP sold separately:

1. Unscrew the side knockout on the housing. Screw the photocell into the knockout hole.
2. Unscrew two screws on the side of the fixture, open the fixture, insert connector on black-grey wire to the photocell.
3. Close the fixture and tighten two screws back.

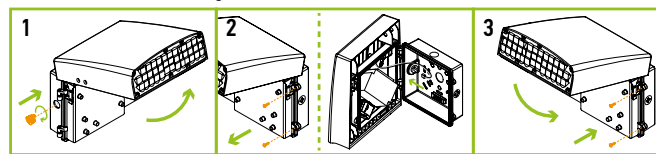

ENABLING THE PHOTOCELL:

By default ASD-WLP02A-PC models come with the photocell disconnected. If the photocell is needed for your application plug the quick connect from the driver into the photocell before wiring to AC power.

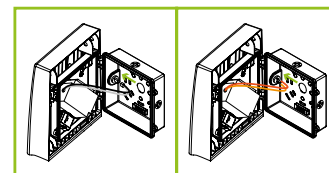

For most up-to-date spec sheets please refer to asd-lighting.com