



# LED EDGE-LIT FLAT PANELS

WITH BATTERY BACK-UP

► **DESIGN & OPTIONS** - LED EDGE-LIT FLAT PANELS WITH BATTERY BACK-UP are equipped with a built-in EM battery that provides 90 minutes of power in case of emergency. They come with a non-yellowing PC diffuser, an anti-corrosion aluminum frame, and a 0-10V dimmable driver at 120-277V with short circuit, circuit overload, and low-voltage protection. Options include a 2x2 or 2x4 size with either a 3500K, 4000K, or 5,000K color temperature. Models with both CCT and power adjustable via dip switch are also available. The CCT options are 3000K, 3500K, 4000K or 5000K, while the wattage options depend on the size of the panel.

► **INSTALLATION** - This fixture has convenient recessed mounting for drop in installation with standard grid ceilings. It can also be suspended via aircraft cable or wire (not included) to the attached clips. The clips can be folded over the "T" grid, locking the light to the grid. The low frame for surface mounting is sold separately. Refer to install instructions for detailed steps.

► **APPLICATION** - These fixtures are perfect for commercial, industrial, and residential applications such as: offices, hospitals, schools, retail, and workshops. They are Damp location rated and can operate in temperatures between 14+104°F (-10+40°C).

► **ENERGY SAVINGS & EFFICIENCY** - This fixture provides a lumen output that is equal to or higher than traditional fluorescent architectural troffers and can cut your electric bill by up to 80% instantly. With a lifespan of 60,000 hours, these fixtures are made to last decades under normal operation! This fixture will save you a significant amount of money in its lifetime.

► **CERTIFICATION & WARRANTY** - Buy with confidence: ASD provides a 5-year warranty along with UL and DLC Standard certifications to guarantee top quality products and safety!

Top US certifications allow participation in rebates; please check the rebate programs available in your state.

Catalog number	
Notes	
Type	

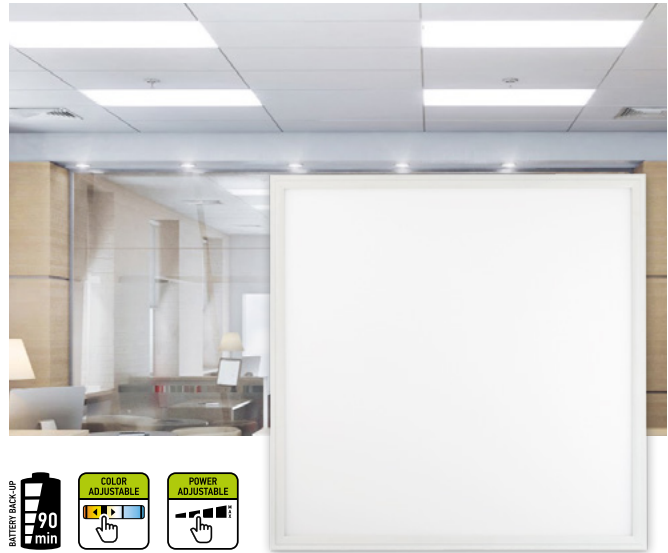

## PRODUCT LEGEND:

Family	Modification	Size	Dimmable	Watts	CCT	Option	Series
ASD-ELP	07	XX	X	XX	XX	XX / XXX	XXX
Edge-Lit Panel	12	22 = type 2x2 24 = type 2x4	A = Power Adjustable D = Dimmable	27 = 27 W 40 = 40 W 35 = 20/25/30/35 W 50 = 35/40/45/50 W	35 = 3,500 K 40 = 4,000 K 50 = 5,000 K CC = 3,000/3,500/4,000/5,000 K	EM = Battery back-up SHE = Battery back-up	Blank = Standard STD = Standard

## LED EDGE-LIT FLAT PANELS WITH BATTERY BACK-UP:

Model	Type	Watts	Voltage	Dimmable	CCT	Lumens	Dimensions (LxWxH)	DLC
ASD-ELP12-22D2740-SHE	2x2	27 W	120-277 V	0-10 V	4,000 K	3,050 lm	23 3/4" x 23 3/4" x 1 3/4"	Standard
ASD-ELP12-22D2750-SHE	2x2	27 W	120-277 V	0-10 V	5,000 K	3,100 lm	23 3/4" x 23 3/4" x 1 3/4"	Standard
ASD-ELP12-24D4035-SHE	2x4	40 W	120-277 V	0-10 V	3,500 K	4,560 lm	47 3/4" x 23 3/4" x 1 3/4"	Standard
ASD-ELP12-24D4040-SHE	2x4	40 W	120-277 V	0-10 V	4,000 K	4,600 lm	47 3/4" x 23 3/4" x 1 3/4"	Standard
ASD-ELP07-22A35CC-EM-STD	2x2	20/25/30/35 W	120-277 V	0-10 V	3,000/3,500/4,000/5,000 K	2,294/2,797/2,854/3,977 lm	23 3/4" x 23 3/4" x 1 3/4"	Standard
ASD-ELP07-24A50CC-EM-STD	2x4	35/40/45/50 W	120-277 V	0-10 V	3,000/3,500/4,000/5,000 K	3,917/4,421/4,887/5,490 lm	47 3/4" x 23 3/4" x 1 3/4"	Standard

For most up-to-date spec sheets please refer to [asd-lighting.com](http://asd-lighting.com)

ASD LIGHTING CORP

E-mail: [orders@asd-lighting.com](mailto:orders@asd-lighting.com) | Web site: [www.asd-lighting.com](http://www.asd-lighting.com)





# LED EDGE-LIT FLAT PANELS

WITH BATTERY BACK-UP

## PRODUCT SPECIFICATIONS:

Construction & Materials						
Housing	Aluminum					
Lens	Translucent white					
Finish Color	White					
Weight	ASD-ELP12-22D2740-SHE	9 lb (4.1 kg)	ASD-ELP12-24D4035-SHE	16.2 lb (7.4 kg)	ASD-ELP07-22A35CC-EM-STD	8.6 lb (3.9 kg)
	ASD-ELP12-22D2750-SHE	9 lb (4.1 kg)	ASD-ELP12-24D4040-SHE	16.2 lb (7.4 kg)	ASD-ELP07-24A50CC-EM-STD	15 lb (6.8 kg)
Environmental System						
Work Environment	Suitable for Damp Locations, IP40					
Operating Temperature	14°F to 104°F (-10°C to 40°C)					
L-70 Life	Modification	ELP07	R > 60,000 hrs C > 158,000 hrs			
		ELP12	R > 54,000 hrs C > 81,000 hrs			
Optical System						
Luminous Flux	ASD-ELP12-22D2740-SHE	3,050 lm	ASD-ELP12-24D4035-SHE	4,560 lm	ASD-ELP07-22A35CC-EM-STD	2,294/2,797/2,854/3,977 lm
	ASD-ELP12-22D2750-SHE	3,100 lm	ASD-ELP12-24D4040-SHE	4,600 lm	ASD-ELP07-24A50CC-EM-STD	3,917/4,421/4,887/5,490 lm
Color Temperature	ASD-ELP12-22D2740-SHE	4,000 K	ASD-ELP12-24D4035-SHE	3,500 K	ASD-ELP07-22A35CC-EM-STD	3,000/3,500/4,000/5000 K
	ASD-ELP12-22D2750-SHE	5,000 K	ASD-ELP12-24D4040-SHE	4,000 K	ASD-ELP07-24A50CC-EM-STD	
CRI	> 80					
Electrical System						
Input Voltage	120-277 V					
Max input current	ASD-ELP12-22D2740-SHE	0.4 A	ASD-ELP12-24D4035-SHE	0.6 A	ASD-ELP07-22A35CC-EM-STD	0.42 A
	ASD-ELP12-22D2750-SHE		ASD-ELP12-24D4040-SHE		ASD-ELP07-24A50CC-EM-STD	
Inrush current (Action time)	0.50 A (0.5 S)					
AC input range	Modification	ELP07	min 90 V max 305 V			
		ELP12	min 100 V max 305 V			
Off State Power	0 W					
Power Consumption	ASD-ELP12-22D2740-SHE	27 W	ASD-ELP12-24D4035-SHE	40 W	ASD-ELP07-22A35CC-EM-STD	20/25/30/35 W
	ASD-ELP12-22D2750-SHE		ASD-ELP12-24D4040-SHE		ASD-ELP07-24A50CC-EM-STD	
Power Factor	> 0.9					
Output voltage	Modification	ELP07	30-40 V			
		ELP12	30-42 V			
Surge protection	2 kV					
LED Driver Class	Modification	ELP07	Class 2			
		ELP12	P, Class 2			
Electrical System						
Battery charging time	≥ 24 hours					
Emergency operation time	≥ 90 minutes					
Emergency watts	ASD-ELP12-22D2740-SHE	8 W	ASD-ELP12-24D4035-SHE	15 W	ASD-ELP07-22A35CC-EM-STD	8 W
	ASD-ELP12-22D2750-SHE		ASD-ELP12-24D4040-SHE		ASD-ELP07-24A50CC-EM-STD	
Emergency Luminous Flux	ASD-ELP12-22D2740-SHE	1,080 lm	ASD-ELP12-24D4035-SHE	2,025 lm	ASD-ELP07-22A35CC-EM-STD	1,080 lm
	ASD-ELP12-22D2750-SHE		ASD-ELP12-24D4040-SHE		ASD-ELP07-24A50CC-EM-STD	
Dimming compatible controls						
Brand	Maxxima	Eaton	Keygma	Leviton	Lutron	
Models	MEW-DM600LV	DF10P-C1	KGM-1A010V	IP710-DLZ	DVSTV-WH	
Dimming Switch						
Standard 0-10 V dimming 5% - 100%						
Regular and Voluntary Certifications						
5-year limited warranty						
DesignLights Consortium (DLC) listed (Classification: Standard)						
Main: Indoor Luminaires; General Application: Troffer;						
Primary Use: Luminaires for Ambient Lighting of Interior Commercial Spaces						
cULus certified E473854 - Recessed mounted panel						
PACKAGE CONTENTS:						
Description	Q-ty					
LED Edge-Lit Flat Panel with battery back-up	2					
Box	1					
Cut Sheet	2					

For most up-to-date spec sheets please refer to [asd-lighting.com](http://asd-lighting.com)

ASD LIGHTING CORP

E-mail: [orders@asd-lighting.com](mailto:orders@asd-lighting.com) | Web site: [www.asd-lighting.com](http://www.asd-lighting.com)





# LED EDGE-LIT FLAT PANELS

WITH BATTERY BACK-UP

## ACCESSORIES (sold separately):

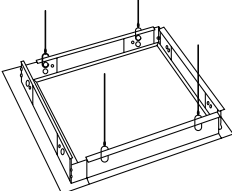
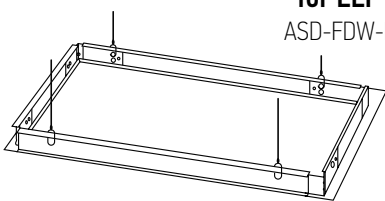
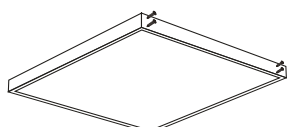
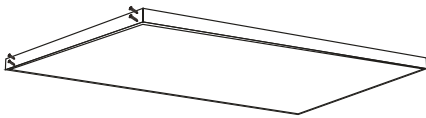
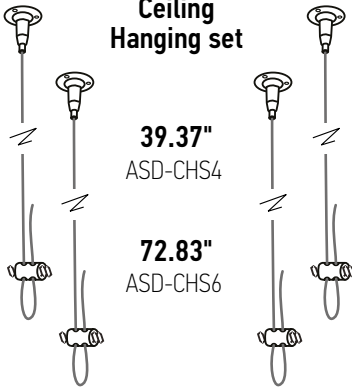
<p><b>Sheetrock mounting frame</b></p> <p>for ELP 2x2 ASD-FDW-ELP22</p>  <p>for ELP 2x4 ASD-FDW-ELP24</p> 	<p><b>Surface mounting Low frame</b></p> <p>for ELP 2x2 ASD-FELP22-L</p>  <p>for ELP 2x4 ASD-FELP24-L</p> 	<p><b>Ceiling Hanging set</b></p>  <p>39.37" ASD-CHS4</p> <p>72.83" ASD-CHS6</p>
--	--	---

## INSTALLATION GUIDE

### IMPORTANT SAFETY INFORMATION:

Please read all the instructions below before installation.

- ▶ Make sure that the supply voltage corresponds to the rated product voltage.
- ▶ The product is designed for indoor use only.

### ⚠ WARNING

**RISK OF PERSONAL INJURY – READ and follow all WARNINGS and installation instructions.**

Keep or give to the owner for future reference.

**Risk of cuts:** Wear gloves to prevent cuts or abrasions when removing from carton, handling, installing, and maintaining this product.

**Risk of electric shock:** This product must be installed in accordance with the applicable installation code by a person familiar with the construction and operation of the product and the hazards involved.

**Risk of Fire:** Minimum 194°F supply conductors. Consult a qualified electrician to ensure correct branch circuit conductor.

ASD® assumes no responsibility for claims arising out of improper or careless installation or handling of this product.

### ELECTRICAL SCHEMATIC DIAGRAM BATTERY BACK-UP:

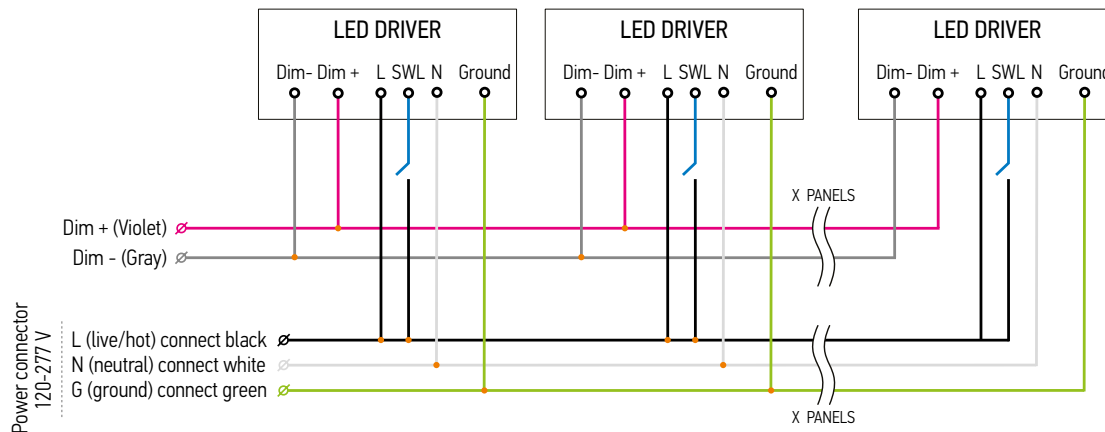

Linking limits: up to 20 panels can be linked together. Total power of LED Panels shall not exceed the wattage of dimmer.

⚠ Connect the battery plug before wiring.

For most up-to-date spec sheets please refer to [asd-lighting.com](http://asd-lighting.com)



# LED EDGE-LIT FLAT PANELS

WITH BATTERY BACK-UP

## INSTALLATION STEPS RECESSED MOUNT:

1. Choose the ceiling panel where you want to install the product, and remove it. For convenience, move adjacent ceiling tiles. Fix the LED Panel into the ceiling; raise up the product above the bar, then place it on T-bars. Two bend points for all four tabs.
2. Secure the panel with the grid as shown in the picture. Ensure the tab is securely attached to the grid. Connect the wires into the junction box of the panel matching colors N, L and G using nuts.
3. Return the adjacent ceiling tiles to their places. Turn on the main power. Installation is finished.

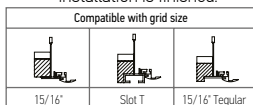
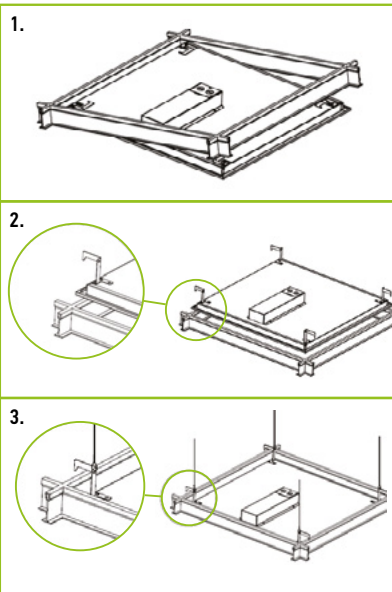

## POWER AND COLOR TEMPERATURE SETTINGS:

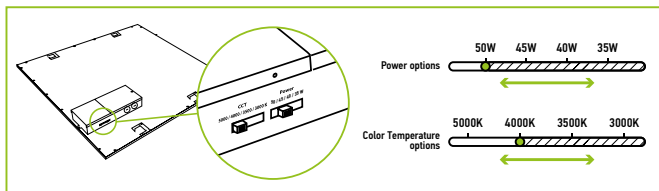

## SUSPENDED MOUNT

ASD-CHS4 ASD-CHS6 sold separately:

1. Make sure that the ceiling can hold the weight of the LED panel and install ceiling brackets suitable to support the weight of the LED panel. Affix cables.
2. Attach the suspended cables to the bends at the edges of the LED flat panel.
3. Connect the wires into the junction box of the panel matching colors N, L and G using nuts. Turn on the main power. Installation is finished.

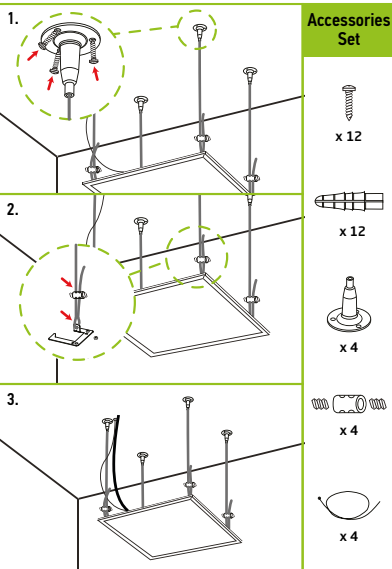

(For 2x4 installation please use 2 sets):

## RECESSED SHEETROCK MOUNT

ASD-FDW-ELP22 ASD-FDW-ELP24 sold separately:

1. Following the picture above, slide part B into the inboard side of parts C and A as shown.
2. Place assembled frame into a ceiling opening and add steel wires for support as pictured below.

**Note:**

- ▶ For best results, attach supporting steel wires going into the ceiling to sides of frame after assembly
  - ▶ End rail can be used as intermediate rail for tandem row
3. After wiring fixture, carefully slide it through ceiling opening, rotate and drop fixture into place.

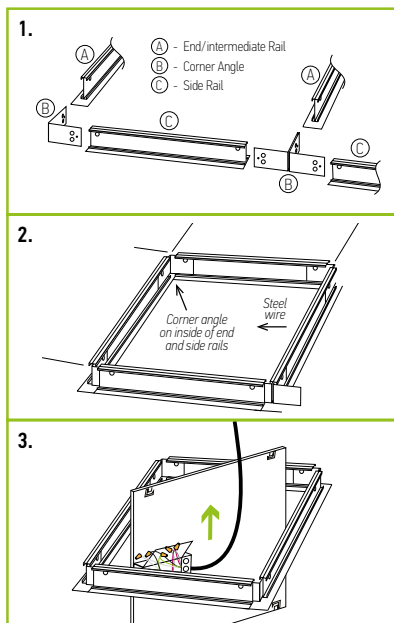

## SURFACE MOUNT

ASD-FELP22-L ASD-FELP24-L sold separately:

**Wall/ceiling mount:**

1. Put the pieces of frame to any horizontal surface. Connect three pieces together with screws (included). Connect these 3 pieces of the frame to the ceiling using four screws.
2. Connect the wires into the junction box of the panel matching colors N, L and G using nuts. Insert the panel into the frame formed by three connected pieces.
3. Attach the fourth piece and secure with screws. Turn on the main power. Installation is complete.

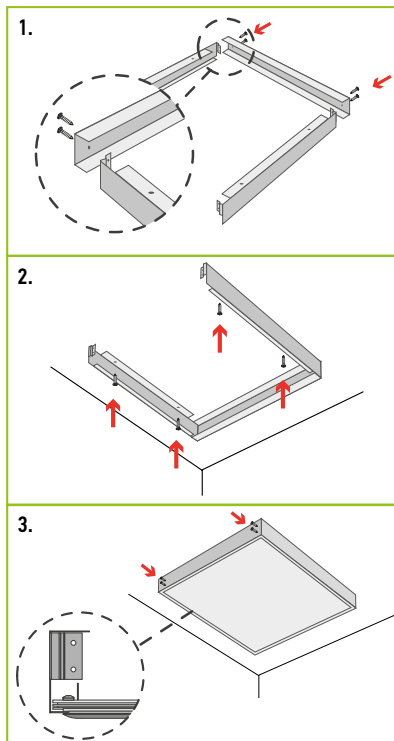

For most up-to-date spec sheets please refer to [asd-lighting.com](http://asd-lighting.com)



# LED EDGE-LIT FLAT PANELS

WITH BATTERY BACK-UP

## BATTERY BACK-UP SYSTEM DETAILS: SIGNAL INDICATOR:

Green LED: Main Power

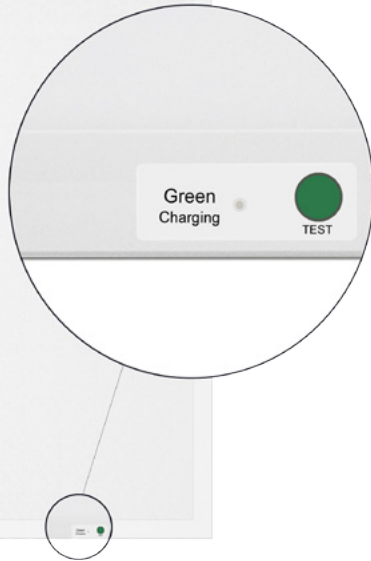

## BATTERY BACK-UP INFORMATION:

Battery capacity	Max battery back-up output power	Battery back-up current	Battery back-up operation time	Battery voltage	Full charge/discharge cycles
2,600mA * 4	8 W	230 mA	≥ 90 minutes	7.4 V	500 cycles
2,600mA * 6	15 W	450 mA	≥ 90 minutes	14.8 V	500 cycles

### Standard operation display status

Operating Condition	<input checked="" type="radio"/> Green LED
Charging	ON
Battery back-up mode	OFF

1. When the green LED is lit, the battery is on charging.
2. When it turn to be emergency situation, the green LED is off.

In order to test the Battery back-up press test switch one time to switch to the emergency mode, press another one time to get back to the AC mode.

### ⚠ WARNING

- ▶ This product should be installed by a qualified electrician. Connecting wires when power is on is not allowed. Power can be turned on after making sure that there is no phenomenon of short circuit and the connection is ok.
- ▶ The wall switch only controls the main power, does not affect emergency lighting.
- ▶ Frequent tests are prohibited. Interval between tests should be not less than one minute.

## ORDERING INFORMATION

### LED EDGE-LIT PANEL:

Model	UPC	Pcs. per Carton	Carton Size	Carton Weight	GTIN 14 for Carton
ASD-ELP12-22D2740-SHE	819201021109	2	24.6" x 24.6" x 2.8"	18.7 lb	10819201021106
ASD-ELP12-22D2750-SHE	819201021116	2	24.6" x 24.6" x 2.8"	18.7 lb	10819201021113
ASD-ELP12-24D4035-SHE	819201021123	2	48.6" x 24.6" x 2.8"	35 lb	10819201021120
ASD-ELP12-24D4040-SHE	819201021130	2	48.6" x 24.6" x 2.8"	35 lb	10819201021137
ASD-ELP07-22A35CC-EM-STD	810050733373	2	24.6" x 24.6" x 2.8"	19.4 lb	10810050733370
ASD-ELP07-24A50CC-EM-STD	810050730365	2	48.6" x 24.6" x 2.8"	33.7 lb	10810050730362

### ACCESSORIES:

Model	Name	Materials	Weight	Dimensions
ASD-FDW-ELP22	ASD Sheetrock mounting frame for ELP 2x2	Iron	0.9 lb (0.4 kg)	25 5/16" x 25 5/16" x 1"
ASD-FDW-ELP24	ASD Sheetrock mounting frame for ELP 2x4	Iron	1.9 lb (0.9 kg)	49 1/4" x 25 5/16" x 1"
ASD-CHS4	ASD 4' Ceiling Hanging set for LED Panels and Troffers	Iron	0.4 lb (0.2 kg)	39.37"
ASD-CHS6	ASD 6' Ceiling Hanging set for LED Panels and Troffers	Iron	0.5 lb (0.2 kg)	72.83"
ASD-FELP22-L	ASD Surface mounting Low Frame for Panels 2x2	Aluminum	2.4 lb (1.1 kg)	23 3/4" x 23 3/4" x 1 15/16"
ASD-FELP24-L	ASD Surface mounting Low Frame for Panels 2x4	Aluminum	3.6 lb (1.7 kg)	47 7/8" x 23 3/4" x 1 15/16"

Model	UPC	Pcs. per Carton	Carton Size	Carton Weight	GTIN 14
ASD-FDW-ELP22	855029006393	20	26.8" x 10.4" x 7.9"	25.1 lb	10855029006390
ASD-FDW-ELP24	857622006107	20	48.6" x 10.4" x 7.9"	48.9 lb	10857622006104
ASD-CHS4	859961005148	50	10.4" x 10.4" x 7.7"	23.7 lb	10859961005145
ASD-CHS6	855029006522	50	8.9" x 8.9" x 8.9"	24.9 lb	10855029006529
ASD-FELP22-L	819201021581	9	25.2" x 6.5" x 7.7"	24.5 lb	10819201021588
ASD-FELP24-L	819201021598	9	48.8" x 5.9" x 7.7"	36.8 lb	10819201021595

For most up-to-date spec sheets please refer to [asd-lighting.com](http://asd-lighting.com)

ASD LIGHTING CORP

E-mail: [orders@asd-lighting.com](mailto:orders@asd-lighting.com) | Web site: [www.asd-lighting.com](http://www.asd-lighting.com)

