



LED UNDER CABINET LIGHT

► **DESIGN & OPTIONS** - LED UNDER CABINET LIGHT with a CRI 90+ is perfect for a hidden backlight. They have smooth dimming capabilities ranging from 100% to 10% with modern LED dimmers, and the Hi/Low switch provides 100% and 50% brightness levels. This fixture is also color adjustable letting you go from 2,700K, to 3,000K, to 4,000K with a simple switch. It comes in 9", 12", 18", 24", 32", 40" and 48" sizes with a WHITE or BRONZE finish.

Models UCS swivel with 50° rotating lens are perfect for directional lighting.

► **INSTALLATION** - Common installation methods for this fixture include: hardwire or plug-in, linking multiple lights together or installing them separately. For your convenience we provide a 6" power cord, 6" linking cord, end-to-end connector, Romex connector and screws. Refer to install instructions for detailed steps.

► **APPLICATION** - These LED UNDER CABINET LIGHTS are an ideal maintenance-free solution for residential and commercial installations. It creates a cozy ambience that is great for your family room, bedroom, cabinet or any other common area in your living space. It is also suitable for Damp locations, making it perfect for kitchens as well. You could also use it as a complimentary light to an already existing main light.

► **ENERGY SAVINGS & EFFICIENCY** - This LED UNDER CABINET LIGHT provides a lumen output equal to or higher than traditional fluorescent under cabinet lights and can cut your electric bill by up to 80% instantly. With a lifespan of 50,000 hours, these fixtures are made to last decades under normal operation! This fixture will save you a significant amount of money in its lifetime.

► **CERTIFICATION & WARRANTY** - Buy with confidence: ASD provides a 5-year warranty along with ETL and ENERGY STAR certifications to guarantee top quality products and safety!

Top US certifications allow participation in rebates; please check the rebate programs available in your state.

Catalog number	
Notes	
Type	

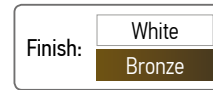

LED UNDER CABINET LIGHT:

Model	Size	Watts	Voltage	Dimmable	Lumens	CCT	Finish	Dimensions (LxWxH)
UCL LINEAR								
ASD-UCL-9D3CC-WH	9 inch	3W	120 V	TRIAC	202/207/214 lm	3CCT (2,700/3,000/4,000 K)	White	9" x 3-5/16" x 1-1/8"
ASD-UCL-12D5CC-WH	12 inch	5W	120 V	TRIAC	383/395/406 lm	3CCT (2,700/3,000/4,000 K)	White	12" x 3-5/16" x 1-1/8"
ASD-UCL-18D8CC-WH	18 inch	8W	120 V	TRIAC	532/533/548 lm	3CCT (2,700/3,000/4,000 K)	White	18" x 3-5/16" x 1-1/8"
ASD-UCL-24D12CC-WH	24 inch	12W	120 V	TRIAC	840/854/874 lm	3CCT (2,700/3,000/4,000 K)	White	24" x 3-5/16" x 1-1/8"
ASD-UCL-32D16CC-WH	32 inch	16W	120 V	TRIAC	1,089/1,104/1,131 lm	3CCT (2,700/3,000/4,000 K)	White	32" x 3-5/16" x 1-1/8"
ASD-UCL-40D20CC-WH	40 inch	20W	120 V	TRIAC	1,479/1,477/1,532 lm	3CCT (2,700/3,000/4,000 K)	White	40" x 3-5/16" x 1-1/8"
ASD-UCL-48D24CC-WH	48 inch	24W	120 V	TRIAC	1,622/1,650/1,781 lm	3CCT (2,700/3,000/4,000 K)	White	48" x 3-5/16" x 1-1/8"
UCS SWIVEL								
ASD-UCS-12D5CC-WH	12 inch	5W	120 V	TRIAC	359/314/317 lm	3CCT (2,700/3,000/4,000 K)	White	12" x 3-7/8" x 1"
ASD-UCS-12D5CC-BZ	12 inch	5W	120 V	TRIAC	359/314/317 lm	3CCT (2,700/3,000/4,000 K)	Bronze	12" x 3-7/8" x 1"
ASD-UCS-18D8CC-WH	18 inch	8W	120 V	TRIAC	508/484/488 lm	3CCT (2,700/3,000/4,000 K)	White	18" x 3-7/8" x 1"
ASD-UCS-18D8CC-BZ	18 inch	8W	120 V	TRIAC	508/484/488 lm	3CCT (2,700/3,000/4,000 K)	Bronze	18" x 3-7/8" x 1"
ASD-UCS-24D12CC-WH	24 inch	12W	120 V	TRIAC	599/610/747 lm	3CCT (2,700/3,000/4,000 K)	White	24" x 3-7/8" x 1"
ASD-UCS-24D12CC-BZ	24 inch	12W	120 V	TRIAC	599/610/747 lm	3CCT (2,700/3,000/4,000 K)	Bronze	24" x 3-7/8" x 1"
ASD-UCS-32D16CC-WH	32 inch	16W	120 V	TRIAC	1,070/1,103/1,097 lm	3CCT (2,700/3,000/4,000 K)	White	31-7/8" x 3-7/8" x 1"
ASD-UCS-40D20CC-WH	40 inch	20W	120 V	TRIAC	1,382/1,430/1,431 lm	3CCT (2,700/3,000/4,000 K)	White	40-1/8" x 3-7/8" x 1"

For most up-to-date spec sheets please refer to asd-lighting.com

ASD LIGHTING CORP

E-mail: orders@asd-lighting.com | Web site: www.asd-lighting.com





LED UNDER CABINET LIGHT

PRODUCT SPECIFICATIONS:

Construction & Materials						
Housing	Aluminum					
Lens	Plastic					
Finish Color	White, Bronze					
Weight	ASD-UCL-9D3CC-WH	1.1 lb (0.5 kg)	ASD-UCL-40D20CC-WH	2.8 lb (1.3 kg)	ASD-UCS-18D8CC-BZ	1.9 lb (0.9 kg)
	ASD-UCL-12D5CC-WH	1.3 lb (0.6 kg)	ASD-UCL-48D24CC-WH	3.2 lb (1.4 kg)	ASD-UCS-24D12CC-WH	2.3 lb (1.1 kg)
	ASD-UCL-18D8CC-WH	1.5 lb (0.7 kg)	ASD-UCS-12D5CC-WH	1.4 lb (0.7 kg)	ASD-UCS-24D12CC-BZ	
	ASD-UCL-24D12CC-WH	1.9 lb (0.9 kg)	ASD-UCS-12D5CC-BZ		ASD-UCS-32D16CC-WH	3 lb (1.4 kg)
	ASD-UCL-32D16CC-WH	2.3 lb (1 kg)	ASD-UCS-18D8CC-WH	1.9 lb (0.9 kg)	ASD-UCS-40D20CC-WH	3.6 lb (1.7 kg)
Environmental System						
Work Environment	Suitable for Damp Locations					
Operating Temperature	-4°F to 113°F (-20°C to 45°C)					
L-70 Life	> 50,000 hrs					
Optical System						
Luminous Flux	ASD-UCL-9D3CC-WH	202/207/214 lm	ASD-UCL-40D20CC-WH	1,479/1,477/1,532 lm	ASD-UCS-18D8CC-BZ	508/484/488 lm
	ASD-UCL-12D5CC-WH	383/395/406 lm	ASD-UCL-48D24CC-WH	1,622/1,650/1,781 lm	ASD-UCS-24D12CC-WH	599/610/747 lm
	ASD-UCL-18D8CC-WH	532/533/548 lm	ASD-UCS-12D5CC-WH	359/314/317 lm	ASD-UCS-24D12CC-BZ	
	ASD-UCL-24D12CC-WH	840/854/874 lm	ASD-UCS-12D5CC-BZ		ASD-UCS-32D16CC-WH	1,070/1,103/1,097 lm
	ASD-UCL-32D16CC-WH	1,089/1,104/1,131 lm	ASD-UCS-18D8CC-WH	508/484/488 lm	ASD-UCS-40D20CC-WH	1,382/1,430/1,431 lm
Color Temperature	3CCT (2,700/3,000/4,000 K)					
CRI	> 90					
Electrical System						
Input Voltage	120 V					
Max input current	ASD-UCL-9D3CC-WH	0.03 A	ASD-UCL-40D20CC-WH	0.21 A	ASD-UCS-18D8CC-BZ	0.15 A
	ASD-UCL-12D5CC-WH	0.05 A	ASD-UCL-48D24CC-WH	0.23 A	ASD-UCS-24D12CC-WH	
	ASD-UCL-18D8CC-WH	0.082 A	ASD-UCS-12D5CC-WH	0.1 A	ASD-UCS-24D12CC-BZ	
	ASD-UCL-24D12CC-WH	0.12 A	ASD-UCS-12D5CC-BZ		ASD-UCS-32D16CC-WH	
	ASD-UCL-32D16CC-WH	0.165 A	ASD-UCS-18D8CC-WH	0.15 A	ASD-UCS-40D20CC-WH	
Inrush current (Action time)	ASD-UCL-9D3CC-WH	0.03 A (1 S)	ASD-UCL-40D20CC-WH	0.21 A (1 S)	ASD-UCS-18D8CC-BZ	0.15 A (0.5 S)
	ASD-UCL-12D5CC-BZ	0.05 A (1 S)	ASD-UCL-48D24CC-WH	0.23 A (1 S)	ASD-UCS-24D12CC-WH	
	ASD-UCL-18D8CC-WH	0.082 A (1 S)	ASD-UCS-12D5CC-WH	0.1 A (0.5 S)	ASD-UCS-24D12CC-BZ	
	ASD-UCL-24D12CC-WH	0.12 A (1 S)	ASD-UCS-12D5CC-BZ		ASD-UCS-32D16CC-WH	
	ASD-UCL-32D16CC-WH	0.165 A (1 S)	ASD-UCS-18D8CC-WH	0.15 A (0.5 S)	ASD-UCS-40D20CC-WH	
AC input range	min 108 V max 132 V					
Off State Power	0 W					
Power Consumption	ASD-UCL-9D3CC-WH	3W	ASD-UCL-40D20CC-WH	20W	ASD-UCS-18D8CC-BZ	8W
	ASD-UCL-12D5CC-WH	5W	ASD-UCL-48D24CC-WH	24W	ASD-UCS-24D12CC-WH	12W
	ASD-UCL-18D8CC-WH	8W	ASD-UCS-12D5CC-WH	5W	ASD-UCS-24D12CC-BZ	
	ASD-UCL-24D12CC-WH	12W	ASD-UCS-12D5CC-BZ		ASD-UCS-32D16CC-WH	16W
	ASD-UCL-32D16CC-WH	16W	ASD-UCS-18D8CC-WH	8W	ASD-UCS-40D20CC-WH	20W
Power Factor	> 0.9					
Max output current	ASD-UCL-9D3CC-WH	24 mA	ASD-UCL-40D20CC-WH	158 mA	ASD-UCS-18D8CC-BZ	42 mA
	ASD-UCL-12D5CC-WH	39 mA	ASD-UCL-48D24CC-WH	190 mA	ASD-UCS-24D12CC-WH	
	ASD-UCL-18D8CC-WH	64 mA	ASD-UCS-12D5CC-WH	27 mA	ASD-UCS-24D12CC-BZ	
	ASD-UCL-24D12CC-WH	95 mA	ASD-UCS-12D5CC-BZ		ASD-UCS-32D16CC-WH	53 mA
	ASD-UCL-32D16CC-WH	126 mA	ASD-UCS-18D8CC-WH	42 mA	ASD-UCS-40D20CC-WH	44 mA
LED Driver Class	DOB					
Dimming range						
10-100%						
Dimming compatible controls						
Brand	Lutron					
Models	DV-603PG-WH	DV-600P	MACL-153M			
	DVCL-153P	DVL-600P	PD-6WCL-WH			
Regular and Voluntary Certifications						
5-year limited warranty						
ETL certified 3153196						
Energy Star listed						

PACKAGE CONTENTS:

Description	Q-ty
LED Under Cabinet Light	1
End-to-End Connector (A)	1
Romex Connector (B)	1
6" Linking cord (C)	1
6 ft Power cord (D)	1
Screw (E)	2
Screw cap (F)	2
Box	1
Cut sheet	2

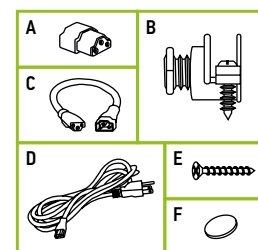

For most up-to-date spec sheets please refer to asd-lighting.com



LED UNDER CABINET LIGHT

INSTALLATION GUIDE

IMPORTANT SAFETY INFORMATION:

Please read all the instructions below before installation.

- ▶ Make sure that the supply voltage corresponds to the rated product voltage.
- ▶ The product must be installed by a qualified electrician in accordance with the National Electrical Code and corresponding local codes.
- ▶ If the product is damaged, do not use it.

⚠ WARNING

RISK OF PERSONAL INJURY – READ and follow all WARNINGS and installation instructions.

Keep or give to the owner for future reference.

Risk of cuts: Wear gloves to prevent cuts or abrasions when removing from carton, handling, installing, and maintaining this product.

Risk of electric shock: This product must be installed in accordance with the applicable installation code by a person familiar with the construction and operation of the product and the hazards involved.

Risk of Fire: Minimum 194°F supply conductors. Consult a qualified electrician to ensure correct branch circuit conductor.

ASD® assumes no responsibility for claims arising out of improper or careless installation or handling of this product.

ELECTRICAL SCHEMATIC DIAGRAM:

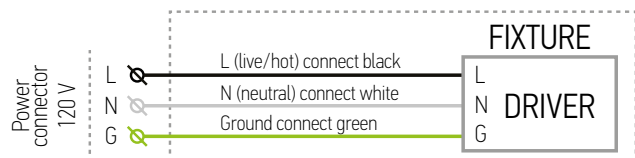

PLUG-IN INSTALLATION:

1. Attach the fixture to the surface using the two screws.
2. Multiple fixtures can be linked together with the end to end connector or linking cord.
3. Choose the preferred color temperature and lighting mode by using the switch.

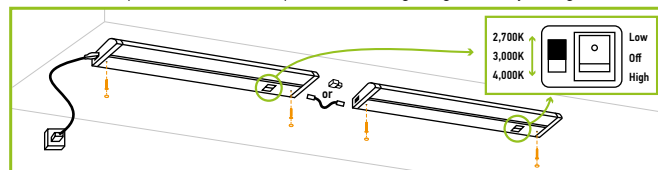

HARDWIRE INSTALLATION:

1. Remove the knock-out. Dismount adapter plate by loosening screw. Insert the Romex connector into the open hole and secure it with the nut.
2. Connect the wires: Black to Black, White to White, Green to Green using wire nuts. Tuck all the wires into the fixture and reattach the adapter plate by tightening the screw.
3. Attach the fixture to the surface using the two screws. Multiple fixtures can be linked together with the end to end connector or linking cord. Choose the preferred color temperature and lighting mode using the switch.

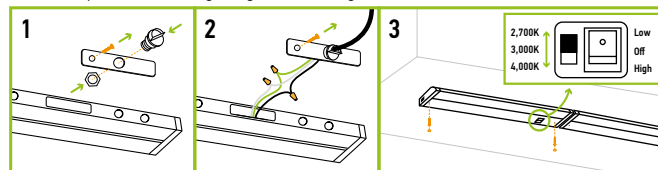

* Multiple fixtures with different sizes and wattages can be linked together, the total wattage must not exceed 200W.

ORDERING INFORMATION

LED UNDER CABINET LIGHT:

Model	UPC	Pcs. per Carton	Carton Size	Carton Weight	GTIN 14 for Carton
UCL LINEAR					
ASD-UCL-9D3CC-WH	810050734196	20	14.8" x 14.4" x 8.7"	27.3 lb	40810050734194
ASD-UCL-12D5CC-WH	810050734202	20	17.3" x 14.8" x 8.7"	31.3 lb	10810050734209
ASD-UCL-18D8CC-WH	810050734226	20	23.2" x 14.8" x 8.7"	35.3 lb	10810050734223
ASD-UCL-24D12CC-WH	810050734240	20	29.3" x 14.8" x 8.7"	44.1 lb	10810050734247
ASD-UCL-32D16CC-WH	810050734264	12	37.4" x 9.1" x 8.7"	34.4 lb	30810050734265
ASD-UCL-40D20CC-WH	810050734271	12	45.3" x 9.1" x 8.7"	40.7 lb	30810050734272
ASD-UCL-48D24CC-WH	810050734288	12	53.3" x 9.1" x 8.7"	46.3 lb	30810050734289
UCS SWIVEL					
ASD-UCS-12D5CC-WH	810050731102	20	17.3" x 14.8" x 8.7"	33.5 lb	30810050731103
ASD-UCS-12D5CC-BZ	810050731119	20	17.3" x 14.8" x 8.7"	33.5 lb	40810050731117
ASD-UCS-18D8CC-WH	810050731126	20	23.2" x 14.8" x 8.7"	42.8 lb	30810050731127
ASD-UCS-18D8CC-BZ	810050731133	20	23.2" x 14.8" x 8.7"	42.8 lb	40810050731131
ASD-UCS-24D12CC-WH	810050731140	20	29.3" x 14.8" x 8.7"	51.6 lb	30810050731141
ASD-UCS-24D12CC-BZ	810050731157	20	29.3" x 14.8" x 8.7"	51.6 lb	40810050731155
ASD-UCS-32D16CC-WH	810050733557	12	37.4" x 9.1" x 8.7"	39.2 lb	50810050733552
ASD-UCS-40D20CC-WH	810050733564	12	45.3" x 9.1" x 8.7"	47.1 lb	50810050733569

For most up-to-date spec sheets please refer to asd-lighting.com