



LED NSF UFO HIGH BAY

► **DESIGN** - LED NSF UFO HIGH BAY features an easy-to-clean, smooth dust-proof surface with a watertight seal that can withstand frequent wash downs and is built with safety and sanitation in mind. is extremely efficient with a 160lm/W output. Corrosion-resistant aluminum housing with SUS316 stainless steel screws provides excellent heat dissipation. Comes with a 6.5ft cord to make the installation process easier. It is designed to operate on 120-277V circuits with a 0-10V dimmable driver.

► **COLOR AND POWER SELECTABLE** - You can choose either a 3,000K warm white, 4,000K cool white or 5,000K daylight color temperature, and change the power with a simple switch.

► **IP69K** - Rating provides protection against ingress of dust and high temperature, high pressure water.

► **NSF** - Certified by the National Sanitation Foundation as safe for food service processing facilities that require a higher level of sanitation.

► **ADVANTAGES** - With calculated lifespan up to 167,000 hours, these fixtures are made to last decades under normal operation! ASD provides a 5-year limited warranty along with UL and DLC Premium certifications to guarantee top quality products and safety!

Catalog number	
Notes	
Type	



Model	Watts	Voltage	Dimmable	Lumens	CCT	Finish	Dimensions (LxWxH)	Cord
ASD-UFS-PRO-200	100/150/200W	120-277 V	0-10 V	up to 31,503 lm	3CCT (3,000/4,000/5,000 K)	White	16-15/16" x 16-15/16" x 5-5/8"	1.2 ft
ASD-UFS-PRO-300	200/240/300W	120-277 V	0-10 V	up to 45,444 lm	3CCT (3,000/4,000/5,000 K)	White	16-15/16" x 16-15/16" x 5-5/8"	1.2 ft

For detailed luminous flux information please refer to Annex 1.

ANNEX 1

Model	Watts	3,000 K	4,000 K	5,000 K
ASD-UFS-PRO-200	100W	17,011 lm	17,635 lm	17,702 lm
	150W	23,914 lm	24,940 lm	24,520 lm
	200W	30,963 lm	32,340 lm	31,503 lm
ASD-UFS-PRO-300	200W	30,053 lm	31,616 lm	31,794 lm
	240W	35,388 lm	37,338 lm	37,095 lm
	300W	44,130 lm	46,286 lm	45,444 lm

ORDERING INFORMATION

Model	UPC	Pcs. per carton	Carton size	Carton weight
ASD-UFS-PRO-200	810128114028	1	17.9" x 17.9" x 7.1"	11.2 lbs
ASD-UFS-PRO-300	810128114301	1	17.9" x 17.9" x 7.1"	11.2 lbs

ACCESSORIES:

Model	Description	UPC	Pcs. per carton	Carton size	Carton weight	GTIN 14
BLD-RM40R	Battery back-up kit 40W	810050738507	4	23.6" x 13.8" x 7.9"	32.5 lbs	20810050738501
BLD-RM60R	Battery back-up kit 60W	810128112154	4	23.6" x 13.8" x 7.9"	37.7 lbs	20810128112158
ASD-EMB40-NLS	Smart battery back-up kit 40W	810128113786	6	13.6" x 14.1" x 16.7"	31.3 lbs	10810128113783
RN1	Remote test switch for battery back-up kit	810050735223	50	13" x 9.8" x 6.5"	8.3 lbs	20810050735227
ASD-PMB-UHB	Pendant mount bracket	810050731522	50	13.9" x 9.7" x 7.1"	33.7 lbs	10810050731529
ASD-PMBJB-UHB	Pendant mount bracket with J-box and spring hook	810050736992	40	17.7" x 11.4" x 21.3"	34.4 lbs	20810050736996

For most up-to-date spec sheets please refer to asd-lighting.com

ASD LIGHTING CORP

E-mail: orders@asd-lighting.com | Web site: www.asd-lighting.com





LED NSF UFO HIGH BAY

PRODUCT SPECIFICATIONS:

Construction & Materials	
Housing	Aluminum
Lens	PC
Finish	White
Weight	9.5 lbs (4.3 kg)
Environmental system	
Work environment	Suitable for Wet Locations, IP69K
Operating temperature	-40°F to 140°F (-40°C to 60°C)
L-70 Life	R > 102,000 hrs; C > 167,000 hrs
Optical system	
Color temperature	3 CCT switch (3,000/4,000/5,000 K), 5,000 K by default
CRI	> 80
Electrical system	
Input voltage	120-277 V
Max input current	ASD-UFS-PRO-200 2.6 A
	ASD-UFS-PRO-300 4 A
Inrush current (Action time)	ASD-UFS-PRO-200 80 A (35 S)
	ASD-UFS-PRO-300 100 A (0.35 S)
Off state power	0W
Power consumption	ASD-UFS-PRO-200 100/150/200W
	ASD-UFS-PRO-300 200/240/300W
Power factor	> 0.9
Output voltage	180-260 V
Max output current	ASD-UFS-PRO-200 0.65-0.9 A
	ASD-UFS-PRO-300 0.1-1.5 A
Surge protection DM/CM	6 kV / 6 kV
Dimming compatible controls	
Brand	Leviton Lutron
Models	IP710-LFZ DVSTV-453P
Regular and voluntary certifications	
5-year limited warranty	
DesignLights Consortium (DLC) listed (Classification: Premium)	
Main: Indoor luminaires; General application: High-bay;	
Primary use: High-bay luminaires for commercial and Industrial buildings	
UL certified E473804	
National Sanitation Foundation	

PACKAGE CONTENTS:

Description	Q-ty
LED NSF UFO High bay	1
Spring hook (A)	1
Box	1

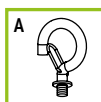

ACCESSORIES (sold separately):

Battery back-up kit 40W
BLD-RM40R

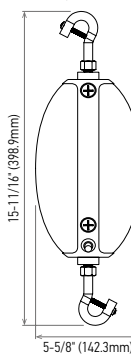

15-11/16" (398.9mm)
5-5/8" (142.3mm)

Battery back-up kit 60W
BLD-RM60R

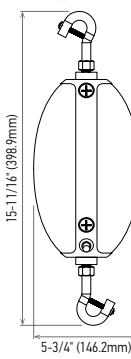

15-11/16" (398.9mm)
5-3/4" (146.2mm)

Smart battery back-up kit 40W
ASD-EMB40-NLS

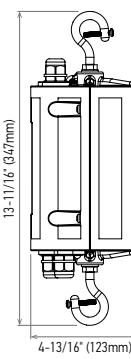

13-11/16" (347mm)
4-13/16" (123mm)

Remote test switch for battery back-up kit
RN1

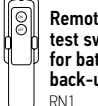

Safety cable

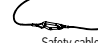

Bluetooth antenna



Pendant mount bracket
ASD-PMB-UHB

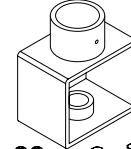

M3*11mm M10 M12
1-1/4" (32mm)
Inner thread 3/4"-14 NPT
M3 internal thread
1/2" (13mm)
2-3/8" (60mm)
2-7/8" (72mm)
1-15/16" (60mm)
1-5/8" (40mm)

Pendant mount bracket with j-box and spring hook
ASD-PMBJB-UHB

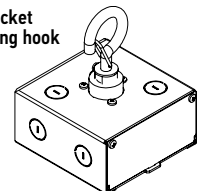

M10 M12
7-3/16" (188mm)
4-3/4" (120mm)
5-1/16" (128mm)

ACCESSORY COMPATIBILITY LIST:

Accessories	Models				
	Battery back-up kit 40W BLD-RM40R	Battery back-up kit 60W BLD-RM60R	Smart battery back-up kit 40W ASD-EMB40-NLS	Pendant mount bracket ASD-PMB-UHB	Pendant mount bracket with j-box and spring hook ASD-PMBJB-UHB
ASD-UFS-PRO-200	•	•	•	•	•
ASD-UFS-PRO-300	•	•	•	•	•

For most up-to-date spec sheets please refer to asd-lighting.com



LED NSF UFO HIGH BAY

BATTERY BACK-UP KIT INFORMATION

BLD-RM40R **BLD-RM60R** sold separately:

BLD-RM40R, BLD-RM60R listed for field and factory installation, provides constant power output to the load during emergency mode operation. They maintain illumination in emergency mode for a minimum of 90 minutes. It is an ideal emergency solution for UFO LED highbay lights.

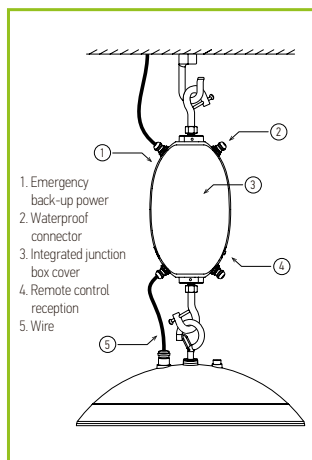

ASD-EMA40-NLS sold separately:

ASD-EMA40-NLS listed for field and factory installation, provides constant power output to the load during emergency mode operation. They maintain illumination in emergency mode for a minimum of 90 minutes. It is an ideal emergency solution for UFO LED highbay. Easy control the testing results and other parameters of the battery with ASD NLS application for smartphone is available.

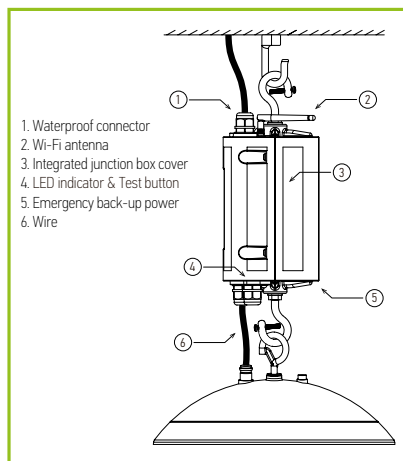





STANDARD OPERATION DISPLAY STATUS:

AC operation: AC power is present. The AC driver operates the LED load as designed. The emergency driver is charging in standby mode. The charging indicator will be lit, showing that the battery is charging.

Emergency operation: When the AC power goes out, the emergency driver detects the AC power outage and automatically switches to emergency mode. When red LED light is OFF, that means driver is discharging. When the AC power is restored, the emergency driver goes back to AC power and starts recharging.

Malfunction mode: This mode can mean that: the battery pack is disconnected or it is broken; the load is disconnected; short circuit or open circuit; the wires are not connected properly; the indicator will be flashing in this case.

Test switch	Emergency mode	Charging	Malfunction mode
 OFF	 OFF	 ON	 Blinking

Specifications	BLD-RM40R	BLD-RM60R	ASD-EMA40-NLS
Input voltage	100-347 V		
Input current	≤ 200 mA		max 0.15 A
Input power	max 15W		max 12W
Standby input power	< 0.8W (finished charging)		< 1W (finished charging)
Maximum standby time between recharges	6 months		At least 6months, can be longer
Driver type	Constant power		0/1-10V dimmable constant current driver
Output power (emergency mode)	40W	60W	40W
Output voltage range	≤ 170 Vdc		≤ 120-200 Vdc (max 250 V)
Lumens	6,000 lm		4,000 lm
Maximum load power	300W (when dimming to a minimum, the power needs to be less than 36W)		350W
Peak output power (emergency mode)	100W (10 S)		400W (200 mS)
Number of output channels	1 channel		
RFI/EMI	FCC part 15 class B		
Output type	LED class 1		
Battery type	Li-ion		
Battery capacity available	2600 mAh (96 WH)		6600 mAh (96 WH)
Battery recharge time	24 hours		
Battery discharge time	90 min		
Maximum lighting fixture weight	44.1 lbs (20 kg)		44 lbs(20 kg)
Self-diagnostic test system	<p>In the normal charging mode, the system performs a self-diagnostic test every 30 days, the system switches to emergency mode for 30S, and then automatically switches back to the normal charging mode.</p> <p>In the normal charging mode, the system switches to emergency mode every 360 days (after 11 monthly self-diagnostic test) and works until the end of discharge. Automatically switches back to normal charging mode after discharge.</p>		
Operating temperature	-32°F to 122°F (0°C to 50°C)		
Service life	50,000 hours		
Input surge protection	2 kV		1 kV
Protections	Over discharge protection, output short circuit protection		Over charge/discharge protection, output overload protection, open load protection
Approvals/class	RoHS, UL924 listed, CEC title 20 Dry/Wet Locations, IP65		

REMOTE TEST SWITCH

RN1 sold separately:

- ▶ Press the ON button to switch battery to the back-up mode. The indicator light will turn off and fixture will decrease light output.
- ▶ Press OFF to switch the fixture to normal operation mode.



For most up-to-date spec sheets please refer to asd-lighting.com



LED NSF UFO HIGH BAY

INSTALLATION GUIDE

IMPORTANT SAFETY INFORMATION:

Please read all the instructions below before installation.

- ▶ Make sure that the supply voltage corresponds to the rated product voltage.
- ▶ The product must be installed by a qualified electrician in accordance with the National Electrical Code and corresponding local codes.
- ▶ If the product is damaged, do not use it.

⚠ WARNING

RISK OF PERSONAL INJURY – READ and follow all WARNINGS and installation instructions.

Keep or give to the owner for future reference.

Risk of cuts: Wear gloves to prevent cuts or abrasions when removing from carton, handling, installing, and maintaining this product.

Risk of electric shock: This product must be installed in accordance with the applicable installation code by a person familiar with the construction and operation of the product and the hazards involved.

Risk of Fire: Minimum 194°F supply conductors. Consult a qualified electrician to ensure correct branch circuit conductor.

ASD® assumes no responsibility for claims arising out of improper or careless installation or handling of this product.

INSTALLATION STEPS:

1. Screw on the spring hook and tighten it. Unscrew the knock-out from the middle of diffusor, choose the power and color temperature with a simple switch.
2. Hang the fixture from the ceiling or other surface using a hook or chain (not provided).
3. Connect the wires: Black to Black, White to White, Green to Green, as well as dimming wires Purple to Purple and Pink to Pink. Secure the connection with wire nuts.

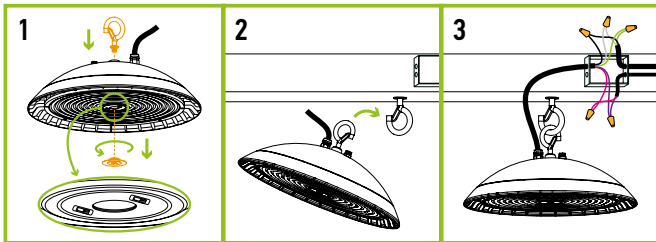

PENDANT MOUNT BRACKET INSTALLATION

ASD-PMB-UHB sold separately:

1. Remove the spring hook from the driver.
2. Install the bracket and secure it to the driver using a M10 or M12 screw (included with the bracket).
3. Screw the bracket with the fixture onto a pole and secure it with an M3 screw (included with the bracket).

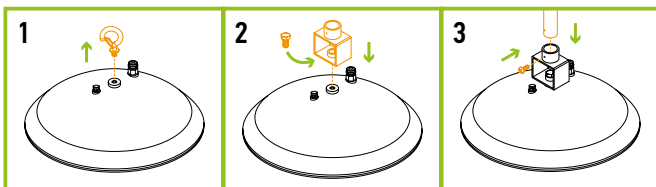

ELECTRICAL SCHEMATIC DIAGRAM:

UFS-PRO

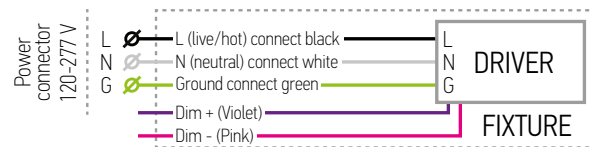

UFS-PRO with battery back-up kit

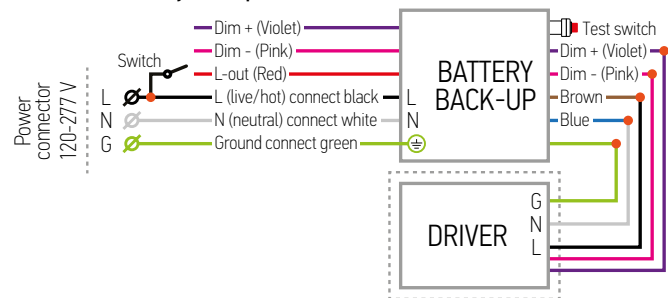

PENDANT MOUNT BRACKET WITH J-BOX AND SPRING HOOK INSTALLATION

ASD-PMBJB-UHB sold separately:

1. Uninstall the spring hook from the fixture. Unscrew 2 screws and open the side plate on the Pendant Junction box. Install M10 or M12 Mounting screw depending of the fixture's thread size.
2. **Mounting hook installation:** Loosen security screw and install the spring hook into the upper installation hole of the Pendant J-box and secure it with screw. Secure Pendant J-box to the fixture, and then secure to the ceiling. Close and secure side plate back into place.
3. **Pendant installation:** Uninstall adapter from pole mounting hole. Secure the Pendant J-box and fixture to the pole. Secure fixture to the Pendant J-box. Close and secure side plate back into place.

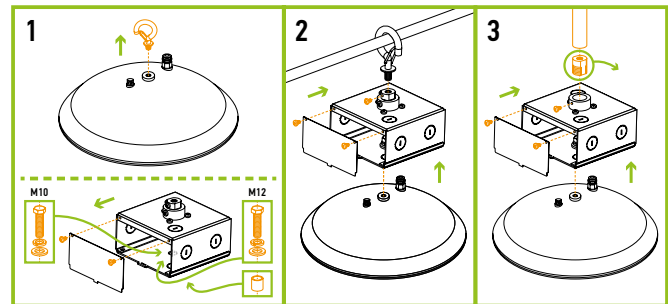

For most up-to-date spec sheets please refer to asd-lighting.com



LED NSF UFO HIGH BAY

BATTERY BACK-UP KIT INSTALLATION

BLD-RM40R **BLD-RM60R** sold separately:

1. Install the G-hook to the top thread hole of the battery back-up and secure with the screw. Attach the battery back-up with G-hook to the ceiling hook.
2. Loosen the screw on the enclosed hook on the bottom of the emergency back-up, attach the ring on the fixture to the hook and tighten screw back. Open the cover and remove the plastic covers and install the four waterproof connectors.
3. Pull all wires through the waterproof connectors into the chamber of emergency driver. Connect wires: Brown, Blue, Green with AC input wires of the fixture. Connect dimming wires Purple and Pink with LED driver input dimming wires. Connect Black, White and Red wires of the battery back-up with AC main Power cord. Secure connection with wire nuts and lock up the cover of junction box.

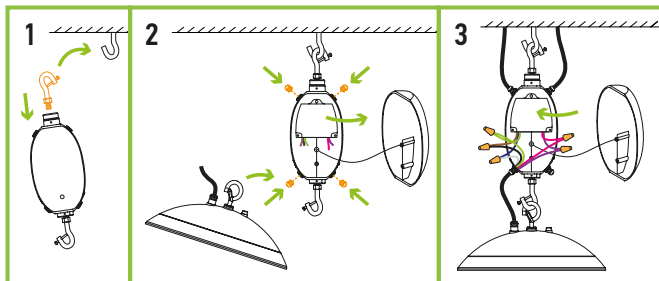

SMART BATTERY BACK-UP KIT INSTALLATION

ASD-EMA40-NLS sold separately:

1. Install the G-hook to the top thread hole of the battery back-up and secure with the screw. Attach the battery back-up with G-hook to the ceiling hook.
2. Loosen the screw on the enclosed hook on the bottom of the emergency back-up, attach the hooks on the fixture and battery and tighten screw back. Open the front cover of the emergency back-up, remove the plastic covers and install 2 waterproof connectors.
3. Pull all wires through the waterproof connectors into the chamber of emergency driver. Connect wires: Brown, Blue, Green with AC input wires of the fixture. Connect dimming wires Purple and Pink with LED driver input dimming wires. Connect Black, White and Red wires of the battery back-up with AC main Power cord. Secure connection with wire nuts and lock up the cover of junction box.

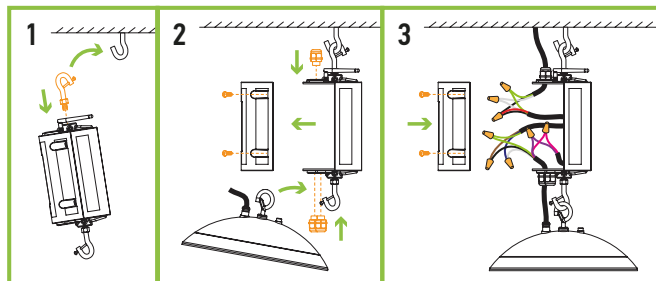

For most up-to-date spec sheets please refer to asd-lighting.com

ASD LIGHTING CORP

E-mail: orders@asd-lighting.com | Web site: www.asd-lighting.com

