



LED DOWNLIGHT WITH JUNCTION BOX

► **DESIGN & OPTIONS** - LED DOWNLIGHT WITH JUNCTION BOX has a classic, low-profile design with a baffle trim that allows you to have a stylish look with efficient lighting. Smooth dimming capabilities ranging from 100% to 10% with modern LED dimmers allow you to control the look and feel of your space. The 110° beam angle and CRI90+ grants you smooth and even lighting. It is also CCT adjustable, letting you set it to 2,700K, 3,000K, 3,500K, 4,000K or 5,000K with a simple switch.

► **INSTALLATION** - This fixture has an integrated J-box, making installation quick and easy. It has everything you need in one set. Just cut out the template, connect the J-box wiring on the back of the recessed downlight to your light switch, and place it into your ceiling. Spring-loaded clips ensure a snug fit to the surface. This fixture is IC rated so there is no can or any other housing required. Refer to install instructions for detailed steps.

► **APPLICATION** - Install the fixture to your ceiling for bright light in your family room, bedroom, hallway, corridor, or any other common area in your living space. It is suitable for Wet Locations, making it perfect for spaces with humidity requirements. It can also be used as a complimentary light to an existing ceiling light.

► **ENERGY SAVINGS & EFFICIENCY** - With a lifespan of 54,000 hours, these fixtures are made to last decades under normal operation! This fixture can cut your electric bill by up to 80% instantly and will save you a significant amount of money in its lifetime.

► **CERTIFICATION & WARRANTY** - Buy with confidence: ASD provides a 5-year limited warranty along with UL certification to guarantee top quality products and safety!

Energy Star classification allow participation in rebates; please check the rebate programs available in your state.

Catalog number	
Notes	
Type	



Model	Size	Watts	Voltage	Dimmable	Lumens	CCT	Finish	Dimensions (LxH)	Type
ASD-LDLOBR-4D10AC-WH	4 inch	10W	120 V	TRIAC	650/701/704/709/695 lm	5CCT (2,700/3,000/3,500/4,000/5,000 K)	White	5-1/16" x 3-1/8"	Round
ASD-LDLOBS-4D10AC-WH	4 inch	10W	120 V	TRIAC	650/688/688/699/722 lm	5CCT (2,700/3,000/3,500/4,000/5,000 K)	White	5" x 3-1/8"	Square
ASD-LDLOBR-6D15AC-WH	6 inch	15W	120 V	TRIAC	1,000/1,048/1,053/1,067/1,028 lm	5CCT (2,700/3,000/3,500/4,000/5,000 K)	White	7-5/16" x 3-1/4"	Round
ASD-LDLOBS-6D15AC-WH	6 inch	15W	120 V	TRIAC	1,000/1,024/1,061/1,072/1,085 lm	5CCT (2,700/3,000/3,500/4,000/5,000 K)	White	7-5/16" x 3-3/8"	Square

ORDERING INFORMATION

Model	UPC	Pcs. per carton	Carton size	Carton weight	GTIN 14
ASD-LDLOBR-4D10AC-WH	810050736657	12	11.2" x 10.4" x 11.2"	5.5 lb	10810050736654
ASD-LDLOBS-4D10AC-WH	810050736671	12	11.8" x 10.6" x 11"	8.2 lb	10810050736678
ASD-LDLOBR-6D15AC-WH	810050736664	12	15.7" x 10.8" x 15.7"	8.8 lb	10810050736661
ASD-LDLOBS-6D15AC-WH	810050736688	12	16.3" x 11" x 15.9"	11.5 lb	10810050736685

For most up-to-date spec sheets please refer to asd-lighting.com

ASD LIGHTING CORP

E-mail: orders@asd-lighting.com | Web site: www.asd-lighting.com





LED DOWNLIGHT WITH JUNCTION BOX

PRODUCT SPECIFICATIONS:

Construction & Materials					
Housing	Aluminum				
Lens	PC				
Finish color	White				
Weight	ASD-LDLOBR-4D10AC-WH	0.3 lb (0.1 kg)			
	ASD-LDLOBS-4D10AC-WH	0.5 lb (0.2 kg)			
	ASD-LDLOBR-6D15AC-WH	0.5 lb (0.2 kg)			
	ASD-LDLOBS-6D15AC-WH	0.7 lb (0.3 kg)			
Environmental system					
Work environment	Suitable for Wet Locations				
Operating temperature	-4°F to 104°F (-20°C to 40°C)				
L-70 Life	> 54,000 hrs				
Optical system					
Luminous flux	ASD-LDLOBR-4D10AC-WH	650/701/704/709/695 lm			
	ASD-LDLOBS-4D10AC-WH	650/688/688/699/722 lm			
	ASD-LDLOBR-6D15AC-WH	1,000/1,048/1,053/1,067/1,028 lm			
	ASD-LDLOBS-6D15AC-WH	1,000/1,024/1,061/1,072/1,085 lm			
Color temperature	5CCT (2,700/3,000/3,500/4,000/5,000 K)				
CRI	> 90				
Electrical system					
Input voltage	120 V				
Max input current	ASD-LDLOBR-4D10AC-WH	0.1 A			
	ASD-LDLOBS-4D10AC-WH	0.125 A			
	ASD-LDLOBR-6D15AC-WH	0.125 A			
	ASD-LDLOBS-6D15AC-WH	0.125 A			
Inrush current (Action time)	40 A (0.2 S)				
AC input range	min 108V max 132V				
Off state power	0W				
Power consumption	ASD-LDLOBR-4D10AC-WH	10W			
	ASD-LDLOBS-4D10AC-WH	15W			
	ASD-LDLOBR-6D15AC-WH	15W			
	ASD-LDLOBS-6D15AC-WH	15W			
Power factor	> 0.9				
Output voltage	ASD-LDLOBR-4D10AC-WH	135 V			
	ASD-LDLOBS-4D10AC-WH	120 V			
	ASD-LDLOBR-6D15AC-WH	120 V			
	ASD-LDLOBS-6D15AC-WH	120 V			
Max output current	ASD-LDLOBR-4D10AC-WH	65 mA			
	ASD-LDLOBS-4D10AC-WH	115 mA			
	ASD-LDLOBR-6D15AC-WH	115 mA			
	ASD-LDLOBS-6D15AC-WH	115 mA			
Surge protection DM/CM	2.5 kV / 2.5 kV				
LED driver class	Non-isolated				
Dimming range					
10-100%					
Dimming compatible controls					
Brand	Lutron	Leviton			
Models	DVVCL-153PH-LA	DVCL-163P-WH	DV-600P	DSL06-1TW	6683
	DVW-603PGH-WH	SCL-153PR-WH	NT-1000	DB33K1	6674
	CTCL-153PDH-WH	CTCL-150H-WH	S-603P	1A2305	6672
	MACL-153MR-WH	CT-600PR-WH	S-600P	6633-P	6631
	CTCL-153PDH-LA	CT-103PR-WH	4X603	IPL06	
	CTCL-153PR-WH	SLV-600P-WH			
MACL-153M-WH	DVVL-603P-IV				
Regular and voluntary certifications					
5-year limited warranty					
UL certified E473854					
Energy Star listed					

PACKAGE CONTENTS:

Description	Q-ty
LED Downlight with junction box	1
Wire nut (A)	3
Template for 4 inch or 6 inch (B)	1
Box	1

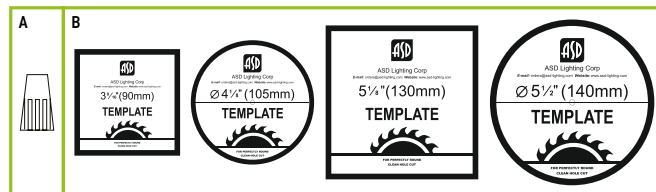

INSTALLATION GUIDE

IMPORTANT SAFETY INFORMATION:

Please read all the instructions below before installation.

- ▶ Make sure that the supply voltage corresponds to the rated product voltage.
- ▶ The product must be installed by a qualified electrician in accordance with the National Electrical Code and corresponding local codes.
- ▶ If the product is damaged, do not use it.

⚠ WARNING

RISK OF PERSONAL INJURY – READ and follow all WARNINGS and installation instructions. Keep or give to the owner for future reference.

Risk of cuts: Wear gloves to prevent cuts or abrasions when removing from carton, handling, installing, and maintaining this product.

Risk of electric shock: This product must be installed in accordance with the applicable installation code by a person familiar with the construction and operation of the product and the hazards involved.

Risk of Fire: Minimum 194°F supply conductors. Consult a qualified electrician to ensure correct branch circuit conductor.

ASD® assumes no responsibility for claims arising out of improper or careless installation or handling of this product.

ELECTRICAL SCHEMATIC DIAGRAM:

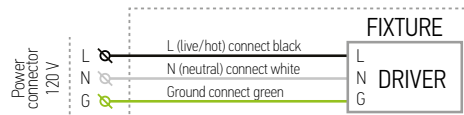

INSTALLATION STEPS:

1. Use template to cut an appropriate sized hole.
2. Choose preferred color temperature by adjusting the switch. Open the junction box. Connect the wires: Black to Black, White to White, Green to Green. Secure the connection with wire nuts. Tuck all the wires back into junction box and close it.
3. Push the spring loaded clips upwards and insert the fixture base into the mounting hole. Release the clips and the fixture will be "pulled" into place against the ceiling. Once assembly is complete, turn the power on to ensure the fixture is operating properly.

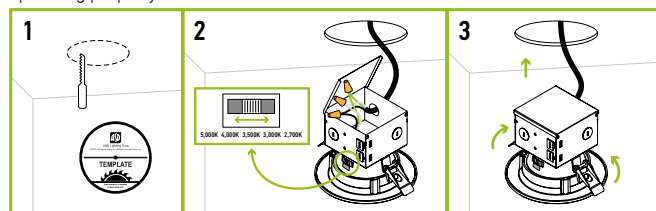

For most up-to-date spec sheets please refer to asd-lighting.com