



LED ROUND OUTDOOR WALL CYLINDER WITH RGBW

► **DESIGN** - LED ROUND OUTDOOR WALL CYLINDER WITH RGBW has a modern design with effective up and down illumination. Elegant matte rings add premium appearance.

► **RGBW** - The fixture has RGBW design with APP control. You can easily select Red, Green, Blue, White (2,700K-6,500K) colors or its' combinations, having 16.7 million colors in total. You can also choose lighting patterns and set up a schedule, having a great variety of good looking effects. All of it is easily controlled by Smart APP on your Smartphone. The fixture is also compatible with Alexa and Google Assistant.

► **DURABLE WATERPROOF HOUSING** - resistant to rust and can be used indoors and outdoors for all weather conditions.

► **APPLICATION** - The fixture is rated for Wet Locations, making it perfect for indoor and outdoor projects such as decks, front doors, porches, patios, corridors, walkways, or any other common areas.

► **ADVANTAGES** - With calculated lifespan with more than 50,000 hours, these fixtures are made to last decades under normal operation! ASD provides a 5-year limited warranty along with ETL certification to guarantee top quality products and safety!

Catalog number	
Notes	
Type	



Model	Light direction	Watts	Voltage	Dimmable	Lumens	CCT	Finish	Dimensions (LxWxH)
ASD-LCLR2-30SM-RGBW-BK	2	30W	120 V	SMART APP	870/889/915/919/912 lm	2,700-6,500 K	Black	4-15/16" x 6-1/16" x 12-1/8"

ORDERING INFORMATION

Model	UPC	Pcs. per carton	Carton size	Carton weight	GTIN 14
ASD-LCLR2-30SM-RGBW-BK	810128114738	2	11" x 7.5" x 14.2"	7.5 lbs	20810128114732

For most up-to-date spec sheets please refer to asd-lighting.com



LED ROUND OUTDOOR WALL CYLINDER WITH RGBW

PRODUCT SPECIFICATIONS:

Construction & Materials	
Housing	Aluminum
Lens	Acrylic
Finish	Black
Weight	2.8 lbs (1.3 kg)
Environmental system	
Work environment	Suitable for Wet Locations
Operating temperature	-40°F to 113°F (-40°C to 45°C)
L-70 Life	> 50,000 hrs
Optical system	
Luminous flux	870/889/915/919/912 lm
Color temperature	from 2,700 to 6,500 K with smart app
CRI	> 80
Electrical system	
Input voltage	120 V
Max input current	0.27 A
Inrush current (Action time)	0.25 A (0.1 S)
Off state power	0W
Power consumption	30W
Power factor	> 0.9
Output voltage	24 V
Max output current	1.06 A
Surge protection DM/CM	2.5 kV / 1.25 kV
Regular and voluntary certifications	
5-year limited warranty	
cETLus certified	

PACKAGE CONTENTS:

Description	Q-ty
LED Round Outdoor Wall Cylinder with RGBW	1
Mounting plate (A)	1
Mounting screw (B)	2
Outlet box screw (C)	2
Wire nut (D)	3
Box	1

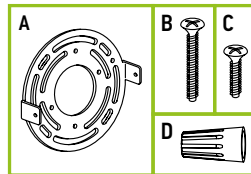

ASD SMART APP DOWNLOAD:

Android



iOS



INSTALLATION GUIDE

IMPORTANT SAFETY INFORMATION:

Please read all the instructions below before installation.

- ▶ Make sure that the supply voltage corresponds to the rated product voltage.
- ▶ The product must be installed by a qualified electrician in accordance with the National Electrical Code and corresponding local codes.
- ▶ If the product is damaged, do not use it.

⚠ WARNING

RISK OF PERSONAL INJURY – READ and follow all WARNINGS and installation instructions. Keep or give to the owner for future reference.

Risk of cuts: Wear gloves to prevent cuts or abrasions when removing from carton, handling, installing, and maintaining this product.

Risk of electric shock: This product must be installed in accordance with the applicable installation code by a person familiar with the construction and operation of the product and the hazards involved.

Risk of Fire: Minimum 194°F supply conductors. Consult a qualified electrician to ensure correct branch circuit conductor.

ASD® assumes no responsibility for claims arising out of improper or careless Installation or handling of this product.

ELECTRICAL SCHEMATIC DIAGRAM:

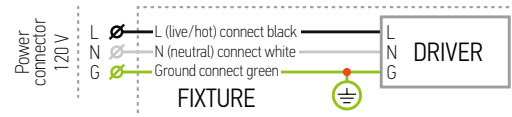

INSTALLATION STEPS:

1. Screw the two mounting screws onto the mounting plate. Attach the mounting plate to the outlet box using screws. Make sure the threads of the mounting screws are facing outside when the mounting plate is attached to the outlet box.
2. Connect the wires: Black to Black, White to White, Ground to Ground. Secure the connection with wire nuts. Place the fixture base on the wall by aligning the protruding mounting screws through the holes on the wall plate. Tighten the fixture to the wall using two decorative nuts. For outdoor locations please use silicone (not included) shown in the picture below.
3. Download ASD SMART APP using QR codes and add the fixture to it according to the manual.

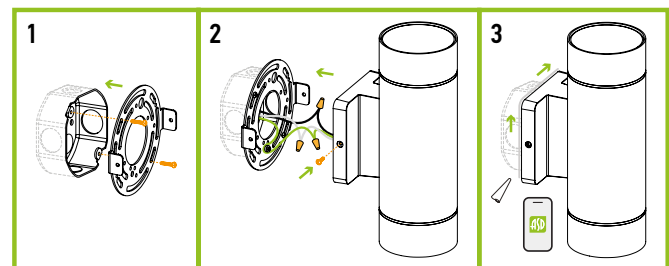

* please see manual by [link](#) or QR-code below



For most up-to-date spec sheets please refer to asd-lighting.com