



# LED STRIPLIGHT FIXTURE

► **DESIGN & OPTIONS** - LED STRIPLIGHT FIXTURES are equipped with a dip switch that allows you to adjust the CCT and wattage. The CCT options are 3,500K, 4,000K or 5,000K and the wattage can be set to 35W, 40W or 45W. They come in a 4ft size with a narrow, low-profile design. They also feature a smooth PMMA lens for even illumination with no glare, a durable galvanized metal construction with knock outs on both ends, and a 0-10V dimmable driver at 120-277V.

► **INSTALLATION** - Installation is easy: all you have to do is snap together the housing and the lens. Side and end entry points make it easy to connect multiple fixtures to one switch using our connection bracket (sold separately). It can be surface mounted or suspended. Refer to install instructions for detailed steps.

► **APPLICATION** - This LED STRIPLIGHT FIXTURE is perfect for commercial or industrial locations such as: office buildings, schools, hospitals, hallways, stairwells, basements, workshops, laundry rooms, garages, and storage areas just to name a few. The fixture is Damp location rated and can operate in temperatures between -4 to 122°F (-20 to 50°C), allowing it to be utilized in a wide variety of applications and climates.

► **ENERGY SAVINGS & EFFICIENCY** - With a calculated lifespan up to 177,000 hours, these fixtures are made to last decades under normal operation! This fixture can cut your electric bill by up to 80% instantly and will save you a significant amount of money in its lifetime.

► **CERTIFICATION & WARRANTY** - Buy with confidence: ASD provides a 5-year limited warranty along with UL certification to guarantee top quality products and safety!  
DLC Standard classification allows participation in rebates; please check the rebate programs available in your state.

Catalog number	
Notes	
Type	



Model	Type	Watts	Voltage	Dimmable	Lumens	CCT	Dimensions (LxWxH)	Cord
ASD-LSF3-4A45AC	4 ft	35/40/45W	120-277 V	0-10 V	4,801/5,153/6,102 lm	3CCT (3,500/4,000/5,000 K)	47-5/16" x 2-3/8" x 2-5/8"	1.5 ft

## PRODUCT SPECIFICATIONS:

Construction & Materials		Electrical system	
Housing	Galvanized metal	Input voltage	120-277 V
Lens	PMMA	Max input current	1 A
Finish color	White	Inrush current (Action time)	50 A (1 S)
Weight	3.7 lb (1.7 kg)	AC input range	min 108 V max 305 V
<b>Environmental system</b>		Off state power	0W
Work environment	Suitable for Damp Locations, IP20	Power consumption	35/40/45W
Operating temperature	-4°F to 122°F (-20°C to 50°C)	Power factor	> 0.9
L-70 Life	R > 54,000 hrs; C > 177,000 hrs	Output voltage	24-40 V
<b>Optical system</b>		Max output current	1 A/850 mA/750 mA
Luminous Flux	4,801/5,153/6,102 lm	Surge protection	2.5 kV
Color Temperature	3CCT (3,500/4,000/5,000 K)	LED driver class	Class P
CRI	> 80		
<b>Dimming compatible controls</b>			
Brand	Eaton	Lutron	Cooper
Models	SF10P DF10P	DIVA DVSTV	ARROW HART
<b>Regular and voluntary certifications</b>			
5-year limited warranty			
DesignLights Consortium (DLC) listed (Classification: Standard series)			
Main: Indoor Luminaires; General Application: Linear Ambient			
Primary Use: Direct Linear Ambient Luminaires			
UL certified E473804			

## PACKAGE CONTENTS:

Description	Q-ty
LED Striplight Fixture	1
SMK-stents (A)	2
J-box mounting plate (B)	2
V Hook (C)	2
Screw (D)	6
Expansion screw (E)	2
Box	1

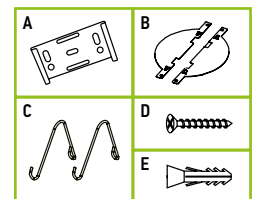

For most up-to-date spec sheets please refer to [asd-lighting.com](http://asd-lighting.com)



# LED STRIPLIGHT FIXTURE

## INSTALLATION GUIDE

### IMPORTANT SAFETY INFORMATION:

Please read all the instructions below before installation.

- ▶ Make sure that the supply voltage corresponds to the rated product voltage.
- ▶ The product must be installed by a qualified electrician in accordance with the National Electrical Code and corresponding local codes.
- ▶ If the product is damaged, do not use it.

### ⚠ WARNING

**RISK OF PERSONAL INJURY – READ and follow all WARNINGS and installation instructions.** Keep or give to the owner for future reference.

**Risk of cuts:** Wear gloves to prevent cuts or abrasions when removing from carton, handling, installing, and maintaining this product.

**Risk of electric shock:** This product must be installed in accordance with the applicable installation code by a person familiar with the construction and operation of the product and the hazards involved.

**Risk of Fire:** Minimum 194°F supply conductors. Consult a qualified electrician to ensure correct branch circuit conductor.

ASD® assumes no responsibility for claims arising out of improper or careless installation or handling of this product.

### ELECTRICAL SCHEMATIC DIAGRAM:

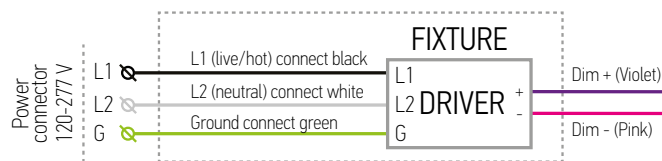

Multiple fixtures with different sizes and wattages can be linked together, the total wattage must not exceed 750W (120 V)/1750W (277 V).

Recommended wire thickness should not exceed 18AWG.

### CHANGING COLOR TEMPERATURE:

Change the position of the CT switch on the housing according to the required CT mode.

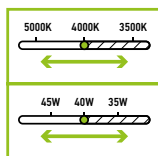

### CHANGING POWER MODE:

During installation, select the required preset wattage. Do not remove the knock-out cover panel that limits the access of authorized personnel. Power options depends on model.

### ACCESSORIES (sold separately):

#### Connection bracket

ASD-CB-LSF3

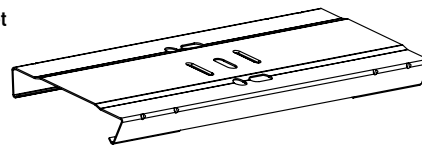

### CHAIN SUSPENDED MOUNTING:

1. Clip the brackets to the slots of fixture.
2. Attach V-hooks to the bracket.
3. Attach chain (not included) to the V-hooks and fix chain in the mounting surface.

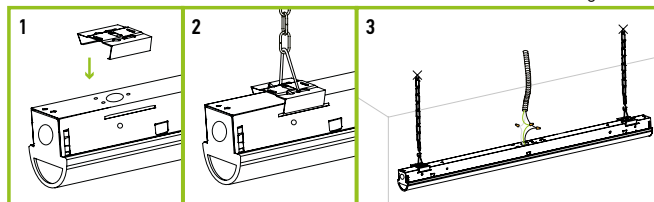

### SURFACE MOUNTING:

1. Secure the brackets onto the ceiling by screws.
2. Fix the covers at the outlet on the back of the housing. Connect the wires: Black to Black, White to White, Green to Green.
3. Clip the brackets to the slots of fixture.

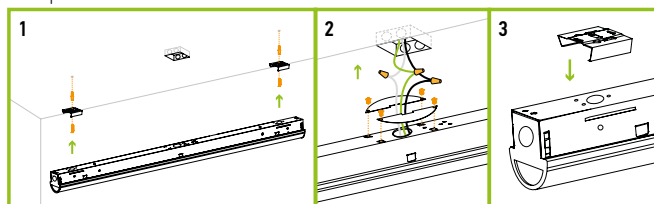

## ORDERING INFORMATION

Model	UPC	Pcs. per carton	Carton size	Carton weight	GTIN 14
ASD-LSF3-4A45AC	810050735025	9	49" x 8.4" x 9.7"	45.6 lbs	10810050735022

### ACCESSORIES:

Model	Name	UPC	Pcs. in middle box	Middle box size	Middle box weight	GTIN 14 in middle box	Pcs. per carton	Carton size	Carton weight	GTIN 14 in carton
ASD-CB-LSF3	Connection bracket	810050735049	25	7.4" x 7.4" x 2.4"	13.2 lb	10810050735046	100	8.7" x 7.3" x 10.9"	55.1 lbs	20810050735043

For most up-to-date spec sheets please refer to [asd-lighting.com](http://asd-lighting.com)