



LED RECESSED MINI PANEL

► **DESIGN** - LED RECESSED MINI PANEL with a classic, low-profile design is an ideal solution for low ceilings. This fixture has a J-box, plug & twist connector, spring-loaded clips, and requires only 2" of ceiling space, making the installation process quick and easy. The acrylic lens with a 110° beam angle and CRI90+ grants you even light. It is designed to operate on 120V circuits.

► **COLOR SELECTABLE** - You can choose either a 2,700K soft white, 3,000K warm white, 3,500K neutral white, 4,000K cool white, or 5,000K daylight color temperature.

► **DIMMING** - Smooth triac dimming capabilities ranging from 10% to 100% with modern LED dimmers allow you to control the look and feel of your space.

► **INSTALLATION** - This fixture is IC rated so there is no can or any other housing required. It is also Wet Locations rated, making it perfect for kitchen, bathroom or any other common areas.

► **ADVANTAGES** - With a lifespan of 54,000 hours, these fixtures are made to last decades under normal operation! ASD provides a 5-year limited warranty along with UL and Energy Star certifications to guarantee top quality products and safety!

| | |
|----------------|--|
| Catalog number | |
| Notes | |
| Type | |



| | | |
|---------|--------|--------|
| Finish: | White | Bronze |
| | Nickel | Black |

| Model | Size | Watts | Voltage | Dimmable | Lumens | CCT | Finish | Dimensions | Type |
|--------------------------|---------|-------|---------|----------|----------------------------------|----------------------------------------|----------------|-----------------------------|--------|
| JBR ROUND | | | | | | | | | |
| ASD-JBR-3D6AC-WH-6PACK | 3 inch | 6W | 120 V | TRIAC | 420/445/460/455/436 lm | 5CCT (2,700/3,000/3,500/4,000/5,000 K) | White | 3-1/4" x 5/8" | Round |
| ASD-JBR-3D6AC-NK-6PACK | 3 inch | 6W | 120 V | TRIAC | 420/445/460/455/436 lm | 5CCT (2,700/3,000/3,500/4,000/5,000 K) | Brushed nickel | 3-1/4" x 5/8" | Round |
| ASD-JBR-3D6AC-BZ-6PACK | 3 inch | 6W | 120 V | TRIAC | 420/445/460/455/436 lm | 5CCT (2,700/3,000/3,500/4,000/5,000 K) | Bronze | 3-1/4" x 5/8" | Round |
| ASD-JBR-3D6AC-BK-6PACK | 3 inch | 6W | 120 V | TRIAC | 420/445/460/455/436 lm | 5CCT (2,700/3,000/3,500/4,000/5,000 K) | Black | 3-1/4" x 5/8" | Round |
| ASD-JBR-4D12AC-WH-6PACK | 4 inch | 12W | 120 V | TRIAC | 780/839/893/861/860 lm | 5CCT (2,700/3,000/3,500/4,000/5,000 K) | White | 4-11/16" x 5/8" | Round |
| ASD-JBR-4D12AC-WH-12PACK | 4 inch | 12W | 120 V | TRIAC | 780/839/893/861/860 lm | 5CCT (2,700/3,000/3,500/4,000/5,000 K) | White | 4-11/16" x 5/8" | Round |
| ASD-JBR-4D12AC-NK-6PACK | 4 inch | 12W | 120 V | TRIAC | 780/839/893/861/860 lm | 5CCT (2,700/3,000/3,500/4,000/5,000 K) | Brushed nickel | 4-11/16" x 5/8" | Round |
| ASD-JBR-4D12AC-BZ-6PACK | 4 inch | 12W | 120 V | TRIAC | 780/839/893/861/860 lm | 5CCT (2,700/3,000/3,500/4,000/5,000 K) | Bronze | 4-11/16" x 5/8" | Round |
| ASD-JBR-4D12AC-BK-6PACK | 4 inch | 12W | 120 V | TRIAC | 780/839/893/861/860 lm | 5CCT (2,700/3,000/3,500/4,000/5,000 K) | Black | 4-11/16" x 5/8" | Round |
| ASD-JBR-6D15AC-WH-6PACK | 6 inch | 15W | 120 V | TRIAC | 1,100/1,137/1,225/1,153/1,094 lm | 5CCT (2,700/3,000/3,500/4,000/5,000 K) | White | 6-5/8" x 5/8" | Round |
| ASD-JBR-6D15AC-WH-12PACK | 6 inch | 15W | 120 V | TRIAC | 1,100/1,137/1,225/1,153/1,094 lm | 5CCT (2,700/3,000/3,500/4,000/5,000 K) | White | 6-5/8" x 5/8" | Round |
| ASD-JBR-6D15AC-NK-6PACK | 6 inch | 15W | 120 V | TRIAC | 1,100/1,137/1,225/1,153/1,094 lm | 5CCT (2,700/3,000/3,500/4,000/5,000 K) | Brushed nickel | 6-5/8" x 5/8" | Round |
| ASD-JBR-6D15AC-BZ-6PACK | 6 inch | 15W | 120 V | TRIAC | 1,100/1,137/1,225/1,153/1,094 lm | 5CCT (2,700/3,000/3,500/4,000/5,000 K) | Bronze | 6-5/8" x 5/8" | Round |
| ASD-JBR-6D15AC-BK-6PACK | 6 inch | 15W | 120 V | TRIAC | 1,100/1,137/1,225/1,153/1,094 lm | 5CCT (2,700/3,000/3,500/4,000/5,000 K) | Black | 6-5/8" x 5/8" | Round |
| ASD-JBR-8D20AC-WH | 8 inch | 20W | 120 V | TRIAC | 1,600/1,650/1,688/1,746/1,633 lm | 5CCT (2,700/3,000/3,500/4,000/5,000 K) | White | 8-11/16" x 5/8" | Round |
| ASD-JBR-8D20AC-BK | 8 inch | 20W | 120 V | TRIAC | 1,600/1,650/1,688/1,746/1,633 lm | 5CCT (2,700/3,000/3,500/4,000/5,000 K) | Black | 8-11/16" x 5/8" | Round |
| ASD-JBR-12D24AC-WH | 12 inch | 24W | 120 V | TRIAC | 1,950/2,142/2,138/2,169/2,077 lm | 5CCT (2,700/3,000/3,500/4,000/5,000 K) | White | 11-5/8" x 5/8" | Round |
| ASD-JBR-12D24AC-BK | 12 inch | 24W | 120 V | TRIAC | 1,950/2,142/2,138/2,169/2,077 lm | 5CCT (2,700/3,000/3,500/4,000/5,000 K) | Black | 11-5/8" x 5/8" | Round |
| JBS SQUARE | | | | | | | | | |
| ASD-JBS-3D6AC-WH-6PACK | 3 inch | 6W | 120 V | TRIAC | 420/442/456/445/430 lm | 5CCT (2,700/3,000/3,500/4,000/5,000 K) | White | 3-1/4" x 3-1/4" x 9/16" | Square |
| ASD-JBS-3D6AC-NK-6PACK | 3 inch | 6W | 120 V | TRIAC | 420/442/456/445/430 lm | 5CCT (2,700/3,000/3,500/4,000/5,000 K) | Brushed nickel | 3-1/4" x 3-1/4" x 9/16" | Square |
| ASD-JBS-3D6AC-BZ-6PACK | 3 inch | 6W | 120 V | TRIAC | 420/442/456/445/430 lm | 5CCT (2,700/3,000/3,500/4,000/5,000 K) | Bronze | 3-1/4" x 3-1/4" x 9/16" | Square |
| ASD-JBS-3D6AC-BK-6PACK | 3 inch | 6W | 120 V | TRIAC | 420/442/456/445/430 lm | 5CCT (2,700/3,000/3,500/4,000/5,000 K) | Black | 3-1/4" x 3-1/4" x 9/16" | Square |
| ASD-JBS-4D12AC-WH-6PACK | 4 inch | 12W | 120 V | TRIAC | 750/767/736/784/750 lm | 5CCT (2,700/3,000/3,500/4,000/5,000 K) | White | 4-5/8" x 4-5/8" x 9/16" | Square |
| ASD-JBS-4D12AC-NK-6PACK | 4 inch | 12W | 120 V | TRIAC | 750/767/736/784/750 lm | 5CCT (2,700/3,000/3,500/4,000/5,000 K) | Brushed nickel | 4-5/8" x 4-5/8" x 9/16" | Square |
| ASD-JBS-4D12AC-BZ-6PACK | 4 inch | 12W | 120 V | TRIAC | 750/767/736/784/750 lm | 5CCT (2,700/3,000/3,500/4,000/5,000 K) | Bronze | 4-5/8" x 4-5/8" x 9/16" | Square |
| ASD-JBS-4D12AC-BK-6PACK | 4 inch | 12W | 120 V | TRIAC | 750/767/736/784/750 lm | 5CCT (2,700/3,000/3,500/4,000/5,000 K) | Black | 4-5/8" x 4-5/8" x 9/16" | Square |
| ASD-JBS-6D15AC-WH-6PACK | 6 inch | 15W | 120 V | TRIAC | 1,050/1,117/1,197/1,144/1,095 lm | 5CCT (2,700/3,000/3,500/4,000/5,000 K) | White | 6-9/16" x 6-9/16" x 9/16" | Square |
| ASD-JBS-6D15AC-NK-6PACK | 6 inch | 15W | 120 V | TRIAC | 1,050/1,117/1,197/1,144/1,095 lm | 5CCT (2,700/3,000/3,500/4,000/5,000 K) | Brushed nickel | 6-9/16" x 6-9/16" x 9/16" | Square |
| ASD-JBS-6D15AC-BZ-6PACK | 6 inch | 15W | 120 V | TRIAC | 1,050/1,117/1,197/1,144/1,095 lm | 5CCT (2,700/3,000/3,500/4,000/5,000 K) | Bronze | 6-9/16" x 6-9/16" x 9/16" | Square |
| ASD-JBS-6D15AC-BK-6PACK | 6 inch | 15W | 120 V | TRIAC | 1,050/1,117/1,197/1,144/1,095 lm | 5CCT (2,700/3,000/3,500/4,000/5,000 K) | Black | 6-9/16" x 6-9/16" x 9/16" | Square |
| ASD-JBS-8D20AC-WH | 8 inch | 20W | 120 V | TRIAC | 1,550/1,694/1,743/1,721/1,654 lm | 5CCT (2,700/3,000/3,500/4,000/5,000 K) | White | 8-11/16" x 8-11/16" x 9/16" | Square |
| ASD-JBS-8D20AC-BK | 8 inch | 20W | 120 V | TRIAC | 1,550/1,694/1,743/1,721/1,654 lm | 5CCT (2,700/3,000/3,500/4,000/5,000 K) | Black | 8-11/16" x 8-11/16" x 9/16" | Square |
| ASD-JBS-12D24AC-WH | 12 inch | 24W | 120 V | TRIAC | 1,900/1,932/2,018/2,006/2,152 lm | 5CCT (2,700/3,000/3,500/4,000/5,000 K) | White | 11-9/16" x 11-9/16" x 9/16" | Square |
| ASD-JBS-12D24AC-BK | 12 inch | 24W | 120 V | TRIAC | 1,900/1,932/2,018/2,006/2,152 lm | 5CCT (2,700/3,000/3,500/4,000/5,000 K) | Black | 11-9/16" x 11-9/16" x 9/16" | Square |

For most up-to-date spec sheets please refer to asd-lighting.com



LED RECESSED MINI PANEL

PRODUCT SPECIFICATIONS:

| Construction & Materials | | | | |
|--------------------------|-------------------------------------------------------------------|----------------------------------|-------------------------|----------------------------------|
| Housing | Aluminum | | | |
| Lens | PC | | | |
| Finish | White, Brushed nickel, Bronze, Black | | | |
| Weight | ASD-JBR-3D6AC-WH-6PACK | 2.2 lbs (1 kg) | ASD-JBR-12D24AC-BK | 1.5 lbs (0.7 kg) |
| | ASD-JBR-3D6AC-NK-6PACK | | ASD-JBS-3D6AC-WH-6PACK | 2.6 lbs (1.2 kg) |
| | ASD-JBR-3D6AC-BZ-6PACK | ASD-JBS-3D6AC-NK-6PACK | | |
| | ASD-JBR-3D6AC-BK-6PACK | ASD-JBS-3D6AC-BZ-6PACK | | |
| | ASD-JBR-4D12AC-WH-6PACK | 3.7 lbs (1.7 kg) | ASD-JBS-3D6AC-BK-6PACK | 3.7 lbs (1.7 kg) |
| | ASD-JBR-4D12AC-WH-12PACK | 7.7 lbs (3.5 kg) | ASD-JBS-4D12AC-WH-6PACK | |
| | ASD-JBR-4D12AC-NK-6PACK | 3.7 lbs (1.7 kg) | ASD-JBS-4D12AC-NK-6PACK | |
| | ASD-JBR-4D12AC-BZ-6PACK | | ASD-JBS-4D12AC-BZ-6PACK | |
| | ASD-JBR-4D12AC-BK-6PACK | 4.4 lbs (2 kg) | ASD-JBS-4D12AC-BK-6PACK | 5 lbs (2.3 kg) |
| | ASD-JBR-6D15AC-WH-6PACK | | ASD-JBS-6D15AC-WH-6PACK | |
| | ASD-JBR-6D15AC-WH-12PACK | 9.3 lbs (4.2 kg) | ASD-JBS-6D15AC-NK-6PACK | |
| | ASD-JBR-6D15AC-NK-6PACK | 4.4 lbs (2 kg) | ASD-JBS-6D15AC-BZ-6PACK | |
| | ASD-JBR-6D15AC-BZ-6PACK | | ASD-JBS-6D15AC-BK-6PACK | |
| | ASD-JBR-6D15AC-BK-6PACK | | ASD-JBS-8D20AC-WH | 1.1 lbs (0.5 kg) |
| | ASD-JBR-8D20AC-WH | 1.1 lbs (0.5 kg) | ASD-JBS-8D20AC-BK | 1.8 lbs (0.8 kg) |
| | ASD-JBR-8D20AC-BK | | ASD-JBS-12D24AC-WH | |
| ASD-JBR-12D24AC-WH | 1.5 lbs (0.7 kg) | ASD-JBS-12D24AC-BK | | |
| Environmental system | | | | |
| Work environment | Suitable for Wet Locations | | | |
| Operating temperature | -4°F to 104°F (-20°C to 40°C) | | | |
| L-70 Life | > 54,000 hrs | | | |
| Optical system | | | | |
| Luminous flux | ASD-JBR-3D6AC-WH-6PACK | 420/445/460/455/436 lm | ASD-JBR-12D24AC-BK | 1,950/2,142/2,138/2,169/2,077 lm |
| | ASD-JBR-3D6AC-NK-6PACK | | ASD-JBS-3D6AC-WH-6PACK | 420/442/456/445/430 lm |
| | ASD-JBR-3D6AC-BZ-6PACK | | ASD-JBS-3D6AC-NK-6PACK | |
| | ASD-JBR-3D6AC-BK-6PACK | ASD-JBS-3D6AC-BZ-6PACK | | |
| | ASD-JBR-4D12AC-WH-6PACK | 780/839/893/861/860 lm | ASD-JBS-3D6AC-BK-6PACK | 750/767/736/784/750 lm |
| | ASD-JBR-4D12AC-WH-12PACK | | ASD-JBS-4D12AC-WH-6PACK | |
| | ASD-JBR-4D12AC-NK-6PACK | | ASD-JBS-4D12AC-NK-6PACK | |
| | ASD-JBR-4D12AC-BZ-6PACK | | ASD-JBS-4D12AC-BZ-6PACK | |
| | ASD-JBR-4D12AC-BK-6PACK | 1,100/1,137/1,225/1,153/1,094 lm | ASD-JBS-4D12AC-BK-6PACK | 1,050/1,117/1,197/1,144/1,095 lm |
| | ASD-JBR-6D15AC-WH-6PACK | | ASD-JBS-6D15AC-WH-6PACK | |
| | ASD-JBR-6D15AC-WH-12PACK | | ASD-JBS-6D15AC-NK-6PACK | |
| | ASD-JBR-6D15AC-NK-6PACK | 1,600/1,650/1,688/1,746/1,633 lm | ASD-JBS-6D15AC-BZ-6PACK | 1,550/1,694/1,743/1,721/1,654 lm |
| | ASD-JBR-6D15AC-BZ-6PACK | | ASD-JBS-6D15AC-BK-6PACK | |
| | ASD-JBR-6D15AC-BK-6PACK | 1,950/2,142/2,138/2,169/2,077 lm | ASD-JBS-8D20AC-WH | 1,900/1,932/2,018/2,006/2,152 lm |
| | ASD-JBR-8D20AC-WH | | ASD-JBS-8D20AC-BK | |
| | ASD-JBR-8D20AC-BK | 1,950/2,142/2,138/2,169/2,077 lm | ASD-JBS-12D24AC-WH | |
| ASD-JBR-12D24AC-WH | ASD-JBS-12D24AC-BK | | | |
| Color temperature | 5CCT switch (2,700/3,000/3,500/4,000/5,000 K), 3,000 K by default | | | |
| CRI | > 90 | | | |
| Electrical system | | | | |
| Input voltage | 120 V | | | |
| Max input current | ASD-JBR-3D6AC-WH-6PACK | 0.07 A | ASD-JBR-12D24AC-BK | 0.27 A |
| | ASD-JBR-3D6AC-NK-6PACK | | ASD-JBS-3D6AC-WH-6PACK | 0.07 A |
| | ASD-JBR-3D6AC-BZ-6PACK | ASD-JBS-3D6AC-NK-6PACK | | |
| | ASD-JBR-3D6AC-BK-6PACK | ASD-JBS-3D6AC-BZ-6PACK | | |
| | ASD-JBR-4D12AC-WH-6PACK | 0.14 A | ASD-JBS-3D6AC-BK-6PACK | 0.14 A |
| | ASD-JBR-4D12AC-WH-12PACK | | ASD-JBS-4D12AC-WH-6PACK | |
| | ASD-JBR-4D12AC-NK-6PACK | | ASD-JBS-4D12AC-NK-6PACK | |
| | ASD-JBR-4D12AC-BZ-6PACK | | ASD-JBS-4D12AC-BZ-6PACK | |
| | ASD-JBR-4D12AC-BK-6PACK | 0.17 A | ASD-JBS-4D12AC-BK-6PACK | 0.17 A |
| | ASD-JBR-6D15AC-WH-6PACK | | ASD-JBS-6D15AC-WH-6PACK | |
| | ASD-JBR-6D15AC-WH-12PACK | | ASD-JBS-6D15AC-NK-6PACK | |
| | ASD-JBR-6D15AC-NK-6PACK | 0.23 A | ASD-JBS-6D15AC-BZ-6PACK | 0.23 A |
| | ASD-JBR-6D15AC-BZ-6PACK | | ASD-JBS-6D15AC-BK-6PACK | |
| | ASD-JBR-6D15AC-BK-6PACK | 0.23 A | ASD-JBS-8D20AC-WH | 0.27 A |
| | ASD-JBR-8D20AC-WH | | ASD-JBS-8D20AC-BK | |
| | ASD-JBR-8D20AC-BK | 0.27 A | ASD-JBS-12D24AC-WH | |
| ASD-JBR-12D24AC-WH | ASD-JBS-12D24AC-BK | | | |

For most up-to-date spec sheets please refer to asd-lighting.com



LED RECESSED MINI PANEL

| Electrical system | | | | | | | | | |
|------------------------------------|--------------------------|------------------------|-------------------------|---------------|--------|---------|--------|------|--|
| Inrush current (Action time) | ASD-JBR-3D6AC-WH-6PACK | 16 A (0.16 S) | ASD-JBR-12D24AC-BK | 41 A (0.18 S) | | | | | |
| | ASD-JBR-3D6AC-NK-6PACK | | ASD-JBS-3D6AC-WH-6PACK | 16 A (0.16 S) | | | | | |
| | ASD-JBR-3D6AC-BZ-6PACK | | ASD-JBS-3D6AC-NK-6PACK | | | | | | |
| | ASD-JBR-3D6AC-BK-6PACK | ASD-JBS-3D6AC-BZ-6PACK | | | | | | | |
| | ASD-JBR-4D12AC-WH-6PACK | 23 A (0.16 S) | ASD-JBS-3D6AC-BK-6PACK | 23 A (0.16 S) | | | | | |
| | ASD-JBR-4D12AC-WH-12PACK | | ASD-JBS-4D12AC-WH-6PACK | | | | | | |
| | ASD-JBR-4D12AC-NK-6PACK | | ASD-JBS-4D12AC-NK-6PACK | | | | | | |
| | ASD-JBR-4D12AC-BZ-6PACK | 29 A (0.18 S) | ASD-JBS-4D12AC-BZ-6PACK | 29 A (0.18 S) | | | | | |
| | ASD-JBR-4D12AC-BK-6PACK | | ASD-JBS-4D12AC-BK-6PACK | | | | | | |
| | ASD-JBR-6D15AC-WH-6PACK | | ASD-JBS-6D15AC-WH-6PACK | | | | | | |
| | ASD-JBR-6D15AC-WH-12PACK | 29 A (0.18 S) | ASD-JBS-6D15AC-NK-6PACK | 29 A (0.18 S) | | | | | |
| | ASD-JBR-6D15AC-NK-6PACK | | ASD-JBS-6D15AC-BZ-6PACK | | | | | | |
| | ASD-JBR-6D15AC-BZ-6PACK | | ASD-JBS-6D15AC-BK-6PACK | | | | | | |
| | ASD-JBR-6D15AC-BK-6PACK | 39 A (0.18 S) | ASD-JBS-8D20AC-WH | 39 A (0.18 S) | | | | | |
| | ASD-JBR-8D20AC-WH | | ASD-JBS-8D20AC-BK | | | | | | |
| | ASD-JBR-8D20AC-BK | | ASD-JBS-12D24AC-WH | | | | | | |
| ASD-JBR-12D24AC-WH | 41 A (0.18 S) | ASD-JBS-12D24AC-BK | 41 A (0.18 S) | | | | | | |
| Off state power | 0W | | | | | | | | |
| Power consumption | ASD-JBR-3D6AC-WH-6PACK | 6W | ASD-JBR-12D24AC-BK | 24W | | | | | |
| | ASD-JBR-3D6AC-NK-6PACK | | ASD-JBS-3D6AC-WH-6PACK | 6W | | | | | |
| | ASD-JBR-3D6AC-BZ-6PACK | | ASD-JBS-3D6AC-NK-6PACK | | | | | | |
| | ASD-JBR-3D6AC-BK-6PACK | ASD-JBS-3D6AC-BZ-6PACK | | | | | | | |
| | ASD-JBR-4D12AC-WH-6PACK | 12W | ASD-JBS-3D6AC-BK-6PACK | 12W | | | | | |
| | ASD-JBR-4D12AC-WH-12PACK | | ASD-JBS-4D12AC-WH-6PACK | | | | | | |
| | ASD-JBR-4D12AC-NK-6PACK | | ASD-JBS-4D12AC-NK-6PACK | | | | | | |
| | ASD-JBR-4D12AC-BZ-6PACK | 15W | ASD-JBS-4D12AC-BZ-6PACK | 15W | | | | | |
| | ASD-JBR-4D12AC-BK-6PACK | | ASD-JBS-4D12AC-BK-6PACK | | | | | | |
| | ASD-JBR-6D15AC-WH-6PACK | | ASD-JBS-6D15AC-WH-6PACK | | | | | | |
| | ASD-JBR-6D15AC-WH-12PACK | 15W | ASD-JBS-6D15AC-NK-6PACK | 15W | | | | | |
| | ASD-JBR-6D15AC-NK-6PACK | | ASD-JBS-6D15AC-BZ-6PACK | | | | | | |
| | ASD-JBR-6D15AC-BZ-6PACK | | ASD-JBS-6D15AC-BK-6PACK | | | | | | |
| | ASD-JBR-6D15AC-BK-6PACK | 20W | ASD-JBS-8D20AC-WH | 20W | | | | | |
| | ASD-JBR-8D20AC-WH | | ASD-JBS-8D20AC-BK | | | | | | |
| | ASD-JBR-8D20AC-BK | | ASD-JBS-12D24AC-WH | | | | | | |
| ASD-JBR-12D24AC-WH | 24W | ASD-JBS-12D24AC-BK | 24W | | | | | | |
| Power factor | > 0.9 | | | | | | | | |
| Output voltage | 36 V | | | | | | | | |
| Max output current | ASD-JBR-3D6AC-WH-6PACK | 0.146 A | ASD-JBR-12D24AC-BK | 0.586 A | | | | | |
| | ASD-JBR-3D6AC-NK-6PACK | | ASD-JBS-3D6AC-WH-6PACK | 0.146 A | | | | | |
| | ASD-JBR-3D6AC-BZ-6PACK | | ASD-JBS-3D6AC-NK-6PACK | | | | | | |
| | ASD-JBR-3D6AC-BK-6PACK | ASD-JBS-3D6AC-BZ-6PACK | | | | | | | |
| | ASD-JBR-4D12AC-WH-6PACK | 0.293 A | ASD-JBS-3D6AC-BK-6PACK | 0.293 A | | | | | |
| | ASD-JBR-4D12AC-WH-12PACK | | ASD-JBS-4D12AC-WH-6PACK | | | | | | |
| | ASD-JBR-4D12AC-NK-6PACK | | ASD-JBS-4D12AC-NK-6PACK | | | | | | |
| | ASD-JBR-4D12AC-BZ-6PACK | 0.366 A | ASD-JBS-4D12AC-BZ-6PACK | 0.366 A | | | | | |
| | ASD-JBR-4D12AC-BK-6PACK | | ASD-JBS-4D12AC-BK-6PACK | | | | | | |
| | ASD-JBR-6D15AC-WH-6PACK | | ASD-JBS-6D15AC-WH-6PACK | | | | | | |
| | ASD-JBR-6D15AC-WH-12PACK | 0.366 A | ASD-JBS-6D15AC-NK-6PACK | 0.366 A | | | | | |
| | ASD-JBR-6D15AC-NK-6PACK | | ASD-JBS-6D15AC-BZ-6PACK | | | | | | |
| | ASD-JBR-6D15AC-BZ-6PACK | | ASD-JBS-6D15AC-BK-6PACK | | | | | | |
| | ASD-JBR-6D15AC-BK-6PACK | 0.488 A | ASD-JBS-8D20AC-WH | 0.488 A | | | | | |
| | ASD-JBR-8D20AC-WH | | ASD-JBS-8D20AC-BK | | | | | | |
| | ASD-JBR-8D20AC-BK | | ASD-JBS-12D24AC-WH | | | | | | |
| ASD-JBR-12D24AC-WH | 0.586 A | ASD-JBS-12D24AC-BK | 0.586 A | | | | | | |
| Surge protection DM/CM | 2.5 kV / 2.5 kV | | | | | | | | |
| Dimming range | | | | | | | | | |
| 10-100% | | | | | | | | | |
| Dimming compatible controls | | | | | | | | | |
| Brand | Lutron | | | | | Leviton | | | |
| Models | CTCL-153PDH-WH | MACL-153M-WH | SLV-600P-WH | DV-600P | S-600P | DB33K1 | 6633-P | 6683 | |
| | DVW-603PGH-WH | CT-603PGH-WH | S-600PR-WH | NT-1000 | 4X603 | 1A2305 | VP106 | 6674 | |
| | MIR-600THW-WH | DVCL-153P-WH | CTCL-153P | S-603P | | 1F4205 | IPL06 | 6672 | |

For most up-to-date spec sheets please refer to asd-lighting.com



LED RECESSED MINI PANEL

Regular and voluntary certifications

| |
|-----------------------------------------------|
| 5-year limited warranty |
| Energy Star listed |
| UL certified E473854 |
| Title 24 JA8-2022 compliant (JBR models only) |

PACKAGE CONTENTS:

| Description | Q-ty |
|----------------------------------------|----------------------------------|
| LED Recessed Mini Panel | 1 (6 for 6 pack; 12 for 12 pack) |
| Template for 3, 4, 6, 8 or 12 inch (A) | 1 |
| Box | 1 |

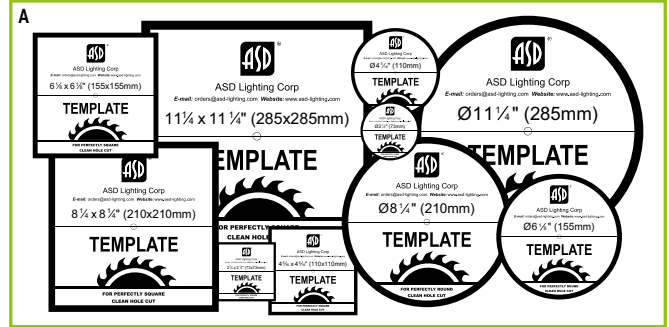

ACCESSORIES (sold separately):

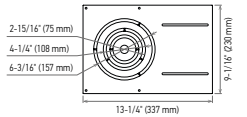
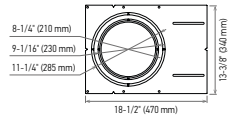
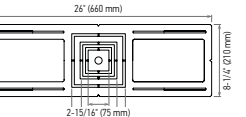
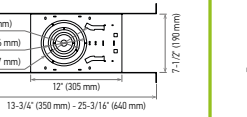
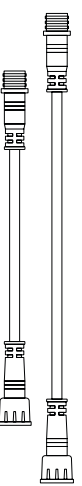
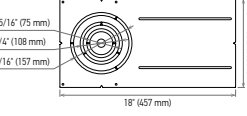
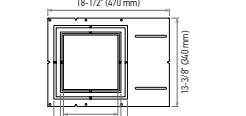
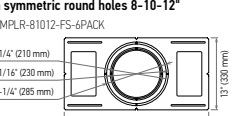
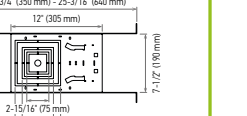
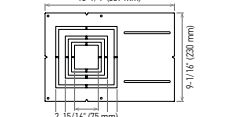
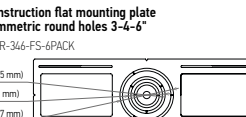
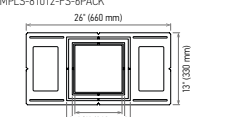
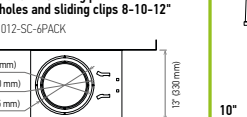
| | | | | |
|-----------------------------------------------------------------------------------------------------------------------------------------------------------------------------------------------------------|---------------------------------------------------------------------------------------------------------------------------------------------------------------------------------------------------------|----------------------------------------------------------------------------------------------------------------------------------------------------------------------------------------------------------|-------------------------------------------------------------------------------------------------------------------------------------------------------------------------------------------------------------|----------------------------------------------------------------------------------------------------------------------------------------------------------------------------------------|
| <p>New construction flat mounting plate with asymmetric round holes 3-4-6" ASD-MPLR-346-FA-6PACK</p>  | <p>New construction flat mounting plate with asymmetric square holes 8-10-12" ASD-MPLR-81012-FA-6PACK</p>  | <p>New construction flat mounting plate with symmetric square holes 3-4-6" ASD-MPLS-346-FS-6PACK</p>  | <p>New construction mounting plate with round holes and sliding clips 3-4-6" ASD-MPLR-346-SC-6PACK</p>  | <p>Extension cord 3PIN</p>  <p>10' ASD-EC-10A-6PACK</p> <p>20' ASD-EC-20A-6PACK</p> |
| <p>New construction flat mounting plate 18" with asymmetric round holes 3-4-6" ASD-MPLR-18-346-FA-6PACK</p>  | <p>New construction flat mounting plate with asymmetric square holes 8-10-12" ASD-MPLS-81012-FA-6PACK</p>  | <p>New construction flat mounting plate with symmetric round holes 8-10-12" ASD-MPLR-81012-FS-6PACK</p>  | <p>New construction mounting plate with square holes and sliding clips 3-4-6" ASD-MPLS-346-SC-6PACK</p>  | |
| <p>New construction flat mounting plate with asymmetric square holes 3-4-6" ASD-MPLS-346-FA-6PACK</p>  | <p>New construction flat mounting plate with symmetric round holes 3-4-6" ASD-MPLR-346-FS-6PACK</p>  | <p>New construction flat mounting plate with symmetric square holes 8-10-12" ASD-MPLS-81012-FS-6PACK</p>  | <p>New construction mounting plate with round holes and sliding clips 8-10-12" ASD-MPLR-81012-SC-6PACK</p>  | |

ACCESSORY COMPATIBILITY LIST:

| Models | Accessories | Accessories | | | | | | | | | | | |
|---------|-------------|--------------------------------------------------------------------------------------------------|---------------------------------------------------------------------------------------------------------|---------------------------------------------------------------------------------------------------|-------------------------------------------------------------------------------------------------------|-------------------------------------------------------------------------------------------------------|-------------------------------------------------------------------------------------------------|--------------------------------------------------------------------------------------------------|-----------------------------------------------------------------------------------------------------|------------------------------------------------------------------------------------------------------|----------------------------------------------------------------------------------------------------|-----------------------------------------------------------------------------------------------------|--------------------------------------------------------------------------------------------------------|
| | | New construction flat mounting plate with asymmetric round holes 3-4-6" ASD-MPLR-346-FA-6PACK | New construction flat mounting plate 18" with asymmetric round holes 3-4-6" ASD-MPLR-18-346-FA-6PACK | New construction flat mounting plate with asymmetric square holes 3-4-6" ASD-MPLS-346-FA-6PACK | New construction flat mounting plate with asymmetric square holes 8-10-12" ASD-MPLR-81012-FA-6PACK | New construction flat mounting plate with asymmetric square holes 8-10-12" ASD-MPLS-81012-FA-6PACK | New construction flat mounting plate with symmetric round holes 3-4-6" ASD-MPLR-346-FS-6PACK | New construction flat mounting plate with symmetric square holes 3-4-6" ASD-MPLS-346-FS-6PACK | New construction flat mounting plate with symmetric round holes 8-10-12" ASD-MPLR-81012-FS-6PACK | New construction flat mounting plate with symmetric square holes 8-10-12" ASD-MPLS-81012-FS-6PACK | New construction mounting plate with round holes and sliding clips 3-4-6" ASD-MPLR-346-SC-6PACK | New construction mounting plate with square holes and sliding clips 3-4-6" ASD-MPLS-346-SC-6PACK | New construction mounting plate with round holes and sliding clips 8-10-12" ASD-MPLR-81012-SC-6PACK |
| ASD-JBR | 3" | • | • | | | • | | | | • | | | • |
| | 4" | • | • | | | • | | | | • | | | • |
| | 6" | • | • | | | • | | | | • | | | • |
| | 8" | | | | | • | | | | | | | • |
| ASD-JBS | 3" | | | | | | | | | | | | • |
| | 4" | | | | | | | | | | | | • |
| | 6" | | | | | | | | | | | | • |
| | 12" | | | | | | | | | | | | • |

For most up-to-date spec sheets please refer to asd-lighting.com



LED RECESSED MINI PANEL

INSTALLATION GUIDE

IMPORTANT SAFETY INFORMATION:

Please read all the instructions below before installation.

- ▶ Make sure that the supply voltage corresponds to the rated product voltage.
- ▶ The product must be installed by a qualified electrician in accordance with the National Electrical Code and corresponding local codes.
- ▶ If the product is damaged, do not use it.

⚠ WARNING

RISK OF PERSONAL INJURY – READ and follow all WARNINGS and installation instructions. Keep or give to the owner for future reference.
Risk of cuts: Wear gloves to prevent cuts or abrasions when removing from carton, handling, installing, and maintaining this product.
Risk of electric shock: This product must be installed in accordance with the applicable installation code by a person familiar with the construction and operation of the product and the hazards involved.
Risk of Fire: Minimum 194°F supply conductors. Consult a qualified electrician to ensure correct branch circuit conductor.
 ASD® assumes no responsibility for claims arising out of improper or careless installation or handling of this product.

INSTALLATION STEPS:

1. Use template to cut an appropriate sized hole. Disconnect the fixture from the junction box.
2. Open junction box. Connect the wires: Black to Black, White to White, Green to Green. Secure the connection with quick connector. Choose needed color temperature by adjusting the switch. Close the junction box.
3. Insert the junction box into the cut hole, leaving the connection cable outside. Connect the fixture to the Junction box inserting the cable and securing it with a cap. Push the spring loaded clips upwards and insert the fixture base into the mounting hole. Release the clips, so the fixture fits securely.

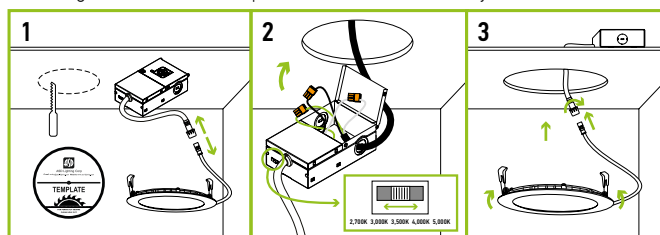

* The fixture is suitable for ceiling thickness less than 0.3 inch.

ELECTRICAL SCHEMATIC DIAGRAM:

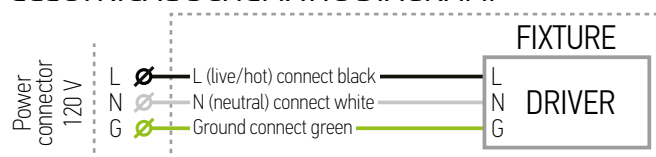

EXTENSION CORD INSTALLATION:

1. Disconnect the LED Mini Panel cable from the Junction box cable.
2. Connect one end of the Extension Cord to the LED Mini Panel cable, and the other end of the Extension Cord to the Junction box cable.

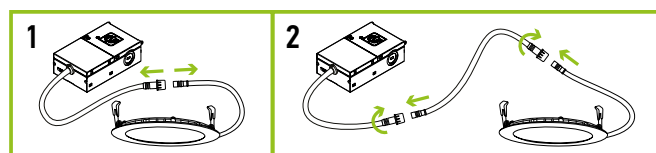

MOUNTING PLATE INSTALLATION

| | | |
|-----------------|-------------------|-------------------|
| ASD-MPLR-346-FA | ASD-MPLR18-346-FA | ASD-MPLR-81012-FA |
| ASD-MPLS-346-FA | ASD-MPLS-81012-FA | ASD-MPLR-346-FS |
| ASD-MPLS-346-FS | ASD-MPLR-81012-FS | ASD-MPLS-81012-FS |
| ASD-MPLS-346-SC | ASD-MPLR-346-SC | ASD-MPLR-81012-SC |

sold separately:

1. Remove the metal ring from the mounting plate according to the size of fixture.
2. Place the mounting plate and secure its position with screws on the beams.

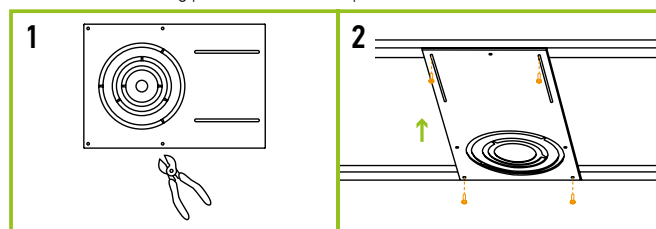

ORDERING INFORMATION

| Model | UPC | Pcs. per carton | Carton size | Carton weight | GTIN 14 |
|--------------------------|--------------|-----------------|----------------------|---------------|----------------|
| JBR ROUND | | | | | |
| ASD-JBR-3D6AC-WH-6PACK | 810050737449 | 2 | 17.1" x 10" x 4.5" | 6.2 lbs | 10810050737446 |
| ASD-JBR-3D6AC-NK-6PACK | 810050738385 | 2 | 17.1" x 10" x 4.5" | 6.2 lbs | 20810050738389 |
| ASD-JBR-3D6AC-BZ-6PACK | 819201022458 | 2 | 17.1" x 10" x 4.5" | 6.2 lbs | 20819201022452 |
| ASD-JBR-3D6AC-BK-6PACK | 810050737456 | 2 | 17.1" x 10" x 4.5" | 6.2 lbs | 10810050737453 |
| ASD-JBR-4D12AC-WH-6PACK | 810050737197 | 2 | 12.6" x 12.6" x 6.3" | 9.3 lbs | 10810050737194 |
| ASD-JBR-4D12AC-WH-12PACK | 810050739719 | 1 | 12" x 11.6" x 5.3" | 8.8 lbs | - |
| ASD-JBR-4D12AC-NK-6PACK | 810050738392 | 2 | 12.6" x 12.6" x 6.3" | 9.3 lbs | 20810050738396 |
| ASD-JBR-4D12AC-BZ-6PACK | 810050738903 | 2 | 12.6" x 12.6" x 6.3" | 9.3 lbs | 10810050738900 |
| ASD-JBR-4D12AC-BK-6PACK | 810050737210 | 2 | 12.6" x 12.6" x 6.3" | 9.3 lbs | 10810050737217 |
| ASD-JBR-6D15AC-WH-6PACK | 810050737241 | 2 | 13" x 12.4" x 8" | 11.1 lbs | 10810050737248 |
| ASD-JBR-6D15AC-WH-12PACK | 810050739726 | 1 | 12.4" x 10.8" x 7.3" | 10.4 lbs | - |
| ASD-JBR-6D15AC-NK-6PACK | 810050738408 | 2 | 13" x 12.4" x 8" | 11.1 lbs | 20810050738402 |
| ASD-JBR-6D15AC-BZ-6PACK | 810050738910 | 2 | 13" x 12.4" x 8" | 11.1 lbs | 10810050738917 |
| ASD-JBR-6D15AC-BK-6PACK | 810050737265 | 2 | 13" x 12.4" x 8" | 11.1 lbs | 10810050737262 |

For most up-to-date spec sheets please refer to asd-lighting.com



LED RECESSED MINI PANEL

| Model | UPC | Pcs. per carton | Carton size | Carton weight | GTIN 14 |
|-------------------------|--------------|-----------------|----------------------|---------------|----------------|
| ASD-JBR-8D20AC-WH | 810050737470 | 4 | 9.7" x 9.7" x 9.5" | 6 lbs | 10810050737477 |
| ASD-JBR-8D20AC-BK | 810050737487 | 4 | 9.7" x 9.7" x 9.5" | 6 lbs | 10810050737484 |
| ASD-JBR-12D24AC-WH | 810050737494 | 4 | 12.4" x 9.6" x 12.4" | 7.9 lbs | 10810050737491 |
| ASD-JBR-12D24AC-BK | 810050737500 | 4 | 12.4" x 9.6" x 12.4" | 7.9 lbs | 10810050737507 |
| JBS SQUARE | | | | | |
| ASD-JBS-3D6AC-WH-6PACK | 810050737524 | 2 | 17.1" x 10" x 4.5" | 6.6 lbs | 10810050737521 |
| ASD-JBS-3D6AC-NK-6PACK | 810050738415 | 2 | 17.1" x 10" x 4.5" | 6.6 lbs | 20810050738419 |
| ASD-JBS-3D6AC-BZ-6PACK | 819201022465 | 2 | 17.1" x 10" x 4.5" | 6.6 lbs | 20819201022469 |
| ASD-JBS-3D6AC-BK-6PACK | 810050737548 | 2 | 17.1" x 10" x 4.5" | 6.6 lbs | 10810050737545 |
| ASD-JBS-4D12AC-WH-6PACK | 810050737289 | 2 | 12.6" x 12.6" x 6.3" | 9.3 lbs | 10810050737286 |
| ASD-JBS-4D12AC-NK-6PACK | 810050738422 | 2 | 12.6" x 12.6" x 6.3" | 9.3 lbs | 20810050738426 |
| ASD-JBS-4D12AC-BZ-6PACK | 810050738927 | 2 | 12.6" x 12.6" x 6.3" | 9.3 lbs | 10810050738924 |
| ASD-JBS-4D12AC-BK-6PACK | 810050737302 | 2 | 12.6" x 12.6" x 6.3" | 9.3 lbs | 10810050737309 |
| ASD-JBS-6D15AC-WH-6PACK | 810050737326 | 2 | 14" x 12.4" x 8" | 12.1 lbs | 10810050737323 |
| ASD-JBS-6D15AC-NK-6PACK | 810050738439 | 2 | 14" x 12.4" x 8" | 12.1 lbs | 20810050738433 |
| ASD-JBS-6D15AC-BZ-6PACK | 810050738934 | 2 | 14" x 12.4" x 8" | 12.1 lbs | 10810050738931 |
| ASD-JBS-6D15AC-BK-6PACK | 810050737562 | 2 | 14" x 12.4" x 8" | 12.1 lbs | 10810050737569 |
| ASD-JBS-8D20AC-WH | 810050737579 | 4 | 10.4" x 9.7" x 9.5" | 6.6 lbs | 10810050737576 |
| ASD-JBS-8D20AC-BK | 810050737586 | 4 | 10.4" x 9.7" x 9.5" | 6.6 lbs | 10810050737583 |
| ASD-JBS-12D24AC-WH | 810050737593 | 4 | 13.4" x 9.7" x 12.3" | 9.5 lbs | 10810050737590 |
| ASD-JBS-12D24AC-BK | 810050737609 | 4 | 13.4" x 9.7" x 12.3" | 9.5 lbs | 10810050737606 |

ACCESSORIES:

| Model | Description | UPC | Pcs. per carton | Carton size | Carton weight | GTIN 14 in carton |
|-------------------------|-----------------------------------------------------------------------------|--------------|-----------------|-----------------------|---------------|-------------------|
| ASD-MPLR-346-FA-6PACK | New construction flat mounting plate with asymmetric round holes 3-4-6" | 810050739344 | 4 | 14.4" x 9.8" x 3.2" | 22.5 lbs | 10810050739341 |
| ASD-MPLR18-346-FA-6PACK | New construction flat mounting plate 18" with asymmetric round holes 3-4-6" | 810128112826 | 4 | 18.9" x 9.8" x 3.2" | 32.9 lbs | 10810128112823 |
| ASD-MPLR-81012-FA-6PACK | New construction flat mounting plate with asymmetric round holes 8-10-12" | 810128111553 | 4 | 19.5" x 14.2" x 3.2" | 38.7 lbs | 10810128111550 |
| ASD-MPLS-346-FA-6PACK | New construction flat mounting plate with asymmetric square holes 3-4-6" | 810128110303 | 4 | 14.4" x 9.8" x 3.2" | 22.7 lbs | 10810128110300 |
| ASD-MPLS-81012-FA-6PACK | New construction flat mounting plate with asymmetric square holes 8-10-12" | 810128112833 | 4 | 19.5" x 14.2" x 3.2" | 32.9 lbs | 10810128112830 |
| ASD-MPLR-346-FS-6PACK | New construction flat mounting plate with symmetric round holes 3-4-6" | 810050739351 | 4 | 27.2" x 9.1" x 3.2" | 25.2 lbs | 10810050739358 |
| ASD-MPLR-81012-FS-6PACK | New construction flat mounting plate with symmetric round holes 8-10-12" | 810128111577 | 4 | 27" x 13.8" x 3.2" | 42.9 lbs | 10810128111574 |
| ASD-MPLS-346-FS-6PACK | New construction flat mounting plate with symmetric square holes 3-4-6" | 810128110310 | 4 | 27" x 9.1" x 3.2" | 26 lbs | 10810128110317 |
| ASD-MPLS-81012-FS-6PACK | New construction flat mounting plate with symmetric square holes 8-10-12" | 810128112840 | 4 | 27" x 13.8" x 3.2" | 39.1 lbs | 10810128112847 |
| ASD-MPLR-346-SC-6PACK | New construction mounting plate with round holes and sliding clips 3-4-6" | 810050739337 | 2 | 17.3" x 11.9" x 13.4" | 17 lbs | 10810050739334 |
| ASD-MPLR-81012-SC-6PACK | New construction mounting plate with round holes and sliding clips 8-10-12" | 810128111607 | 2 | 21.3" x 17.5" x 15.6" | 24.7 lbs | 10810128111604 |
| ASD-MPLS-346-SC-6PACK | New construction mounting plate with square holes and sliding clips 3-4-6" | 810128110327 | 2 | 17.3" x 11.9" x 13.4" | 16.5 lbs | 10810128110324 |
| ASD-EC-10A-6PACK | Extension cord 3PIN 10" | 810128110471 | 10 | 7.7" x 6.1" x 5.3" | 1.8 lbs | 10810128110478 |
| ASD-EC-20A-6PACK | Extension cord 3PIN 20" | 810128110488 | 10 | 7.7" x 6.1" x 7.3" | 3.1 lbs | 10810128110485 |

For most up-to-date spec sheets please refer to asd-lighting.com

ASD LIGHTING CORP

E-mail: orders@asd-lighting.com | Web site: www.asd-lighting.com

