



LED UNDER CABINET LINEAR LIGHT

► **DESIGN** - LED UNDER CABINET LINEAR LIGHT is perfect for a hidden backlight. The built-in Hi/Low switch provides 100% and 50% brightness. The acrylic lens with a 110° beam angle and CRI90+ grants you even light distribution. It is designed to operate on 120V circuits.

► **COLOR SELECTABLE** - You can choose either a 2,700K soft white, 3,000K warm white, or 4,000K cool white color temperature.

► **DIMMING** - Smooth triac dimming capabilities ranging from 10% to 100% with modern LED dimmers allow you to control the look and feel of your space.

► **INSTALLATION** - These fixtures can be installed as a plug-in or hardwired and also have the option of being linked together or installed separately. It is also Damp Locations rated.

► **ADVANTAGES** - With a lifespan of 50,000 hours, these fixtures are made to last decades under normal operation! ASD provides a 5-year limited warranty along with ETL and Energy Star certifications to guarantee top quality products and safety!

| | |
|-----------------------|--|
| <i>Catalog number</i> | |
| <i>Notes</i> | |
| <i>Type</i> | |



| Model | Size | Watts | Voltage | Dimmable | Lumens | CCT | Finish | Dimensions (LxWxH) |
|--------------------|---------|-------|---------|----------|----------------|----------------------------|--------|---------------------|
| ASD-UCL-9D3CC-WH | 9 inch | 3W | 120 V | TRIAC | up to 214 lm | 3CCT (2,700/3,000/4,000 K) | White | 9" x 3-11/16" x 1" |
| ASD-UCL-12D5CC-WH | 12 inch | 5W | 120 V | TRIAC | up to 406 lm | 3CCT (2,700/3,000/4,000 K) | White | 12" x 3-11/16" x 1" |
| ASD-UCL-18D8CC-WH | 18 inch | 8W | 120 V | TRIAC | up to 548 lm | 3CCT (2,700/3,000/4,000 K) | White | 18" x 3-11/16" x 1" |
| ASD-UCL-24D12CC-WH | 24 inch | 12W | 120 V | TRIAC | up to 874 lm | 3CCT (2,700/3,000/4,000 K) | White | 24" x 3-11/16" x 1" |
| ASD-UCL-32D16CC-WH | 32 inch | 16W | 120 V | TRIAC | up to 1,131 lm | 3CCT (2,700/3,000/4,000 K) | White | 32" x 3-11/16" x 1" |
| ASD-UCL-40D20CC-WH | 40 inch | 20W | 120 V | TRIAC | up to 1,532 lm | 3CCT (2,700/3,000/4,000 K) | White | 40" x 3-11/16" x 1" |
| ASD-UCL-48D24CC-WH | 48 inch | 24W | 120 V | TRIAC | up to 1,781 lm | 3CCT (2,700/3,000/4,000 K) | White | 48" x 3-11/16" x 1" |

For detailed luminous flux information please refer to Annex 1.

ANNEX 1

| Model | Watts | 2,700 K | 3,000 K | 4,000 K |
|--------------------|-------|----------|----------|----------|
| ASD-UCL-9D3CC-WH | 3W | 170 lm | 207 lm | 214 lm |
| ASD-UCL-12D5CC-WH | 5W | 297 lm | 395 lm | 406 lm |
| ASD-UCL-18D8CC-WH | 8W | 480 lm | 533 lm | 548 lm |
| ASD-UCL-24D12CC-WH | 12W | 758 lm | 854 lm | 874 lm |
| ASD-UCL-32D16CC-WH | 16W | 1,084 lm | 1,104 lm | 1,131 lm |
| ASD-UCL-40D20CC-WH | 20W | 1,437 lm | 1,477 lm | 1,532 lm |
| ASD-UCL-48D24CC-WH | 24W | 1,710 lm | 1,650 lm | 1,781 lm |

For most up-to-date spec sheets please refer to asd-lighting.com



LED UNDER CABINET LINEAR LIGHT

PRODUCT SPECIFICATIONS:

| Construction & Materials | | | | Electrical system | | | |
|------------------------------------|-------------------------------------------------------|------------------|-------------------|---------------------------------------------|------------------------------|------------------|--------------|
| Housing | Aluminum | | | Input voltage | 120 V | | |
| Lens | Plastic | | | Max input current | ASD-UCL-9D3CC-WH | 0.03 A | |
| Finish | White | | | | ASD-UCL-12D5CC-WH | 0.05 A | |
| Weight | ASD-UCL-9D3CC-WH | 1.1 lbs (0.5 kg) | | | ASD-UCL-18D8CC-WH | 0.082 A | |
| | ASD-UCL-12D5CC-WH | 1.3 lbs (0.6 kg) | | | ASD-UCL-24D12CC-WH | 0.12 A | |
| | ASD-UCL-18D8CC-WH | 1.5 lbs (0.7 kg) | | | ASD-UCL-32D16CC-WH | 0.165 A | |
| | ASD-UCL-24D12CC-WH | 1.9 lbs (0.9 kg) | | | ASD-UCL-40D20CC-WH | 0.21 A | |
| | ASD-UCL-32D16CC-WH | 2.3 lbs (1 kg) | | | ASD-UCL-48D24CC-WH | 0.23 A | |
| | ASD-UCL-40D20CC-WH | 2.8 lbs (1.3 kg) | | | Inrush current (Action time) | ASD-UCL-9D3CC-WH | 0.03 A (1 S) |
| ASD-UCL-48D24CC-WH | 3.2 lbs (1.5 kg) | | ASD-UCL-12D5CC-BZ | 0.05 A (1 S) | | | |
| Environmental system | | | | ASD-UCL-18D8CC-WH | | 0.08 A (1 S) | |
| Work environment | Suitable for Damp Locations | | | ASD-UCL-24D12CC-WH | | 0.12 A (1 S) | |
| Operating temperature | -4°F to 113°F (-20°C to 45°C) | | | ASD-UCL-32D16CC-WH | | 0.16 A (1 S) | |
| L-70 Life | > 50,000 hrs | | | ASD-UCL-40D20CC-WH | | 0.21 A (1 S) | |
| Optical system | | | | ASD-UCL-48D24CC-WH | 0.23 A (1 S) | | |
| Color temperature | 3CCT switch (2,700/3,000/4,000 K), 3,000 K by default | | | Off state power | 0W | | |
| CRI | > 90 | | | Power consumption | ASD-UCL-9D3CC-WH | 3W | |
| Dimming range | | | | | ASD-UCL-12D5CC-WH | 5W | |
| 10-100% | | | | | ASD-UCL-18D8CC-WH | 8W | |
| Dimming compatible controls | | | | | ASD-UCL-24D12CC-WH | 12W | |
| Brand | Lutron | | | | ASD-UCL-32D16CC-WH | 16W | |
| Models | DV-603PG-WH | MACL-153M | DVL-600P | | ASD-UCL-40D20CC-WH | 20W | |
| | PD-6WCL-WH | DVCL-153P | DV-600P | | ASD-UCL-48D24CC-WH | 24W | |
| | | | | Power factor | > 0.9 | | |
| | | | | Output voltage | 120 V | | |
| | | | | Max output current | ASD-UCL-9D3CC-WH | 0.024 A | |
| | | | | | ASD-UCL-12D5CC-WH | 0.039 A | |
| | | | | | ASD-UCL-18D8CC-WH | 0.064 A | |
| | | | | | ASD-UCL-24D12CC-WH | 0.095 A | |
| | | | | | ASD-UCL-32D16CC-WH | 0.126 A | |
| | | | | | ASD-UCL-40D20CC-WH | 0.158 A | |
| | | | | ASD-UCL-48D24CC-WH | 0.19 A | | |
| | | | | Regular and voluntary certifications | | | |
| | | | | 5-year limited warranty | | | |
| | | | | Energy Star listed | | | |
| | | | | cETLus certified 3153196 | | | |

PACKAGE CONTENTS:

| Description | Q-ty |
|--------------------------------|------|
| LED Under Cabinet Linear Light | 1 |
| End-to-end connector (A) | 1 |
| Romex connector (B) | 1 |
| 6' linking cord (C) | 1 |
| 6 ft power cord (D) | 1 |
| Screw (E) | 2 |
| Screw cap (F) | 2 |
| Box | 1 |

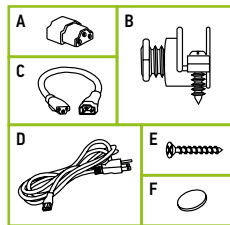

For most up-to-date spec sheets please refer to asd-lighting.com



LED UNDER CABINET LINEAR LIGHT

INSTALLATION GUIDE

IMPORTANT SAFETY INFORMATION:

Please read all the instructions below before installation.

- ▶ Make sure that the supply voltage corresponds to the rated product voltage.
- ▶ The product must be installed by a qualified electrician in accordance with the National Electrical Code and corresponding local codes.
- ▶ If the product is damaged, do not use it.

ELECTRICAL SCHEMATIC DIAGRAM:

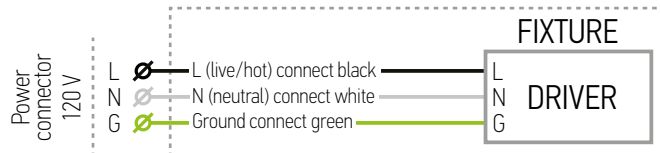

PLUG-IN INSTALLATION:

1. Attach the fixture to the surface using two screws.
2. Multiple fixtures can be linked together with the end to end connector or linking cord.
3. Choose the preferred color temperature and lighting mode by using the switch.

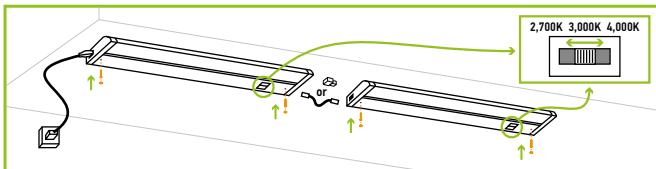

⚠ WARNING

RISK OF PERSONAL INJURY – READ and follow all WARNINGS and installation instructions. Keep or give to the owner for future reference.

Risk of cuts: Wear gloves to prevent cuts or abrasions when removing from carton, handling, installing, and maintaining this product.

Risk of electric shock: This product must be installed in accordance with the applicable installation code by a person familiar with the construction and operation of the product and the hazards involved.

Risk of Fire: Minimum 194°F supply conductors. Consult a qualified electrician to ensure correct branch circuit conductor.

ASD® assumes no responsibility for claims arising out of improper or careless installation or handling of this product.

HARDWIRE INSTALLATION:

1. Remove the knock-out. Dismount the adapter plate by loosening the screw. Insert the romex connector into the open hole and secure it with the nut. Dismount the front plate of the fixture by loosening two screws.
 2. Attach the fixture to the surface using two screws and cover holes with screw caps. Choose the preferred color temperature and lighting mode using the switch.
 3. Pass the wires through the romex connector and tuck them into the fixture. Connect the wires inside the fixture: Black to Black, White to White, Green to Green. Secure the connection with wire nuts. Reattach the front plate and the adapter plate by tightening the screws.
- Multiple fixtures can be linked together with the end to end connector or linking cord.

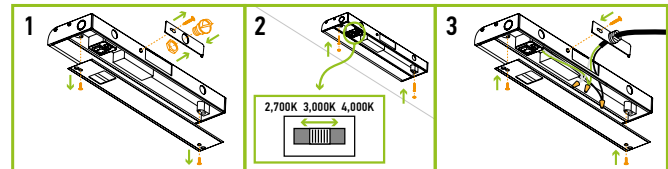

* Multiple fixtures with different sizes and wattages can be linked together, the total wattage must not exceed 200W.

ORDERING INFORMATION

| Model | UPC | Pcs. per carton | Carton size | Carton weight | GTIN 14 |
|--------------------|--------------|-----------------|----------------------|---------------|----------------|
| ASD-UCL-9D3CC-WH | 810050734196 | 20 | 14.8" x 14.4" x 8.7" | 26 lbs | 40810050734194 |
| ASD-UCL-12D5CC-WH | 810050734202 | 20 | 17.3" x 14.8" x 8.7" | 30.6 lbs | 10810050734209 |
| ASD-UCL-18D8CC-WH | 810050734226 | 20 | 23.2" x 14.8" x 8.7" | 38.3 lbs | 10810050734223 |
| ASD-UCL-24D12CC-WH | 810050734240 | 12 | 29.3" x 9.1" x 8.7" | 27.5 lbs | 20810050734244 |
| ASD-UCL-32D16CC-WH | 810050734264 | 12 | 37.4" x 9.1" x 8.7" | 33.9 lbs | 30810050734265 |
| ASD-UCL-40D20CC-WH | 810050734271 | 12 | 45.3" x 9.1" x 8.7" | 40.7 lbs | 30810050734272 |
| ASD-UCL-48D24CC-WH | 810050734288 | 6 | 51.8" x 7.7" x 10.2" | 24.2 lbs | 40810050734286 |

For most up-to-date spec sheets please refer to asd-lighting.com