



LED MAGNETIC MOUNT TROFFER RETROFIT KIT

► **DESIGN & OPTIONS** - LED MAGNETIC MOUNT TROFFER RETROFIT KIT is designed to replace the ballast and tubes in 2x2 and 2x4 fluorescent troffers and existing industrial strips or wrap fixtures. This fixture has lightweight and durable polycarbonate to ensure long life, aluminum on the back to provide great heat dissipation, LED strips, and a 0-10V dimmable driver. It comes with a 120-277V and a 4000K or 5000K color temperature.

► **INSTALLATION** - The magnets on the back of the strip around the perimeter provide secure mounting and ensure a fast and easy installation process. In just a few minutes your existing troffers, strips or wraps can be converted into energy-efficient, long-lasting LED lights while preserving the look of your space. Simply attach the LED MAGNETIC MOUNT TROFFER RETROFIT KIT inside the existing fixture. Refer to install instructions for detailed steps.

► **APPLICATION** - This LED MAGNETIC MOUNT TROFFER RETROFIT KIT is perfect for offices, lobbies, hallways, classrooms, conference rooms, school facilities, libraries, showrooms, airports, shopping malls, workshops, healthcare facilities and so on! The fixture is Dry location rated and can operate in temperatures between -40+122°F (-40+50°C).

► **ENERGY SAVINGS & EFFICIENCY** - This fixture provides a lumen output that is equal to or higher than traditional fluorescent fixtures and can cut your electric bill by up to 80% instantly. With a lifespan of 54,000 hours, these fixtures are made to last decades under normal operation! This fixture will save you a significant amount of money in its lifetime.

► **CERTIFICATION & WARRANTY** - Buy with confidence: ASD provides a 5-year warranty along with ETL and DLC Standard certifications to guarantee top quality products and safety!

Top US certifications allow participation in rebates; please check the rebate programs available in your state.

Catalog number	
Notes	
Type	



PRODUCT LEGEND:

Family	Size	Dimmable	Watts	CCT
ASD-LRKTR	X	X	XX	XX
LED Magnetic Mount Troffer Retrofit Kit	2 = 2 ft 4 = 4 ft	D = Dimmable	25 = 25 W 36 = 36 W	40 = 4,000 K 50 = 5,000 K

LED MAGNETIC MOUNT TROFFER RETROFIT KIT:

Model	Watts	Voltage	Dimmable	Lumens	CCT	Dimensions (LxWxH)
ASD-LRKTR-2D2540-PRM	25 W	120-277 V	0-10 V	3,025 lm	4,000 K	19 5/8" x 1 1/4" x 5/8"
ASD-LRKTR-2D2550-PRM	25 W	120-277 V	0-10 V	3,050 lm	5,000 K	19 5/8" x 1 1/4" x 5/8"
ASD-LRKTR-4D3640-PRM	36 W	120-277 V	0-10 V	4,356 lm	4,000 K	43 1/4" x 1 1/4" x 5/8"
ASD-LRKTR-4D3650-PRM	36 W	120-277 V	0-10 V	4,392 lm	5,000 K	43 1/4" x 1 1/4" x 5/8"

ORDERING INFORMATION:

Model	UPC	Pcs in Middle box	Middle box Size	Middle box Weight	GTIN 14 Middle box	Pcs per Carton	Carton Size	Carton Weight	GTIN 14 Carton
ASD-LRKTR-2D2540-PRM	810050735414	2	26.2" x 7.6" x 1.7"	2.3 lb	10810050735411	20	26.7" x 15.7" x 9.1"	25.4 lb	20810050735418
ASD-LRKTR-2D2550-PRM	819201026241	2	26.2" x 7.6" x 1.7"	2.3 lb	10819201026248	20	26.7" x 15.7" x 9.1"	25.4 lb	20819201026245
ASD-LRKTR-4D3640-PRM	810050731539	2	45.1" x 7.6" x 1.7"	3.5 lb	10810050731536	20	45.6" x 15.7" x 9.1"	38.1 lb	20810050731533
ASD-LRKTR-4D3650-PRM	819201026258	2	45.1" x 7.6" x 1.7"	3.5 lb	10819201026255	20	45.6" x 15.7" x 9.1"	38.1 lb	20819201026252

For most up-to-date spec sheets please refer to asd-lighting.com



LED MAGNETIC MOUNT TROFFER RETROFIT KIT

PRODUCT SPECIFICATIONS:

Construction & Materials		
Lens	Aluminum	
Finish Color	Silver	
Weight	ASD-LRKTR-2D2540-PRM	0.9 lb (0.4 kg)
	ASD-LRKTR-2D2550-PRM	
	ASD-LRKTR-4D3640-PRM	1.4 lb (0.7 kg)
	ASD-LRKTR-4D3650-PRM	
Environmental System		
Work Environment	Suitable for Dry Locations, IP20	
Operating Temperature	-40°F to 122°F (-40°C to +50°C)	
L-70 Life	R > 54,000 hrs; C > 135,000 hrs	
Optical System		
Luminous Flux	ASD-LRKTR-2D2540-PRM	3,025 lm
	ASD-LRKTR-2D2550-PRM	3,050 lm
	ASD-LRKTR-4D3640-PRM	4,356 lm
	ASD-LRKTR-4D3650-PRM	4,392 lm
Color Temperature	4,000 K; 5,000 K	
CRI	> 80	
Electrical System		
Input Voltage	120-277 V	
Max input current	ASD-LRKTR-2D2540-PRM	0.25 A
	ASD-LRKTR-2D2550-PRM	
	ASD-LRKTR-4D3640-PRM	0.36 A
	ASD-LRKTR-4D3650-PRM	
Inrush current (Action time)	ASD-LRKTR-2D2540-PRM	6.5 A (0.2 S)
	ASD-LRKTR-2D2550-PRM	
	ASD-LRKTR-4D3640-PRM	8 A (0.4 S)
	ASD-LRKTR-4D3650-PRM	
AC input range	min 90 V max 305 V	
Off State Power	0 W	
Power Consumption	ASD-LRKTR-2D2540-PRM	25 W
	ASD-LRKTR-2D2550-PRM	
	ASD-LRKTR-4D3640-PRM	36 W
	ASD-LRKTR-4D3650-PRM	
Power Factor	≥ 0.9	
Output voltage	42 V	
Max output current	ASD-LRKTR-2D2540-PRM	530 mA
	ASD-LRKTR-2D2550-PRM	
	ASD-LRKTR-4D3640-PRM	890 mA
	ASD-LRKTR-4D3650-PRM	
Surge protection	4 kV	
LED Driver Class	Class 2	
Dimming compatible controls		
Brand	Ltech Lutron Leviton Rab	
Models	E610P NFTV ZS057-DOZ LCLC3/D10	
Regular and Voluntary Certifications		
5-year limited warranty		
DesignLights Consortium (DLC) listed (Classification: Standard)		
Main: Indoor Luminaires;		
General Application: Troffer;		
Primary Use: Luminaires for Ambient Lighting of Interior Commercial Spaces		
cETLus certified 4010110		

PACKAGE CONTENTS:

Description	Q-ty
LED Magnetic Mount Troffer Retrofit Kit	2
Wire nut (A)	8
Screw (B)	12
Box	1
Cut sheet	2

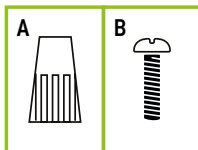

INSTALLATION GUIDE

IMPORTANT SAFETY INFORMATION:

Please read all the instructions below before installation.

- ▶ Make sure that the supply voltage corresponds to the rated product voltage.
- ▶ The product must be installed by a qualified electrician in accordance with the National Electrical Code and corresponding local codes.
- ▶ If the product is damaged, do not use it.

⚠ WARNING

RISK OF PERSONAL INJURY – READ and follow all WARNINGS and installation instructions.

Keep or give to the owner for future reference.

Risk of cuts: Wear gloves to prevent cuts or abrasions when removing from carton, handling, installing, and maintaining this product.

Risk of electric shock: This product must be installed in accordance with the applicable installation code by a person familiar with the construction and operation of the product and the hazards involved.

Risk of Fire: Minimum 194°F supply conductors. Consult a qualified electrician to ensure correct branch circuit conductor.

ASD® assumes no responsibility for claims arising out of improper or careless Installation or handling of this product.

ELECTRICAL SCHEMATIC DIAGRAM:

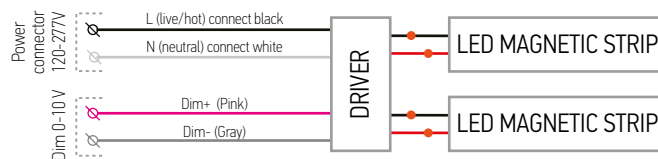

INSTALLATION STEPS:

1. Cut off the power to the existing troffer. Detach the lens and remove fluorescent bulbs and the original ballast.
2. Install the LED driver in place of the original ballast, use screws for secure installation. Attach the magnetic LED strips into the troffer housing.
3. Install the ballast cover over the driver. Reattach the original lens. Turn on the power and test.

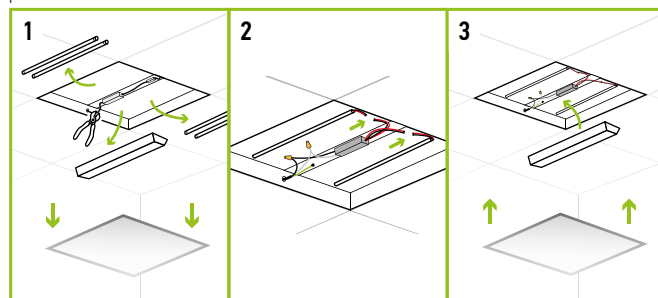

For most up-to-date spec sheets please refer to asd-lighting.com