



LED OVAL DOUBLE RING FLUSHMOUNT

► **DESIGN** - LED OVAL DOUBLE RING FLUSHMOUNT has a modern, multipurpose design and a stylish look with efficient lighting. Durable housing resistant to rust and impact along with an acrylic lens provide many years of use. It is designed to operate on 120V circuits.

► **COLOR SELECTABLE** - You can choose either a 2,700K soft white, 3,000K warm white, 3,500K neutral white, 4,000K cool white, or 5,000K daylight color temperature.

► **DIMMING** - Smooth triac dimming capabilities ranging from 10% to 100% with modern LED dimmers allow you to control the look and feel of your space.

► **APPLICATION** - The LED OVAL DOUBLE RING FLUSHMOUNT provides bright, yet smooth lighting for your family room, bedroom, hallway, corridor, or any other common area in your living space. This fixture is also Damp Locations rated.

► **ADVANTAGES** - With a lifespan of 50,000 hours, these fixtures are made to last decades under normal operation! ASD provides a 5-year limited warranty along with ETL certifications to guarantee top quality products and safety!

Catalog number	
Notes	
Type	



Finish: Nickel Black

Model	Size	Watts	Voltage	Dimmable	Lumens	CCT	Finish	Dimensions (LxWxH)
ASD-FMOV-24D38NK	24 inch	38W	120 V	TRIAC	2,990/2,993/3,289/3,160/2,927 lm	5CCT (2,700/3,000/3,500/4,000/5,000 K)	Nickel	24" x 13-9/16" x 4-5/16"
ASD-FMOV-24D38BK	24 inch	38W	120 V	TRIAC	2,990/2,993/3,289/3,160/2,927 lm	5CCT (2,700/3,000/3,500/4,000/5,000 K)	Black	24" x 13-9/16" x 4-5/16"
ASD-FMOV-32D50NK	32 inch	50W	120 V	TRIAC	3,776/3,966/3,936/4,195/3,614 lm	5CCT (2,700/3,000/3,500/4,000/5,000 K)	Nickel	35-5/16" x 18-1/8" x 4-5/16"
ASD-FMOV-32D50BK	32 inch	50W	120 V	TRIAC	3,776/3,966/3,936/4,195/3,614 lm	5CCT (2,700/3,000/3,500/4,000/5,000 K)	Black	35-5/16" x 18-1/8" x 4-5/16"

PRODUCT SPECIFICATIONS:

Construction & Materials		Electrical system	
Housing	Metal	Input voltage	120 V
Lens	PC	Max input current	ASD-FMOV-24D38NK ASD-FMOV-24D38BK ASD-FMOV-32D50NK ASD-FMOV-32D50BK
Finish	Nickel, Black		0.13 A
Weight	ASD-FMOV-24D38NK ASD-FMOV-24D38BK		1.7 lbs (0.8 kg)
	ASD-FMOV-32D50NK ASD-FMOV-32D50BK	3.1 lbs (1.4 kg)	
Environmental system		Inrush current (Action time)	ASD-FMOV-24D38NK ASD-FMOV-24D38BK
Work environment	Suitable for Damp Locations		0.4 A (0.02 S)
Operating temperature	-4°F to 104°F (-20°C to 40°C)		ASD-FMOV-32D50NK ASD-FMOV-32D50BK
L-70 life	> 50,000 hrs	Off state power	0W
Optical system		Power consumption	ASD-FMOV-24D38NK ASD-FMOV-24D38BK
Luminous flux	ASD-FMOV-24D38NK ASD-FMOV-24D38BK		2,990/2,993/3,289/3,160/2,927 lm
	ASD-FMOV-32D50NK ASD-FMOV-32D50BK	3,776/3,966/3,936/4,195/3,614 lm	50W
CRI	5CCT switch (2,700/3,000/3,500/4,000/5,000 K), 3,000 K by default	Power factor	ASD-FMOV-24D38NK ASD-FMOV-24D38BK
	> 80		> 0.8
Dimming range		Output voltage	ASD-FMOV-32D50NK ASD-FMOV-32D50BK
10-100%			120 V
Regular and voluntary certifications		Max output current	ASD-FMOV-24D38NK ASD-FMOV-24D38BK
5-year limited warranty			135 A
cETLus certified 5026992		ASD-FMOV-32D50NK ASD-FMOV-32D50BK	175 A
		Surge protection DM/CM	0.5 kV / 0.5 kV

For most up-to-date spec sheets please refer to asd-lighting.com



LED OVAL DOUBLE RING FLUSHMOUNT

Dimming compatible controls		
Brand	Lutron	Leviton
Models	CTCL-153PDH-WH-C	RDL06
	DVCL-153PR-WH	
	S-600H-WH-CSA	
	PWCL-153PH	
	DVELV-300P	
	MACL-153M	

PACKAGE CONTENTS:

Description	Q-ty
LED Oval Double Ring Flushmount	1
Fixture screw (A)	2
Self-taping screw (B)	4
Anchor (C)	4
Wire nut (D)	3
Box	1

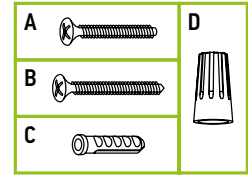

INSTALLATION GUIDE

IMPORTANT SAFETY INFORMATION:

Please read all the instructions below before installation.

- ▶ Make sure that the supply voltage corresponds to the rated product voltage.
- ▶ The product must be installed by a qualified electrician in accordance with the National Electrical Code and corresponding local codes.
- ▶ If the product is damaged, do not use it.

⚠ WARNING

RISK OF PERSONAL INJURY – READ and follow all WARNINGS and installation instructions. Keep or give to the owner for future reference.
Risk of cuts: Wear gloves to prevent cuts or abrasions when removing from carton, handling, installing, and maintaining this product.
Risk of electric shock: This product must be installed in accordance with the applicable installation code by a person familiar with the construction and operation of the product and the hazards involved.
Risk of Fire: Minimum 194°F supply conductors. Consult a qualified electrician to ensure correct branch circuit conductor.
 ASD® assumes no responsibility for claims arising out of improper or careless Installation or handling of this product.

ELECTRICAL SCHEMATIC DIAGRAM:

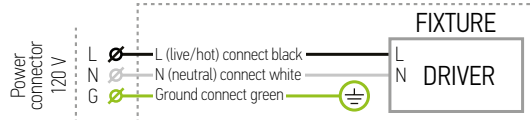

INSTALLATION STEPS:

1. Unscrew cap nuts counter-clockwise and remove the metal ring and the lens.
2. Attach the back plate to the outlet box and mark the location of the holes for the anchors. Remove the back plate and drill four appropriate sized holes for anchors, insert anchors into the holes, twist the four self-tapping screws into the anchors and two fixture screws into the outlet box.
3. Connect the wires: Black to Black, White to White, Ground to Ground. Attach the back plate to the ceiling by feeding self-tapping screws and fixture screws through the keyhole slots and then tighten them in the narrow end of the keyhole slots.
4. Choose either 2,700K, 3,000K, 3,500K, 4,000K or 5,000K with simple switches on both LED drivers. The fixture is set to 3000K by default. Secure the lens and metal ring to the fixture pan using cap nuts.

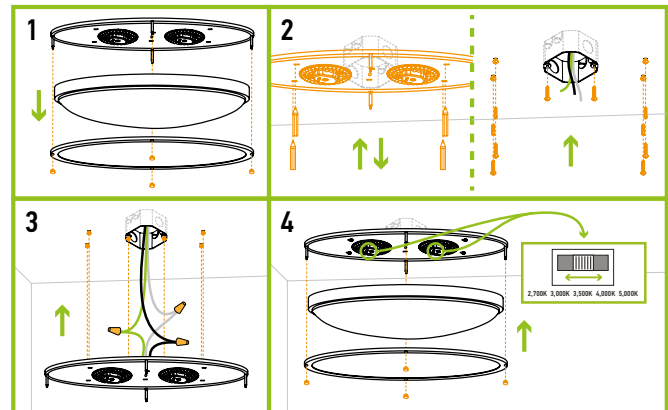

ORDERING INFORMATION

Model	UPC	Pcs. per carton	Carton size	Carton weight	GTIN 14
ASD-FMOV-24D38NK	810128113793	2	26.4" x 15.4" x 12.2"	6.3 lbs	10810128113790
ASD-FMOV-24D38BK	810128113809	2	26.4" x 15.4" x 12.2"	6.3 lbs	10810128113806
ASD-FMOV-32D50NK	810128113816	2	34.7" x 19.9" x 12.2"	9.7 lbs	10810128113813
ASD-FMOV-32D50BK	810128113823	2	34.7" x 19.9" x 12.2"	9.7 lbs	10810128113820

For most up-to-date spec sheets please refer to asd-lighting.com