



LED OUTDOOR WALL SCONCE

► **DESIGN & OPTIONS** - LED OUTDOOR WALL SCONCE has a modern, multipurpose design and a stylish look with efficient lighting. The durable steel base is highly resistant to rust, and the PMMA lens is UV resistant. It is designed to operate on 120-277V circuits. The fixture includes a CCT option, letting you choose either 3000K, 4000K or 5000K with a simple switch. The 160° beam angle grants you smooth and even lighting. It comes in three different sizes: 12", 18", and 24" with a BRONZE finish.

► **INSTALLATION** - Installation is quick and easy: just attach the mounting plate to the outlet box with screws, connect the wires, and fasten the fixture to the mounting plate. Screws, wire nuts, and all necessary installation accessories are provided. Refer to install instructions for detailed steps.

► **APPLICATION** - This LED OUTDOOR WALL SCONCE is an ideal maintenance free solution for residential and commercial installations. It creates a cozy ambience that is great for both indoor and outdoor projects such as decks, front doors, porches, patios, gardens, corridors, balconies, villas, and walkways. The fixture is Wet location rated and suitable for severe weather conditions.

► **ENERGY SAVINGS & EFFICIENCY** - Replacing an incandescent fixture with LED OUTDOOR WALL SCONCE can save you 8 times as much on your current energy bill. With a lifespan of 50,000 hours, these fixtures are made to last decades under normal operation! This fixture will save you a significant amount of money in its lifetime.

► **CERTIFICATION & WARRANTY** - Buy with confidence: ASD provides a 5-year warranty along with ETL and ENERGY STAR certifications to guarantee top quality products and safety!

Top US certifications allow participation in rebates; please check the rebate programs available in your state.

Catalog number	
Notes	
Type	



PRODUCT LEGEND:

Family	Modification	Voltage	Size	Dimmable	Watts	CCT	Finish
ASD-OLWS	22	MV	XX	N	XX	CC	BZ
LED Outdoor Wall Sconce		120-277 V	12 = 12 inch 18 = 18 inch 24 = 24 inch	Non-dimmable	15 = 15 W 20 = 20 W 23 = 23 W	3,000/4,000/5,000 K	Oil Rubbed Bronze

LED OUTDOOR WALL SCONCE:

Model	Size	Watts	Voltage	Dimmable	Lumens	CCT	Dimensions (LxWxH)	UPC
ASD-OLWS-22-MV-12N15CC-BZ	12 inch	15 W	120-277 V	NO	800 lm	3,000/4,000/5,000 K	12" x 6" x 4"	810050730679
ASD-OLWS-22-MV-18N20CC-BZ	18 inch	20 W	120-277 V	NO	1,100 lm	3,000/4,000/5,000 K	18" x 6" x 4"	810050730686
ASD-OLWS-22-MV-24N23CC-BZ	24 inch	23 W	120-277 V	NO	1,200 lm	3,000/4,000/5,000 K	24" x 6" x 4"	810050730693

ORDERING INFORMATION:

Model	Pcs. in middle box	Middle box Size	Middle box Weight	GTIN 14 for Middle box	Pcs. per Carton	Carton Size	Carton Weight	GTIN 14 for Carton
ASD-OLWS-22-MV-12N15CC-BZ	2	13.8" x 7.9" x 11.2"	8.7 lb	10810050730676	4	16.3" x 14.4" x 11.8"	18.7 lb	20810050730673
ASD-OLWS-22-MV-18N20CC-BZ	2	19.7" x 7.9" x 11.2"	10.6 lb	10810050730683	4	20.3" x 16.3" x 11.8"	23.9 lb	20810050730680
ASD-OLWS-22-MV-24N23CC-BZ	2	25.8" x 7.9" x 11.2"	13.8 lb	10810050730690	4	26.4" x 16.3" x 11.8"	29.6 lb	20810050730697

For most up-to-date spec sheets please refer to asd-lighting.com

ASD LIGHTING CORP

E-mail: orders@asd-lighting.com | Web site: www.asd-lighting.com





LED OUTDOOR WALL SCONCE

PRODUCT SPECIFICATIONS:

Construction & Materials			Electrical System		
Housing	Steel		Input Voltage	120-277 V	
Lens	PMMA		Max input current	ASD-OLWS-22-MV-12N15CC-BZ	0.15 A
Finish Color	Oil Rubbed Bronze			ASD-OLWS-22-MV-18N20CC-BZ	0.35 A
	ASD-OLWS-22-MV-24N23CC-BZ			ASD-OLWS-22-MV-24N23CC-BZ	0.35 A
	Weight	ASD-OLWS-22-MV-12N15CC-BZ	3.3 lb (1.5 kg)	Inrush current (Action time)	ASD-OLWS-22-MV-12N15CC-BZ
ASD-OLWS-22-MV-18N20CC-BZ		4.4 lb (2 kg)	ASD-OLWS-22-MV-18N20CC-BZ		0.164 A (0.2 S)
ASD-OLWS-22-MV-24N23CC-BZ		5.6 lb (2.6 kg)	ASD-OLWS-22-MV-24N23CC-BZ		0.164 A (0.2 S)
Environmental System			AC input range	min 100 V max 277 V	
Work Environment	Suitable for Wet Locations		Off State Power	0 W	
Operating Temperature	-40°F to 113°F (-40°C to 45°C)		Power Consumption	ASD-OLWS-22-MV-12N15CC-BZ	15 W
L-70 Life	> 50,000 hrs			ASD-OLWS-22-MV-18N20CC-BZ	20 W
				ASD-OLWS-22-MV-24N23CC-BZ	23 W
Optical System			Power Factor	> 0.9	
Luminous Flux	ASD-OLWS-22-MV-12N15CC-BZ	800 lm	Output voltage	ASD-OLWS-22-MV-12N15CC-BZ	18-36 V
	ASD-OLWS-22-MV-18N20CC-BZ	1,100 lm		ASD-OLWS-22-MV-18N20CC-BZ	30-38 V
	ASD-OLWS-22-MV-24N23CC-BZ	1,200 lm		ASD-OLWS-22-MV-24N23CC-BZ	30-38 V
Color Temperature	3,000/4,000/5,000 K		Max output current	ASD-OLWS-22-MV-12N15CC-BZ	350 mA
CRI	> 80			ASD-OLWS-22-MV-18N20CC-BZ	580 mA
				ASD-OLWS-22-MV-24N23CC-BZ	580 mA
Regular and Voluntary Certifications			LED Driver Class	Class 2	
5-year limited warranty	cETLus certified 4001256	Energy Star listed			

PACKAGE CONTENTS:

Description	Q-ty
LED Outdoor Wall Sconce	1
Mounting bracket (A)	1
Wire nuts (B)	3
Fixture screws and nuts (C)	2
Mounting screw (D)	2
Box	1
Cut sheet	2

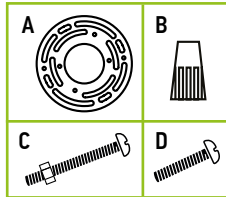

INSTALLATION STEPS 12" AND 18":

1. Remove the bottom cover and pull out the lens. Choose needed color temperature by adjusting the switch position.
2. Align the fixture slots of the mounting bracket and fix the fixture screws on the mounting bracket using fixture screw nuts. Align the mounting slots of the mounting bracket with the holes on the outlet box and attach it with screws.
3. Connect the wires: Black to Black, White to White, Green to Green. Secure the connection with wire nuts. Place the fixture screws in the appropriate holes in the fixture and secure it with a decorative cap nut. Put the lens back in and attach the bottom cover with screws. For outdoor locations it is recommended to use silicone (not included).

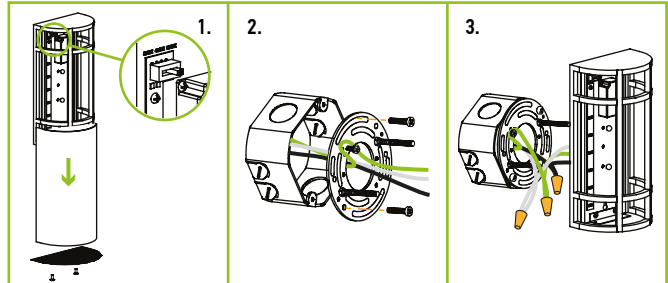

INSTALLATION GUIDE

IMPORTANT SAFETY INFORMATION:

Please read all the instructions below before installation.

- ▶ Make sure that the supply voltage corresponds to the rated product voltage.
- ▶ The product must be installed by a qualified electrician in accordance with the National Electrical Code and corresponding local codes.
- ▶ If the product is damaged, do not use it.

⚠ WARNING

RISK OF PERSONAL INJURY – READ and follow all WARNINGS and installation instructions.

Keep or give to the owner for future reference.

Risk of cuts: Wear gloves to prevent cuts or abrasions when removing from carton, handling, installing, and maintaining this product.

Risk of electric shock: This product must be installed in accordance with the applicable installation code by a person familiar with the construction and operation of the product and the hazards involved.

Risk of Fire: Minimum 194°F supply conductors. Consult a qualified electrician to ensure correct branch circuit conductor.

ASD® assumes no responsibility for claims arising out of improper or careless installation or handling of this product.

ELECTRICAL SCHEMATIC DIAGRAM:

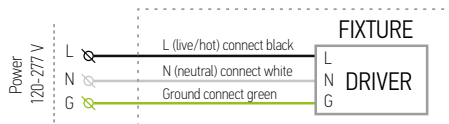

INSTALLATION STEPS 24":

1. Remove the bottom cover and pull out the lens. Choose needed color temperature by adjusting the switch position.
2. Align the fixture slots of the mounting plate and fix the fixture screws on the mounting plate using fixture screw nuts. Align the mounting slots of the mounting plate with the holes of the outlet box and attach it with screws.
3. Connect the wires: Black to Black, White to White, Green to Green. Secure the connection with wire nuts. Place the fixture screws in the appropriate holes in the fixture and secure it with a decorative cap nut. Put the lens back in and attach the bottom cover with screws. For outdoor locations it is recommended to use silicone (not included).

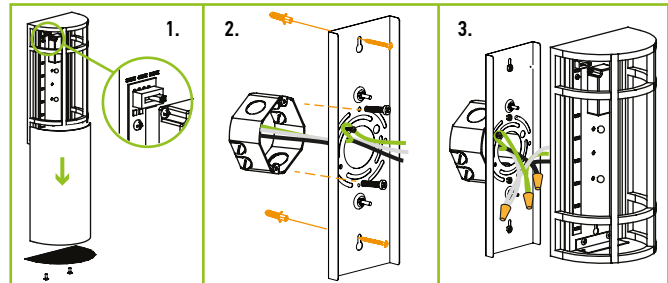

For most up-to-date spec sheets please refer to asd-lighting.com

ASD LIGHTING CORP

E-mail: orders@asd-lighting.com | Web site: www.asd-lighting.com

