



# LED STRIPLIGHT AND STAIRWELL FIXTURE

► **DESIGN** - LED STRIPLIGHT FIXTURE has a narrow, low-profile design. Durable commercial grade housing resistant to rust and impact along with an anti-glare PMMA lens provide many years of use. It is designed to operate on 120-277V circuits with a 0-10V dimmable driver.

► **COLOR AND POWER SELECTABLE** - You can choose either a 3,500K neutral white, 4,000K cool white or 5,000K daylight color temperature, and change the power with a simple switch.

► **MOTION SENSOR** - The built-in microwave motion sensor will turn off the fixture automatically when no motion is detected. The sensor can be adjusted using the handheld remote.

► **BATTERY BACK-UP** - The built-in battery back-up provides 90 minutes of power in case of emergency.

► **LINKABLE DESIGN** - Design of the fixture allows to connect multiple fixtures together with connection bracket.

► **APPLICATION** - Perfect commercial or industrial solution for office buildings, schools, hospitals, hallways, stairwells, workshops, and many other applications. It is also Damp Locations rated.

► **ADVANTAGES** - With calculated lifespan up to 174 000 hours, these fixtures are made to last decades under normal operation! ASD provides a 5-year limited warranty along with UL and DLC Standard certifications to guarantee top quality products and safety!

Catalog number	
Notes	
Type	



Model	Type	Watts	Voltage	Dimmable	Lumens	CCT	Dimensions (LxWxH)	Option
ASD-LSF5-2A28AC-PRM	2 ft	20/24/28W	120-277 V	0-10 V	2,646/3,325/3,890 lm	3CCT (3,500/4,000/5,000 K)	26-3/16" x 2-5/8" x 2-11/16"	-
ASD-LSF5-4A44AC-PRM	4 ft	22/28/36/44W	120-277 V	0-10 V	3,205/3,969/5,045/5,853 lm	3CCT (3,500/4,000/5,000 K)	46-5/8" x 2-5/8" x 2-11/16"	-
ASD-LSF5-8A90AC-PRM	8 ft	48/68/90W	120-277 V	0-10 V	6,390/9,254/12,534 lm	3CCT (3,500/4,000/5,000 K)	92-13/16" x 2-5/8" x 2-11/16"	-
<b>LSF5-EM WITH BATTERY BACK-UP</b>								
ASD-LSF5-2A28AC-4EM-PRM	2 ft	20/24/28W	120-277 V	0-10 V	2,646/3,325/3,890 lm	3CCT (3,500/4,000/5,000 K)	26-3/16" x 2-5/8" x 2-11/16"	4W Battery back-up
ASD-LSF5-4A44AC-12EM-PRM	4 ft	22/28/36/44W	120-277 V	0-10 V	3,205/3,969/5,045/5,853 lm	3CCT (3,500/4,000/5,000 K)	46-5/8" x 2-5/8" x 2-11/16"	12W Battery back-up
ASD-LSF5-8A90AC-EM-PRM	8 ft	48/68/90W	120-277 V	0-10 V	6,390/9,254/12,534 lm	3CCT (3,500/4,000/5,000 K)	92-13/16" x 2-5/8" x 2-11/16"	15W Battery back-up
<b>LSF5-MS STAIRWELL WITH MOTION SENSOR</b>								
ASD-LSF5-2A28AC-MS-SW	2 ft	20/24/28W	120-277 V	0-10 V	2,646/3,325/3,890 lm	3CCT (3,500/4,000/5,000 K)	26-3/16" x 2-5/8" x 2-11/16"	Motion sensor
ASD-LSF5-4A44AC-MS-SW	4 ft	22/28/36/44W	120-277 V	0-10 V	3,205/3,969/5,045/5,853 lm	3CCT (3,500/4,000/5,000 K)	46-5/8" x 2-5/8" x 2-11/16"	Motion sensor
<b>LSF5-EM-MS STAIRWELL WITH MOTION SENSOR AND BATTERY BACK-UP</b>								
ASD-LSF5-4A44AC-12EM-MS-SW	4 ft	22/28/36/44W	120-277 V	0-10 V	3,205/3,969/5,045/5,853 lm	3CCT (3,500/4,000/5,000 K)	46-5/8" x 2-5/8" x 2-11/16"	12W Battery back-up, Motion sensor
ASD-RC-RC100	Remote controller for motion sensor						4-7/8" x 2-3/4" x 3/4"	-

For most up-to-date spec sheets please refer to [asd-lighting.com](http://asd-lighting.com)

**ASD LIGHTING CORP**

E-mail: [orders@asd-lighting.com](mailto:orders@asd-lighting.com) | Web site: [www.asd-lighting.com](http://www.asd-lighting.com)





# LED STRIPLIGHT AND STAIRWELL FIXTURE

## PRODUCT SPECIFICATIONS:

Construction & Materials			Electrical system	
Housing	Metal		Input voltage	120-277 V
Lens	PMMA		Max input current	for 2ft: 0.26 A
Finish	White			for 4ft: 0.41 A
Weight	ASD-LSF5-2A28AC-PRM	4.5 lbs (2 kg)		for 8ft: 0.8 A
	ASD-LSF5-4A44AC-PRM	4 lbs (1.8 kg)	Inrush current (Action time)	for 2 and 4ft: 50 A (1 S)
	ASD-LSF5-8A90AC-PRM	9 lbs (4.1 kg)		for 8ft: 55 A (1 S)
	ASD-LSF5-2A28AC-4EM-PRM	5 lbs (2.3 kg)	Off state power	0W
	ASD-LSF5-4A44AC-12EM-PRM		Power consumption	for 2ft: 20/24/28W
	ASD-LSF5-8A90AC-EM-PRM	for 4ft: 22/28/36/44W		
	ASD-LSF5-2A28AC-MS-SW	4.7 lbs (2.1 kg)		for 8ft: 48/68/90W
	ASD-LSF5-4A44AC-MS-SW	4.1 lbs (1.9 kg)	Power factor	> 0.9
ASD-LSF5-4A44AC-12EM-MS-SW	5.1 lbs (2.3 kg)	Output voltage	42 V	
Environmental system			Max output current	for 2ft: 0.45 A/0.55 A/0.65 A
Work environment	Suitable for Damp Locations			for 4ft: 0.5 A/0.6 A/0.8 A/1 A
Operating temperature	-4°F to 104°F (-20°C to 40°C)			for 8ft: 1.15 A/1.5 A/2 A
L-70 Life	R > 54,000 hrs; C > 174,000 hrs		Surge protection DM/CM	1 kV / 2 kV
Optical system				
Luminous flux	ASD-LSF5-2A28AC-PRM	2,646/3,325/3,890 lm		
	ASD-LSF5-4A44AC-PRM	3,205/3,969/5,045/5,853 lm		
	ASD-LSF5-8A90AC-PRM	6,390/9,254/12,534 lm		
	ASD-LSF5-2A28AC-4EM-PRM	2,646/3,325/3,890 lm		
	ASD-LSF5-4A44AC-12EM-PRM	3,205/3,969/5,045/5,853 lm		
	ASD-LSF5-8A90AC-EM-PRM	6,390/9,254/12,534 lm		
	ASD-LSF5-2A28AC-MS-SW	2,646/3,325/3,890 lm		
	ASD-LSF5-4A44AC-MS-SW	3,205/3,969/5,045/5,853 lm		
	ASD-LSF5-4A44AC-12EM-MS-SW			
Color temperature	3CCT (3,500/4,000/5,000 K)			
CRI	> 80			
Dimming compatible controls *				
Brand	Leviton	Lutron	Legrand	
Models	DS710	NTSTV-DV	NFTV	H4FBL3PW
	IP710	DVTV-WH		
Regular and voluntary certifications				
5-year limited warranty				
DesignLights Consortium (DLC) listed (Classification: Standard series)				
Main: Indoor/outdoor luminaires; General application: Linear ambient/Low output/Mid output;				
Primary use: Direct linear ambient/Stairwell and passageway luminaires				
UL certified E473804				

## PACKAGE CONTENTS:

Description	Q-ty
LED Striplight and Stairwell Fixture	1
V Hook (A)	2
J-box mounting plate (B)	2
Box	1

A

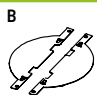
B

## ACCESSORIES

(sold separately):

**Connection bracket**  
ASD-CB-LSF5



**Wire guard**  
ASD-WG4-LSF5



## ACCESSORY COMPATIBILITY LIST:

Accessories	Connection bracket ASD-CB-LSF5	Wire guard ASD-WG4-LSF5
Models		

\* The list of dimmers is relevant for models without a motion sensor.

## PACKAGE CONTENTS:

Description	Q-ty
LED Striplight and Stairwell Fixture	1
V Hook (A)	2
J-box mounting plate (B)	2
Box	1

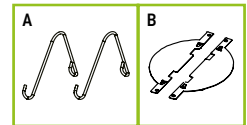

## ACCESSORIES (sold separately):

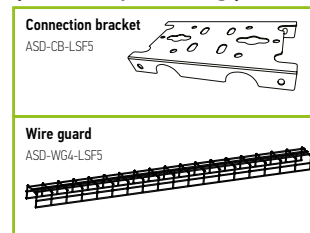

## ACCESSORY COMPATIBILITY LIST:

Accessories		Connection bracket ASD-CB-LSF5	Wire guard ASD-WG4-LSF5
Models			
ASD-LSF5	2 ft	•	
	4 ft	•	•
	8 ft	•	

For most up-to-date spec sheets please refer to [asd-lighting.com](http://asd-lighting.com)

ASD LIGHTING CORP

E-mail: [orders@asd-lighting.com](mailto:orders@asd-lighting.com) | Web site: [www.asd-lighting.com](http://www.asd-lighting.com)





# LED STRIPLIGHT AND STAIRWELL FIXTURE

## BUILT-IN MOTION SENSOR INFORMATION

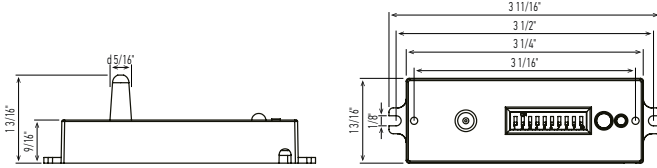

### SENSOR SETTING:

Please follow the additional motion sensor manual to set up your motion sensor.



Specifications	Model: ANT-8A
Power supply	12-24 V DC
HF system	5.8 GHz $\pm$ 75 MHz
Dim control output	0-10 V, max. 25 mA sinking current
Detection radius/angle	Max 26ft (8 m) / 360°
Mounting height	Max 12 ft (3.7 m)
Remote range	50 ft (15 m) indoor, no backlight
Humidity	Max 95% RH
Temperature	-40°F ~ 158°F (-40°C ~ 70°C)

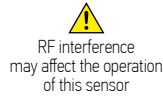

### DEFAULT SETTING:

Detection area	Hold time	Daylight sensor	Stand-by period	Stand-by dim level
100 %	5 min	Disable	Disable	0 %

Detection area, hold time, stand-by period, stand-by DIM level and daylight sensor can be set by using DIP switches on the sensor. Note that reducing the detection area will also reduce the sensitivity.

ON	1	2	
I	-	-	20%
II	-	ON	50%
III	ON	-	75%
IV	ON	ON	100%

ON	3	4	
I	-	-	10s
II	-	ON	1min
III	ON	-	5min
IV	ON	ON	15min

ON	5	6	
I	-	-	-
II	-	ON	10 Lx (0.9 Fc)
III	ON	-	30 Lx (2.8 Fc)
IV	ON	ON	50 Lx (4.7 Fc)

ON	7	8	
I	-	-	0 %
II	-	ON	10 %
III	ON	-	30 %
IV	ON	ON	50 %

ON	9	10	
I	-	-	+ $\infty$
II	-	ON	1 min
III	ON	-	30 min
IV	ON	ON	60 min

#### Detection Range:

Detection range is the term used to describe the radii of the detection zone produced on the ground after mounting the sensor light at a height of 8-20ft.

#### Hold time:

The light can be set to stay ON for any period of time between approx. 10sec and a maximum of 15min. Any movement detected before this time elapses will restart the timer. It is recommended to select the shortest time for adjusting the detection zone and for performing the walk test.

#### Daylight sensor:

The chosen light response threshold can be infinitely from approx.

#### Stand-by dimming level:

This is the preset dimming level you would like to have after the hold time in the long absence of people.

#### Stand-by period:

Refers to the time period the lamp remains at a preset dimming level before it completely switches off in the long absence of people.

## REMOTE CONTROLLER ASD-RC-RC100 sold separately:

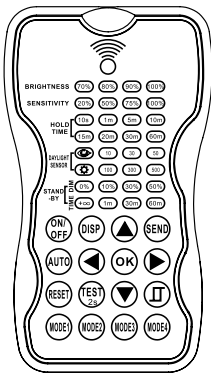

Specifications					
Power supply		Communication		Upload range	Op. temperature
2 x AAA 1.5 V battery, alkaline preferred		940 nm Infrared Tx & Rx		Up to 50 ft. (15 m)	32°F ~ 122°F (0°C ~ 50°C)
				Dimensions	
				4.84" x 2.76" x 0.8" (123 x 70 x 20.3 mm)	
Button	Description	Button	Description	Button	Description
ON/OFF	Press the "ON/OFF" button: the light goes to constant on/off mode, and the sensor is disabled. (MUST press "Auto" button to quit this mode).	▲ ▼	Enter in the setting condition, and press up or down to select parameters in LED indicators.	AUTO	Press "Auto" button: the sensor starts to function and all settings remain the same as the latest status before the light is switched on/off.
DISP	Display the current/ latest setting parameters in LED indicators (the LED indicators will turn on, showing the setting parameters).	◀ ▶	Navigate to LEFT and RIGHT to select parameters in LED indicators.	TEST	The button "TEST" is for testing sensitivity only. After you choose sensitivity thresholds, press the "TEST" button. The sensor goes to test mode (hold time is only 2s) automatically, meanwhile the stand-by period and daylight sensor are disabled. Press "AUTO" button to quit this mode.
RESET	Press "RESET" button: all settings go back to settings of dip switch in sensor.	OK	Keep records of selected parameters in remote control or in mode 1, mode 2, mode 3, or mode 4.	TEST 2s	
		SEND	Upload the selected parameters to sensors.		
		MODE1 MODE2 MODE3 MODE4	4 scene modes with preset parameters which can be changed and saved in modes.		

For most up-to-date spec sheets please refer to [asd-lighting.com](http://asd-lighting.com)



# LED STRIPLIGHT AND STAIRWELL FIXTURE

## BUILT-IN BACK-UP BATTERY INFORMATION

- ▶ Standard CSA C22.2 NO.141, UL924
- ▶ Battery Back-up Lithium Battery
- ▶ Battery Protection: over-charge, over-discharge and short circuit protection
- ▶ The wall switch only controls the main power, it does not affect emergency function.
- ▶ Indicator light modes: Red light ON – the emergency driver is charging in standby mode; Red light OFF – AC power is out, the emergency driver works in emergency mode.
- ▶ Press Test button and release to cut the power to the AC driver and switch the system to emergency mode. The Red light will turn off, and the fixture will decrease in light amount. The system will come back to normal AC mode after about 3 seconds.
- ▶ Batteries Meet 500 cycles of standard CH and standard DCH.
- ▶ RoHS compliant

**AC Operation:** When AC power is present, the LED load from the LED driver is the normal power supply, AC LED driver output current cannot exceed 150W or 4A (2A for 2ft model). The emergency driver will be charging in standby mode as indicated by the red LED light.

**Emergency operation:** When the AC power goes out, the emergency driver detects the AC power outage and automatically switches to the working emergency mode. The red LED light will be off. When the AC power is restored, the emergency driver switches back to AC power and starts re-charging. The red LED light will then turn back on. For 4ft: In emergency mode, press three-seconds (3S) the test switch to turn off the current emergency state. For 2ft: In Emergency mode, double-click the test button, to turn off the emergency mode.

### ⚠ WARNING

- ▶ This product should be installed by a qualified electrician. Connecting wires when power is on is not allowed. Power can be turned on after making sure that there is no phenomenon of short circuit and the connection is ok.

Model	Battery capacity	Max emergency output power	Battery back up current	Battery back up operation time	Battery voltage	Lumens
ASD-LSF5-2A28AC-4EM-PRM	2,500 mAh	4W	250 mA	≥ 90 minutes	3.7 V	720 lm
ASD-LSF5-4A44AC-12EM-PRM	2,500 mAh	12W	250 mA	≥ 90 minutes	11.1 V	1,950 lm
ASD-LSF5-4A44AC-12EM-MS-SW	2,500 mAh	12W	250 mA	≥ 90 minutes	11.1 V	1,950 lm
ASD-LSF5-8A90AC-EM-PRM	3,000 mAh	15W	250 mA	≥ 90 minutes	9.6 V	2,400 lm

## INSTALLATION GUIDE

### IMPORTANT SAFETY INFORMATION:

Please read all the instructions below before installation.

- ▶ Make sure that the supply voltage corresponds to the rated product voltage.
- ▶ The product must be installed by a qualified electrician in accordance with the National Electrical Code and corresponding local codes.
- ▶ If the product is damaged, do not use it.

### ⚠ WARNING

**RISK OF PERSONAL INJURY – READ and follow all WARNINGS and installation instructions.** Keep or give to the owner for future reference.

**Risk of cuts:** Wear gloves to prevent cuts or abrasions when removing from carton, handling, installing, and maintaining this product.

**Risk of electric shock:** This product must be installed in accordance with the applicable installation code by a person familiar with the construction and operation of the product and the hazards involved.

**Risk of Fire:** Minimum 194°F supply conductors. Consult a qualified electrician to ensure correct branch circuit conductor.

ASD® assumes no responsibility for claims arising out of improper or careless Installation or handling of this product.

### ELECTRICAL SCHEMATIC DIAGRAM:

#### LSF5



#### LSF5 multiple fixture connection

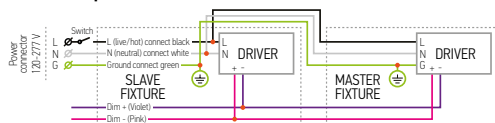

#### LSF5-MS with motion sensor

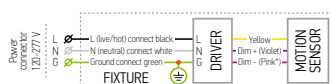

#### LSF5-MS with motion sensor multiple fixture connection

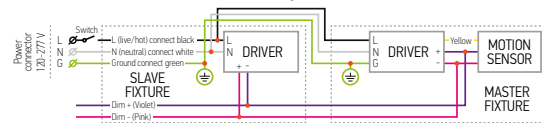

#### LSF5-EM with battery back-up

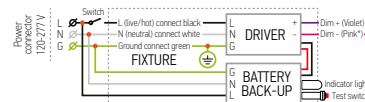

#### LSF5-EM with battery back-up multiple fixture connection

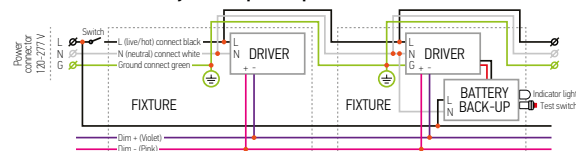

#### LSF5-EM with battery back-up and motion sensor

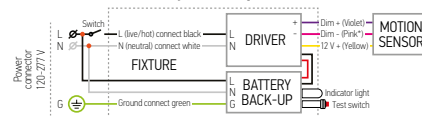

#### LSF5-MS-EM with motion sensor and battery back-up multiple fixture connection

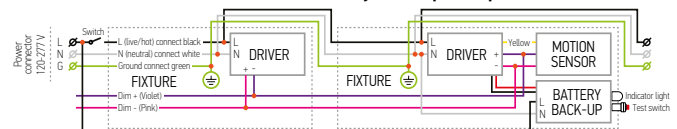

\* Pink or grey.

Multiple fixtures with different sizes and wattages can be linked together, the total wattage must not exceed 750W (120 V)/1750W (277 V).

Recommended wire thickness should not exceed 18AWG.

For most up-to-date spec sheets please refer to [asd-lighting.com](http://asd-lighting.com)



# LED STRIPLIGHT AND STAIRWELL FIXTURE

## SURFACE MOUNT INSTALLATION:

1. Lock the J-box mounting plate to the middle of the fixtures backplate. Open fixture, pass the wires through the hole on the back side of the fixture.
2. Affix the fixture's base to the ceiling using anchor screws (not included) and connect the wires: Black to Black, White to White, Green to Green. Then close the fixture back.

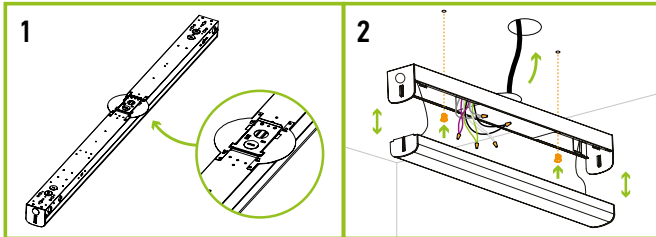

## CHAIN MOUNT INSTALLATION:

1. Insert chain on each hook and insert the hook into the installation holes. Attach the chain to the ceiling and adjust until balanced and secure.
2. Connect wires from fixture to power supply. Contain wires in metal or plastic wire hose.

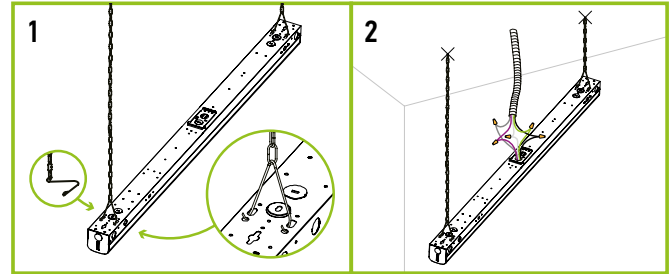

## WIRE GUARD INSTALLATION ASD-WG4-LSF5

**sold separately:**

1. Install the wire guard to the fixture.
2. Insert the provided chips (4 pcs) onto the wire guard.
3. Fasten the chips by drilling screws into the pre-punched holes of fixture body.

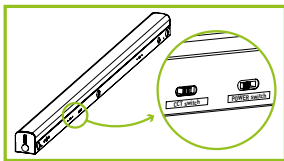
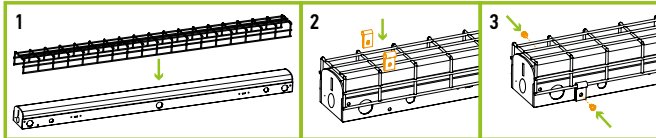

### Changing color temperature:

Change the position of the CT switch on the housing according to the required CT mode.

### Changing power mode:

Change the position of the power switch on the housing according to the required power mode.

## CONNECTING MULTIPLE FIXTURES

**ASD-CB-LSF5** sold separately:

1. Open the fixture and remove knockout according to your needs on side of the fixture. Feed the wires through the knockout hole and connect with fixture wires inside of the luminaire. If 0-10V dimming system is available, connect the purple and gray wires to the corresponding purple and gray wires in the built-in dimming system.

**CAUTION:** Customer supplied AC wire must be 16AWG.

2. If need to affix one fixture to another please use connection bracket (sold separately). Repeat the process for the next fixture.

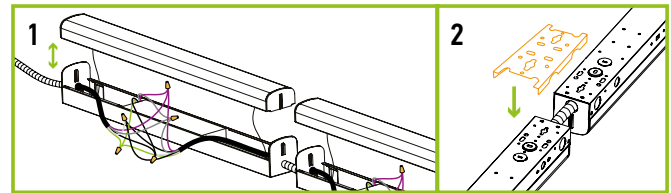

## ORDERING INFORMATION

Model	UPC	Pcs. per carton	Carton size	Carton weight	GTIN 14
ASD-LSF5-2A28AC-PRM	810050737975	8	27.8" x 12.5" x 6.7"	45.9 lbs	10810050737972
ASD-LSF5-4A44AC-PRM	810050730242	8	48.3" x 12.5" x 6.7"	39.8 lbs	10810050730249
ASD-LSF5-8A90AC-PRM	810050730273	4	94.6" x 6.4" x 6.7"	45.9 lbs	10810050730270
<b>LSF5-EM WITH BATTERY BACK-UP</b>					
ASD-LSF5-2A28AC-4EM-PRM	810050738514	8	27.8" x 12.5" x 6.7"	49.4 lbs	10810050738511
ASD-LSF5-4A44AC-12EM-PRM	810050736053	8	48.3" x 12.5" x 6.7"	47.1 lbs	10810050736050
ASD-LSF5-8A90AC-EM-PRM	810050730280	4	94.6" x 6.4" x 6.7"	47.8 lbs	10810050730287
<b>LSF5-MS STAIRWELL WITH MOTION SENSOR</b>					
ASD-LSF5-2A28AC-MS-SW	810050737982	8	27.8" x 12.5" x 6.7"	47.3 lbs	10810050737989
ASD-LSF5-4A44AC-MS-SW	810050730266	8	48.3" x 12.5" x 6.7"	40.1 lbs	10810050730263
<b>LSF5-EM-MS STAIRWELL WITH MOTION SENSOR AND BATTERY BACK-UP</b>					
ASD-LSF5-4A44AC-12EM-MS-SW	810050736060	8	48.3" x 12.5" x 6.7"	47.5 lbs	10810050736067
ASD-RC-RC100	819201023585	50	9.8" x 15.7" x 9.4"	14.3 lbs	10819201023582

## ACCESSORIES:

Model	Name	UPC	Pcs. per carton	Carton size	Carton weight	GTIN 14
ASD-CB-LSF5	Connection bracket	810050730747	100	14.3" x 5.7" x 8.1"	20.9 lbs	10810050730744
ASD-WG4-LSF5	Wire guard	819201027149	8	47.8" x 10.6" x 7.3"	14.3 lbs	10819201027146

For most up-to-date spec sheets please refer to [asd-lighting.com](http://asd-lighting.com)

**ASD LIGHTING CORP**

E-mail: [orders@asd-lighting.com](mailto:orders@asd-lighting.com) | Web site: [www.asd-lighting.com](http://www.asd-lighting.com)

