



# LED STRIPLIGHT FIXTURE

## Premium Series

ASD LED Strip-lights are the perfect replacement for an old, outdated fluorescent strip-light fixture. These fixtures are able to be surface, chain or pendant mounted and virtually eliminate maintenance as there no bulbs to change. Perfect for task lighting, workshops, retail stores, coves, storage area and more, they are available in 4" lengths

Catalog number	
Notes	
Type	

## FEATURES AND BENEFITS:

- ▶ 0-10V dimming standard
- ▶ No bulbs or ballasts to change
- ▶ Multiple fixture can be linked together
- ▶ Fixture may be surface, chain or pendant mounted
- ▶ Mounting hardware included
- ▶ Suitable for Damp location
- ▶ L70 life R > 54,000 hrs, C > 200, 000 hrs
- ▶ ETL certified
- ▶ DesignLights Consortium (DLC) listed (Classification: Premium)
- ▶ 5 Year warranty



## PRODUCT LEGEND:

Family	Modification	Size	Dimmable	Watts	CCT	Series
ASD-LSF	2	4	D	XX	XX	PRM
LED Striplight fixture		4 ft	Dimmable	24 = 24 W 40 = 40 W	40 = 4,000 K 50 = 5,000 K	Premium

## LED STRIPLIGHT FIXTURE:

Model	Type	Watts	Voltage	Dimming	CCT	Lumens	Dimensions (LxWxH)
ASD-LSF2-4D2440PRM	4 ft	24 W	120-277 V	0-10 V	4,000 K	3,000 lm	48 1/4" x 3 1/4" x 3 1/8"
ASD-LSF2-4D2450PRM	4 ft	24 W	120-277 V	0-10 V	5,000 K	3,080 lm	48 1/4" x 3 1/4" x 3 1/8"
ASD-LSF2-4D4040PRM	4 ft	40 W	120-277 V	0-10 V	4,000 K	5,060 lm	48 1/4" x 3 1/4" x 3 1/8"
ASD-LSF2-4D4050PRM	4 ft	40 W	120-277 V	0-10 V	5,000 K	5,060 lm	48 1/4" x 3 1/4" x 3 1/8"

## ORDERING INFORMATION:

Model	UPC	Pcs. per Carton	Carton Size	Carton Weight	GTIN 14
ASD-LSF2-4D2440PRM	819201020508	4	49.8 x 7.1" x 7.3"	24.3 lb	10819201020505
ASD-LSF2-4D2450PRM	819201022052	4	49.8 x 7.1" x 7.3"	24.3 lb	10819201022059
ASD-LSF2-4D4040PRM	819201020522	4	49.8 x 7.1" x 7.3"	24.3 lb	10819201020529
ASD-LSF2-4D4050PRM	819201023929	4	49.8 x 7.1" x 7.3"	24.3 lb	10819201023926

For most up-to-date spec sheets please refer to [asd-lighting.com](http://asd-lighting.com)

ASD LIGHTING CORP

E-mail: [orders@asd-lighting.com](mailto:orders@asd-lighting.com) | Web site: [www.asd-lighting.com](http://www.asd-lighting.com)





# LED STRIPLIGHT FIXTURE

Premium Series

## PRODUCT SPECIFICATIONS:

Construction & Materials	
Lens	Translucent white lens
Housing	Iron
Finish Color	White
Weight	4.85 lb (2.2 kg)
Environmental System	
Work Environment	Suitable for Damp Locations, IP20
Operating Temperature	-4°F to 131°F (-20°C to 55°C)
L-70 Life	R > 54,000 hrs, C > 200,000 hrs
Optical System	
Luminous Flux	ASD-LSF2-4D2440PRM 3,000 lm
	ASD-LSF2-4D2450PRM 3,080 lm
	ASD-LSF2-4D4040PRM 5,060 lm
	ASD-LSF2-4D4050PRM 5,060 lm
Color Temperature	4,000 K, 5,000 K
CRI	> 80
Electrical System	
Input Voltage	120-277 V
Max input current	ASD-LSF2-4D2440PRM 400 mA
	ASD-LSF2-4D2450PRM 400 mA
	ASD-LSF2-4D4040PRM 600 mA
	ASD-LSF2-4D4050PRM 600 mA
Inrush current (Action time)	ASD-LSF2-4D2440PRM 30 A (1 S)
	ASD-LSF2-4D2450PRM 30 A (1 S)
	ASD-LSF2-4D4040PRM 40 A (1 S)
	ASD-LSF2-4D4050PRM 40 A (1 S)
AC input range	min 90 V max 300 V
Off State Power	0 W
Power Consumption	ASD-LSF2-4D2440PRM 24 W
	ASD-LSF2-4D2450PRM 24 W
	ASD-LSF2-4D4040PRM 40 W
	ASD-LSF2-4D4050PRM 40 W
Power Factor	≥ 0.9
Output voltage	18-40 V
Max output current	ASD-LSF2-4D2440PRM 600 mA
	ASD-LSF2-4D2450PRM 600 mA
	ASD-LSF2-4D4040PRM 1 A
	ASD-LSF2-4D4050PRM 1 A
LED driver class	Class 2
Dimming compatible controls	
Brand	Lutron
Models	DVSTV-WH NFTV-WH DS710-102 DD710-BLZ
Regular and Voluntary Certifications	
5-year limited warranty	
DesignLights Consortium (DLC) listed (Classification: Premium)	
Main: Indoor Luminaires; General Application: Linear Ambient;	
Primary Use: Direct Linear Ambient Luminaires	
Certification ETL (only for model - ASD-LSF2-4D4040PRM)	

## PACKAGE CONTENTS:

Description	Q-ty
LED Striplight Fixture	1
Bracket (A)	1
Chain mounting set with V-hooks (B)	1
Mounting plates (C)	2
Wire nuts (D)	5
Box	1
Cut sheet	1



## INSTALLATION GUIDE

### IMPORTANT SAFETY INFORMATION:

Please read all the instructions below before installation.

- Make sure that the supply voltage corresponds to the rated product voltage.
- The product must be installed by a qualified electrician in accordance with the National Electrical Code and corresponding local codes.
- If the product is damaged, do not use it.

### ⚠ WARNING

**RISK OF PERSONAL INJURY – READ and follow all WARNINGS and installation instructions.** Keep or give to the owner for future reference.

**Risk of cuts:** Wear gloves to prevent cuts or abrasions when removing from carton, handling, installing, and maintaining this product.

**Risk of electric shock:** This product must be installed in accordance with the applicable installation code by a person familiar with the construction and operation of the product and the hazards involved.

**Risk of Fire:** Minimum 194°F supply conductors. Consult a qualified electrician to ensure correct branch circuit conductor.

ASD® assumes no responsibility for claims arising out of improper or careless Installation or handling of this product.

## ELECTRICAL SCHEMATIC DIAGRAM:

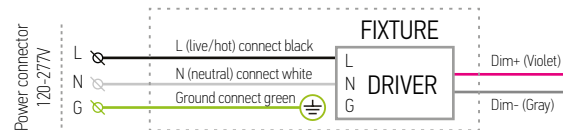

## ELECTRICAL SCHEMATIC DIAGRAM FOR CONNECTING MULTIPLE FIXTURES:

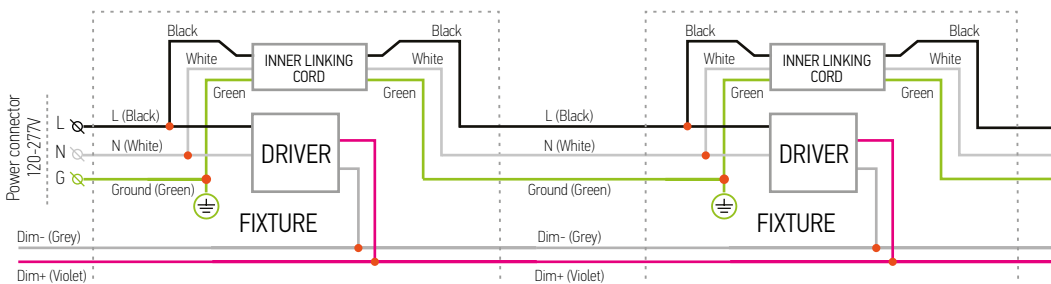

For most up-to-date spec sheets please refer to [asd-lighting.com](http://asd-lighting.com)

ASD LIGHTING CORP

E-mail: [orders@asd-lighting.com](mailto:orders@asd-lighting.com) | Web site: [www.asd-lighting.com](http://www.asd-lighting.com)





# LED STRIPLIGHT FIXTURE

Premium Series

## INSTALLATION OPTIONS:

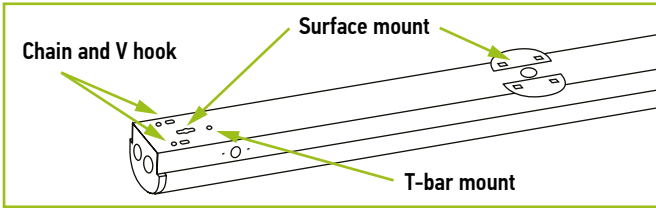

## CHAIN AND V HOOK MOUNTING:

1. Insert a chain on each hook and insert the hook into the installation hole. Attach the chain to the ceiling and adjust until balanced and secure.
2. Take wires from the shielded cable and connect them: Black to Black, White to White, Green to Green.

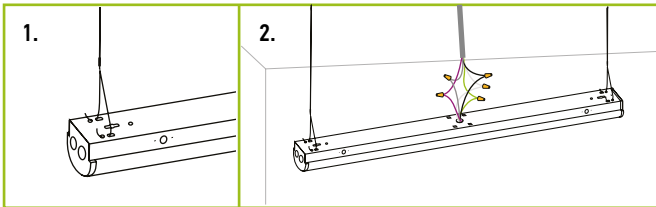

## SURFACE MOUNTING:

1. Lock the mounting plate.
2. Connect the wires: Black to Black, White to White, Green to Green.
3. Lift the fixture and put wires in existing ceiling junction box. Secure fixture to ceiling.

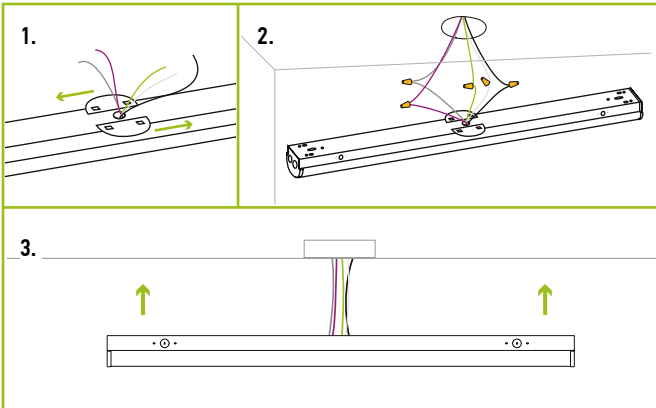

## T-BAR CLIP INSTALLATION HOLE:

1. Attach the fixture to the T-Bar ceiling grid with your existing T-Bar clips (not included).
2. Refer to the diagram at the top of the page.

## CONNECTING MULTIPLE FIXTURES:

1. Remove the PC cover and PCB plate.
2. Attach compression fitting (not included).
3. Feed through the knockout hole and connect: Black to Black, White to White, Green to Green. Repeat the process for the next fixture. Affix back the PCB plate and PC cover.
4. Use the connection bracket to secure one fixture to another.

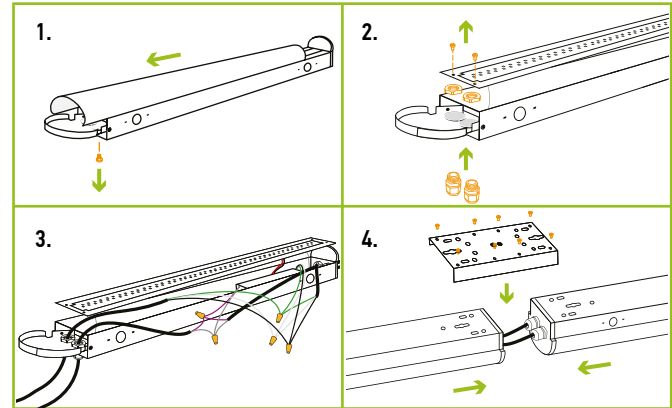

## LINKING LIMITS:

Model	Linkable Quantities Depending on Voltage		
	110 V	200 V	277 V
24 W	18 pcs	32 pcs	50 pcs
40 W	11 pcs	20 pcs	27 pcs

For most up-to-date spec sheets please refer to [asd-lighting.com](http://asd-lighting.com)

ASD LIGHTING CORP

E-mail: [orders@asd-lighting.com](mailto:orders@asd-lighting.com) | Web site: [www.asd-lighting.com](http://www.asd-lighting.com)

