





LED TRADITIONAL WALLPACK

► **DESIGN & OPTIONS** - LED TRADITIONAL WALLPACK has durable, commercial-grade die-cast aluminum housing, maintenance-free LEDs, and anti-leakage silicone gaskets. They also features an anti-glare glass shield with high temperature resistance, guaranteeing high illuminance and great transparency. This fixture comes in 120-277V with a 0-10V dimmable driver, and a 5,000K color temperature with a BRONZE finish.

 **Models with CCT adjustable** option can be set to either 3,000K, 4,000K, or 5,000K with a simple switch.

 **The PC** automatically turn on/off depending on the time of day.

 **Models with a built-in battery back-up** provide 90 minutes of power in case of emergency.

► **INSTALLATION** - The housing features a removable hinge door and multiple points of entry, making installation quick and easy. The fixture can be mounted to a junction box or directly to a wall. Refer to installation instructions for detailed steps.

► **APPLICATION** - These fixtures can operate in temperatures between -40°+122°F (-40°+50°C), allowing them to be utilized in a wide variety of applications and climates. This makes them perfect for outdoor security lighting, wall perimeter lighting, garages, large backyards, commercial loading bays, warehouses, apartment complexes, hotels, and office/retail complexes.

► **ENERGY SAVING & EFFICIENCY** - This fixture provides a lumen output equal to MH/HPS and can cut your electric bill by up to 80% instantly. With a lifespan of 72,000 hours, these fixtures are made to last decades under normal operation! This fixture will save you a significant amount of money in its lifetime.

► **CERTIFICATION & WARRANTY** - Buy with confidence: ASD provides a 5-year warranty along with UL and DLC Premium certifications to guarantee top quality products and safety!

Top US certifications allow participation in rebates; please check the rebate programs available in your state.

Catalog number	
Notes	
Type	

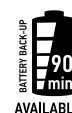

LED TRADITIONAL WALLPACK:

Model	Watts	Voltage	Dimmable	Lumens	CCT	Option	Dimensions (LxWxH)
ASD-WLP01S-50D50	50 W	120-277 V	1-10 V	7,987 lm	5,000 K	-	10 1/4" x 9 1/2" x 7 1/2"
ASD-WLP01-50D50	50 W	120-277 V	0-10 V	7,878 lm	5,000 K	-	14 1/4" x 9 5/16" x 7 9/16"
ASD-WLP01-80D50	80 W	120-277 V	0-10 V	11,874 lm	5,000 K	-	14 1/4" x 9 5/16" x 7 9/16"
ASD-WLP01-120D50	120 W	120-277 V	0-10 V	17,443 lm	5,000 K	-	14 1/4" x 9 5/16" x 7 9/16"
ASD-WLP01S-30DAC	30 W	120-277 V	1-10 V	4,500/4,890/4,834 lm	3CCT (3,000/4,000/5,000 K)	-	10 1/4" x 9 1/2" x 7 1/2"
ASD-WLP01S-50DAC	50 W	120-277 V	1-10 V	7,500/7,230/7,282 lm	3CCT (3,000/4,000/5,000 K)	-	10 1/4" x 9 1/2" x 7 1/2"
ASD-WLP01-50DAC	50 W	120-277 V	1-10 V	7,250/7,719/7,773 lm	3CCT (3,000/4,000/5,000 K)	-	14 1/4" x 9 5/16" x 7 9/16"
ASD-WLP01-80DAC	80 W	120-277 V	1-10 V	11,680/12,174/11,956 lm	3CCT (3,000/4,000/5,000 K)	-	14 1/4" x 9 5/16" x 7 9/16"
ASD-WLP01-120DAC	120 W	120-277 V	1-10 V	17,050/17,703/17,633 lm	3CCT (3,000/4,000/5,000 K)	-	14 1/4" x 9 5/16" x 7 9/16"
WLP01-EM WITH BATTERY BACK-UP							
ASD-WLP01-50DAC-EM	50 W	120-277 V	1-10 V	7,250/7,719/7,773 lm	3CCT (3,000/4,000/5,000 K)	8 W Battery back-up	14 1/4" x 9 5/16" x 7 9/16"
ASD-WLP01-80DAC-EM	80 W	120-277 V	1-10 V	11,680/12,174/11,956 lm	3CCT (3,000/4,000/5,000 K)	15 W Battery back-up	14 1/4" x 9 5/16" x 7 9/16"

PRODUCT SPECIFICATIONS:

Construction & Materials							
Lens	Glass						
Housing	Die-Cast Aluminum						
Finish	Bronze						
Weight	ASD-WLP01S-50D50	5.3 lb (2.4 kg)	ASD-WLP01S-30DAC	5.3 lb (2.4 kg)	ASD-WLP01-120DAC	9.4 lb (4.3 kg)	
	ASD-WLP01-50D50	7.9 lb (3.6 kg)	ASD-WLP01S-50DAC	5.5 lb (2.5 kg)	ASD-WLP01-50DAC-EM	9.1 lb (4.2 kg)	
	ASD-WLP01-80D50	8.2 lb (3.7 kg)	ASD-WLP01-50DAC	8 lb (3.7 kg)	ASD-WLP01-80DAC-EM	9.4 lb (4.3 kg)	
	ASD-WLP01-120D50	9.3 lb (4.2 kg)	ASD-WLP01-80DAC	8.3 lb (3.8 kg)			
Environmental System							
Work Environment	Suitable for Wet Locations, IP65						
Operating Temperature	-40°F to 122°F (-40°C to 50°C)						
L-70 Life	R > 72,000 hrs; C > 145,000 hrs						

For most up-to-date spec sheets please refer to asd-lighting.com

ASD LIGHTING CORP

E-mail: orders@asd-lighting.com | Web site: www.asd-lighting.com





LED TRADITIONAL WALLPACK

Optical System						
Luminous Flux	ASD-WLP01S-50D50	7,987 lm	ASD-WLP01S-30DAC	4,500/4,890/4,834 lm	ASD-WLP01-120DAC	17,050/17,703/17,633 lm
	ASD-WLP01-50D50	7,878 lm	ASD-WLP01S-50DAC	7,500/7,230/7,282 lm	ASD-WLP01-50DAC-EM	7,250/7,719/7,773 lm
	ASD-WLP01-80D50	11,874 lm	ASD-WLP01-50DAC	7,250/7,719/7,773 lm	ASD-WLP01-80DAC-EM	11,680/12,174/11,956 lm
	ASD-WLP01-120D50	17,443 lm	ASD-WLP01-80DAC	11,680/12,174/11,956 lm		
Color Temperature	ASD-WLP01S-50D50	5,000 K	ASD-WLP01S-30DAC	3CCT (3,000K/4,000 K/5,000K)	ASD-WLP01-120DAC	3CCT (3,000K/4,000 K/5,000K)
	ASD-WLP01-50D50		ASD-WLP01S-50DAC		ASD-WLP01-50DAC-EM	
	ASD-WLP01-80D50		ASD-WLP01-50DAC		ASD-WLP01-80DAC-EM	
	ASD-WLP01-120D50		ASD-WLP01-80DAC			
CRI	> 70					
Electrical System						
Input Voltage	120-277 V					
Max input current	ASD-WLP01S-50D50	0.55 A	ASD-WLP01S-30DAC	0.33 A	ASD-WLP01-120DAC	1.2 A
	ASD-WLP01-50D50		ASD-WLP01S-50DAC	0.55 A	ASD-WLP01-50DAC-EM	0.55 A
	ASD-WLP01-80D50	0.8 A	ASD-WLP01-50DAC		0.8 A	ASD-WLP01-80DAC-EM
	ASD-WLP01-120D50	1.05 A	ASD-WLP01-80DAC	0.8 A		
Inrush current (Action time)	80 A (0.75 S)					
AC input range	min 108V max 305V					
Off State Power	0 W					
Power Consumption	ASD-WLP01S-50D50	50 W	ASD-WLP01S-30DAC	30 W	ASD-WLP01-120DAC	120 W
	ASD-WLP01-50D50		ASD-WLP01S-50DAC	50 W	ASD-WLP01-50DAC-EM	50 W
	ASD-WLP01-80D50	80 W	ASD-WLP01-50DAC		80 W	ASD-WLP01-80DAC-EM
	ASD-WLP01-120D50	120 W	ASD-WLP01-80DAC	80 W		
Power Factor	> 0.9					
Output voltage	ASD-WLP01S-50D50	110-130 V	ASD-WLP01S-30DAC	110-130 V	ASD-WLP01-120DAC	110-130 V
	ASD-WLP01-50D50	130 V	ASD-WLP01S-50DAC		ASD-WLP01-50DAC-EM	105-125 V
	ASD-WLP01-80D50		ASD-WLP01-50DAC		ASD-WLP01-80DAC-EM	110-130 V
	ASD-WLP01-120D50		ASD-WLP01-80DAC			
Max output current	ASD-WLP01S-50D50	390 mA	ASD-WLP01S-30DAC	230 mA	ASD-WLP01-120DAC	920 mA
	ASD-WLP01-50D50		ASD-WLP01S-50DAC	390 mA	ASD-WLP01-50DAC-EM	390 mA
	ASD-WLP01-80D50	620 mA	ASD-WLP01-50DAC		620 mA	ASD-WLP01-80DAC-EM
	ASD-WLP01-120D50	920 mA	ASD-WLP01-80DAC	620 mA		
Surge protection	4 kV					
LED Driver Class	ASD-WLP01S-50D50	Non-Isolated Class P	ASD-WLP01S-30DAC	Non-Isolated Class P	ASD-WLP01-120DAC	Non-Isolated Class P
	ASD-WLP01-50D50	Class 1	ASD-WLP01S-50DAC		ASD-WLP01-50DAC-EM	
	ASD-WLP01-80D50		ASD-WLP01-50DAC		ASD-WLP01-80DAC-EM	
	ASD-WLP01-120D50		ASD-WLP01-80DAC			
Dimming compatible controls						
Brand	Maxxima	Eaton	Keygma	Leviton	Lutron	
Models	MEW-DM600LV	DF10P-C1	KGM-1A010V	IP710-DLZ	DVSTV-WH	

Warranty & Certifications	
5-year limited warranty	
UL certified E473804	
DesignLights Consortium (DLC) listed (Classification: Premium)	
Main: Outdoor Luminaires;	
General Application: Mid/High Output;	
Primary Use: Outdoor Non-Cutoff and Semi-Cutoff Wall-Mounted Area Luminaires	

PACKAGE CONTENTS:

Description	Q-ty
LED Traditional Wallpack	1
Box	1
Cut sheet	2

ACCESSORIES (SOLD SEPARATELY):

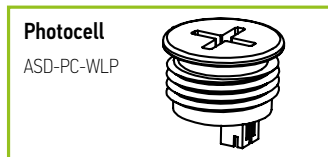

PHOTOCELL SETTINGS:



The built-in dusk-to-dawn photocell automatically turns the fixture off during daylight hours.

- The light is always ON when luminance is < 30 Lx (2.8 Fc) (night time)
- The light is always OFF when luminance is > 60 Lx (5.6 Fc) (day time)

For most up-to-date spec sheets please refer to asd-lighting.com

ASD LIGHTING CORP

E-mail: orders@asd-lighting.com | Web site: www.asd-lighting.com







LED TRADITIONAL WALLPACK

BATTERY BACK-UP INFORMATION

Specifications	Model BLD-CM20H-1500400
Input Voltage	100-277 V 50/60 Hz
Warranty	5 Years
Indicator Light	Illuminated test switch, indicator light
Battery type	Li-ion
Battery Charging Current	250 mA
Charging Time	≥ 24 Hours

Model	Battery capacity	Max emergency output power	EM lumens	Emergency current	Emergency operation time	Battery voltage	Full charge/discharge cycles
ASD-WLP01-50DAC-EM	2,500mA * 4	8 W	1,246 lm	70 mA	≥ 90 minutes	7.4 V	500 cycles
ASD-WLP01-80DAC-EM	3,000mA * 6	15 W	2,301 lm	125 mA	≥ 90 minutes	11.1 V	500 cycles

STANDARD OPERATION DISPLAY STATUS:

Charging	
Emergency mode	

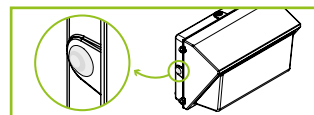

Indicator light modes:

- Green light ON – the battery back-up is charging in standby mode;
- Green light OFF – AC power is out, the battery back-up is working in emergency mode.

Test button operation: Press the test button to switch the system to back-up mode. The green light will turn off, and the fixture will decrease in light amount. Release test button to go back to the normal mode

INSTALLATION GUIDE

IMPORTANT SAFETY INFORMATION:

Please read all the instructions below before installation.

- ▶ Make sure that the supply voltage corresponds to the rated product voltage.
- ▶ The product must be installed by a qualified electrician in accordance with the National Electrical Code and corresponding local codes.
- ▶ If the product is damaged, do not use it.

ELECTRICAL SCHEMATIC DIAGRAM:

WLP01

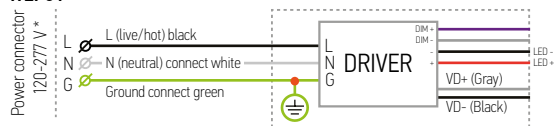

WLP01-AC with CCT

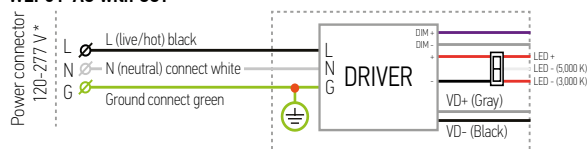

WLP01-EM with battery back-up

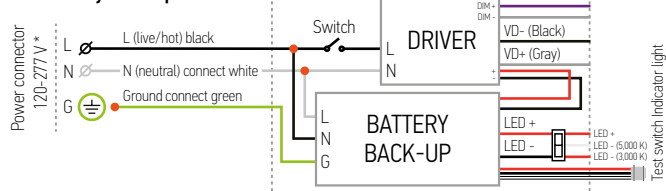

⚠ WARNING

RISK OF PERSONAL INJURY – READ and follow all WARNINGS and installation instructions.

Keep or give to the owner for future reference.

Risk of cuts: Wear gloves to prevent cuts or abrasions when removing from carton, handling, installing, and maintaining this product.

Risk of electric shock: This product must be installed in accordance with the applicable installation code by a person familiar with the construction and operation of the product and the hazards involved.

Risk of Fire: Minimum 194°F supply conductors. Consult a qualified electrician to ensure correct branch circuit conductor.

ASD® assumes no responsibility for claims arising out of improper or careless Installation or handling of this product.

WLP01-PC with photocell

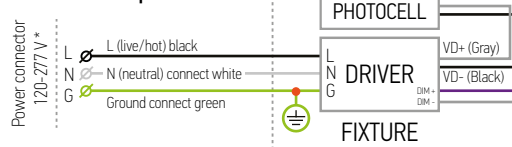

WLP01-EM-PC with battery back-up and photocell

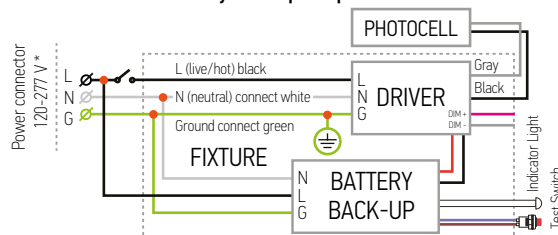

* The regular voltage 120-277V fixtures can be alternatively powered without neutral by two-phase circuit with phase-to-phase voltage of 208V (L1-120V & L2-120V).

WARNING: Phase-to-phase voltage should be less than 277V (160V per each phase) and more than 120V (70V per each phase)! Do not confuse Regular Voltage fixtures of 120-277V with High Voltage ones of 277-480V!

For most up-to-date spec sheets please refer to asd-lighting.com



LED TRADITIONAL WALLPACK

INSTALLATION STEPS:

1. Use a screwdriver to loosen the screws securing the front cover and open the fixture.
2. **Junction box installation:** Drill the mounting holes and secure the fixture on the mounting surface, insert the power cord. Connect the wires: Black to Black, White to White, Green to Green. Close the front cover and tighten the screws.
3. **Wall installation:** Secure the fixture on the wall and remove one of the side caps, insert the power cord. Connect the wires: Black to Black, White to White, Green to Green. Close the front cover and tighten the screws. For outdoor locations it is recommended to use silicone (not included).

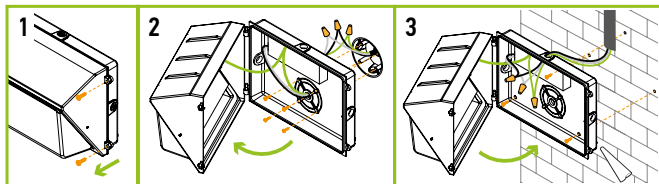

PHOTOCELL INSTALLATION

ASD-PC-WLP

sold separately:

1. Screw off knockout on the side of the fixture. Screw in the Photocell to the knockout hole.
2. Unscrew two screws on the side of the fixture, open the fixture, insert connector on black-grey wire to the photocell.
3. Close the fixture and tighten two screws back.

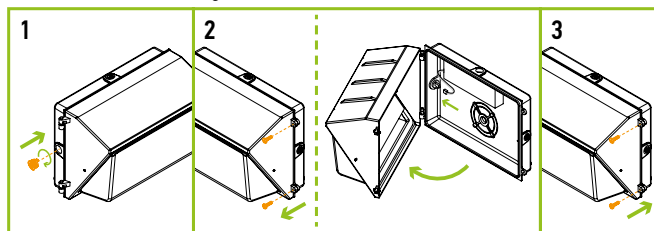

COLOR TEMPERATURE SETTINGS FOR 3CCT MODELS:

Choose needed color temperature by adjusting the switch.

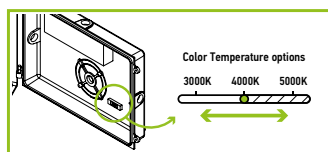

ORDERING INFORMATION

LED TRADITIONAL WALLPACK:

Model	Pcs. per Carton	Carton Size	Carton Weight	UPC
ASD-WLP01S-50D50	1	11.7" x 12.3" x 9.5"	10 lb	810050736220
ASD-WLP01-50D50	1	16.5" x 10.8" x 9.4"	9.9 lb	810050735742
ASD-WLP01-80D50	1	16.5" x 10.8" x 9.4"	10.1 lb	810050735759
ASD-WLP01-120D50	1	16.5" x 10.8" x 9.4"	11.2 lb	810050735766
ASD-WLP01S-30DAC	1	11.7" x 12.3" x 9.5"	6.8 lb	810050735803
ASD-WLP01S-50DAC	1	11.7" x 12.3" x 9.5"	7.1 lb	810050736985
ASD-WLP01-50DAC	1	16.5" x 10.8" x 9.4"	10 lb	810050735810
ASD-WLP01-80DAC	1	16.5" x 10.8" x 9.4"	10.3 lb	810050735827
ASD-WLP01-120DAC	1	16.5" x 10.8" x 9.4"	11.4 lb	810050735834
WLP01-EM WITH BATTERY BACK-UP				
ASD-WLP01-50DAC-EM	1	16.5" x 10.8" x 9.4"	11.1 lb	810050735780
ASD-WLP01-80DAC-EM	1	16.5" x 10.8" x 9.4"	11.4 lb	810050735797

ACCESSORIES:

Model	Name	Finish	Materials	Weight	Dimensions	UPC		
ASD-PC-WLP	Photocell for LED Wallpack	Clear	Plastic	0.009 lb	7/8" x 7/8" x 3/4"	810050735773		
Model	Pcs in middle box	Middle box Size	Middle box Weight	GTIN 14 for Middle box	Pcs. per Carton	Carton Size	Carton Weight	GTIN 14 in Carton
ASD-PC-WLP	100	5.1" x 4.1" x 10.2"	1.1 lb	10810050735770	1200	13" x 10.7" x 13.3"	13.2 lb	20810050735777

 For most up-to-date spec sheets please refer to asd-lighting.com