



LED UFO NSF HIGH BAY

► **DESIGN & OPTIONS** - NSF LED UFO HIGH BAY has best in class performance with a 150lm/W output. The fixtures feature a smooth dust-proof surface that can withstand frequent wash downs and is built with safety and sanitation in mind. It has an easy-to-clean, corrosion-resistant aluminum housing and comes with 120-277V and a 5,000K color temperature. It is equipped with a 0-10V dimmable driver and comes with a WHITE finish.



Models that are 277-480V are equipped with professional energy-efficient LED drivers to ensure high performance.



The battery back-up provides 90 minutes of power in case of emergency.

► **INSTALLATION** - This fixture comes with a stainless steel hanging ring for suspended mounting and with a 6.5ft cable to make the installation process easier. Refer to install instructions for detailed steps.

► **APPLICATION** - NSF LED UFO HIGH BAY fixtures are ideal for areas with high sanitation standards and are required to be frequently washed down. Common applications include: poultry processing, food & beverage processing, commercial kitchens, and manufacturing facilities. These fixtures are Wet location rated with IP69K ingress protection rating, meaning they are resistant to high pressure, temperature, water, and dust. These lights can operate in temperatures between -40+122°F (-40+50°C).

► **ENERGY SAVINGS & EFFICIENCY** - With a lifespan of 60,000 hours, these fixtures are made to last decades under normal operation! This fixture can cut your electric bill by up to 80% instantly and will save you a significant amount of money in its lifetime.

► **CERTIFICATION & WARRANTY** - Buy with confidence: ASD provides a 5-year warranty along with UL and DLC Premium certifications to guarantee top quality products and safety! Certified by the National Sanitation Foundation (NSF) as safe for food service processing facilities that require a higher level of sanitation.

Top US certifications allow participation in rebates; please check the rebate programs available in your state.

Catalog number	
Notes	
Type	



UHB-FS

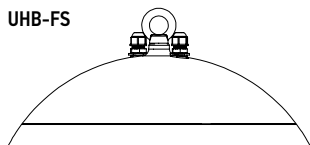

UHB2-FS

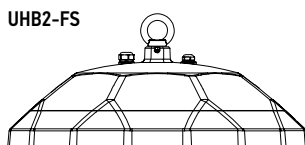

Model	Watts	Voltage	Dimmable	Lumens	CCT	Finish	Dimensions (LxWxH)	Cord
ASD-UHB-FS-100D50-PRM	100W	120-277 V	0-10 V	13,069 lm	5,000 K	White	13 3/8" x 13 3/8" x 4 3/4"	6.5 ft
ASD-UHB2-FS-150D50	150W	120-277 V	0-10 V	21,900 lm	5,000 K	White	17 1/8" x 17 1/8" x 7 11/16"	6.5 ft
ASD-UHB2-FS-200D50	200W	120-277 V	0-10 V	29,200 lm	5,000 K	White	17 1/8" x 17 1/8" x 7 11/16"	6.5 ft
UHB2HV-FS HIGH VOLTAGE								
ASD-UHB2HV-FS-150D50	150W	277-480 V	0-10 V	21,900 lm	5,000 K	White	17 1/8" x 17 1/8" x 7 11/16"	6.5 ft
ASD-UHB2HV-FS-200D50	200W	277-480 V	0-10 V	29,200 lm	5,000 K	White	17 1/8" x 17 1/8" x 7 11/16"	6.5 ft

PRODUCT SPECIFICATIONS:

Construction & Materials				
Housing	Die cast Aluminum			
Finish	White			
Weight	ASD-UHB-FS-100D50-PRM	12.8 lb (5.8 kg)	ASD-UHB2HV-FS-150D50	14.3 lb (6.5 kg)
	ASD-UHB2-FS-150D50	13.7 lb (6.2 kg)	ASD-UHB2HV-FS-200D50	17.2 lb (7.8 kg)
	ASD-UHB2-FS-200D50	15.9 lb (7.2 kg)		

For most up-to-date spec sheets please refer to asd-lighting.com

ASD LIGHTING CORP

E-mail: orders@asd-lighting.com | Web site: www.asd-lighting.com





LED UFO NSF HIGH BAY

Environmental System				
Work Environment	ASD-UHB-FS-100D50-PRM	Suitable for Wet Locations, IP65/69K	ASD-UHB2HV-FS-150D50	Suitable for Wet Locations, IP66/69K
	ASD-UHB2-FS-150D50		ASD-UHB2HV-FS-200D50	
	ASD-UHB2-FS-200D50			
Operating Temperature	ASD-UHB-FS-100D50-PRM	-40°F to 122°F (-40°C to 50°C)	ASD-UHB2HV-FS-150D50	-40°F to 113°F (-40°C to 45°C)
	ASD-UHB2-FS-150D50	-40°F to 113°F (-40°C to 45°C)	ASD-UHB2HV-FS-200D50	
	ASD-UHB2-FS-200D50			
L-70 Life	ASD-UHB-FS-100D50-PRM	R > 54,000 hrs; C > 372,000 hrs	ASD-UHB2HV-FS-150D50	R > 60,000 hrs; C > 132,000 hrs
	ASD-UHB2-FS-150D50	R > 60,000 hrs; C > 132,000 hrs	ASD-UHB2HV-FS-200D50	
	ASD-UHB2-FS-200D50			
Optical System				
Luminous Flux	ASD-UHB-FS-100D50-PRM	13,069 lm	ASD-UHB2HV-FS-150D50	21,900 lm
	ASD-UHB2-FS-150D50	21,900 lm	ASD-UHB2HV-FS-200D50	29,200 lm
	ASD-UHB2-FS-200D50	29,200 lm		
Color Temperature	5,000 K			
CRI	> 80			
Electrical System				
Input Voltage	Regular Voltage: 120-277 V		High Voltage: 277-480 V	
Max input current	ASD-UHB-FS-100D50-PRM	0.6 A	ASD-UHB2HV-FS-150D50	1.6 A
	ASD-UHB2-FS-150D50	1.25 A	ASD-UHB2HV-FS-200D50	1.8 A
	ASD-UHB2-FS-200D50	2.4 A		
Inrush current (Action time)	ASD-UHB-FS-100D50-PRM	35 A (1 S)	ASD-UHB2HV-FS-150D50	50 A (0.5 S)
	ASD-UHB2-FS-150D50	130 A (1 S)	ASD-UHB2HV-FS-200D50	
	ASD-UHB2-FS-200D50			
AC input range	Regular Voltage: min 90 V max 305 V		High Voltage: min 249 V max 528 V	
Off State Power	0W			
Power Consumption	ASD-UHB-FS-100D50-PRM	100W	ASD-UHB2HV-FS-150D50	150W
	ASD-UHB2-FS-150D50	150W	ASD-UHB2HV-FS-200D50	200W
	ASD-UHB2-FS-200D50	200W		
Power Factor	> 0.9			
Output voltage	ASD-UHB-FS-100D50-PRM	48 V	ASD-UHB2HV-FS-150D50	22-56 V
	ASD-UHB2-FS-150D50	180-260 V	ASD-UHB2HV-FS-200D50	
	ASD-UHB2-FS-200D50			
Max output current	ASD-UHB-FS-100D50-PRM	2.1 A	ASD-UHB2HV-FS-150D50	2.79 A
	ASD-UHB2-FS-150D50	0.6 A	ASD-UHB2HV-FS-200D50	3.71 A
	ASD-UHB2-FS-200D50	0.9 A		
Surge protection DM/CM	ASD-UHB-FS-100D50-PRM	4 kV / 6 kV	ASD-UHB2HV-FS-150D50	6 kV / 10 kV
	ASD-UHB2-FS-150D50		ASD-UHB2HV-FS-200D50	
	ASD-UHB2-FS-200D50			
LED driver class	ASD-UHB-FS-100D50-PRM	Class 2	ASD-UHB2HV-FS-150D50	Class P
	ASD-UHB2-FS-150D50	Class 1	ASD-UHB2HV-FS-200D50	
	ASD-UHB2-FS-200D50			

Dimming compatible controls				
Brand	Ltech	Lutron	Leviton	Rab
Models	E610P	NFTV	ZS057-DOZ	LCLC3/D10
Regular and Voluntary Certifications				
5-year limited warranty				
UL listed E473804				
ETL certified 4010110 (for model ASD-UHB-FS-100D50-PRM)				
DesignLights Consortium (DLC) listed (Classification: Premium)				
Main: Indoor Luminaires; General Application: High-Bay;				
Primary Use: High-Bay Luminaires for Commercial and Industrial Buildings				
National Sanitation Foundation				

PACKAGE CONTENTS:

Description	Q-ty
LED UFO NSF High Bay	1
Mounting ring (A)	1
Box	1
Cut sheet	2



ACCESSORIES (SOLD SEPARATELY):

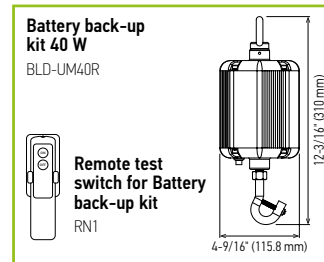

ACCESSORY COMPATIBILITY LIST:

Accessories	Battery back-up kit 40 W BLD-UM40R
Models	
ASD-UHB-FS-100D50-PRM	•
ASD-UHB2-FS-150D50	•
ASD-UHB2-FS-200D50	•
ASD-UHB2HV-FS-150D50	
ASD-UHB2HV-FS-200D50	

For most up-to-date spec sheets please refer to asd-lighting.com



LED UFO NSF HIGH BAY

BATTERY BACK-UP KIT INFORMATION

BLD-UM40R sold separately:

BLD-UM40R, listed for field and factory installation, provides constant power output to the load during emergency mode operation. They maintain illumination in emergency mode for a minimum of 90 minutes. It is an ideal emergency solution for UFO LED highbay lights.

- ▶ Universal input range
- ▶ Works with AC/DC Motion sensors
- ▶ Field and factory installation
- ▶ IP65 for dry, damp and wet location
- ▶ 40W & 90mins durable emergency operating time
- ▶ Surge L-N: 3KV; L&N-PE: 3KV
- ▶ Protection: over-voltage, short-circuit, over-load, open-circuit
- ▶ Li-ion safety batteries
- ▶ Link to the input of LED drivers
- ▶ Remote test via handheld controller
- ▶ Self-diagnostic every month and year
- ▶ 5-year warranty from manufacture date
- ▶ Remote controller (sold separately)



For more information please see the cut sheet from the package.

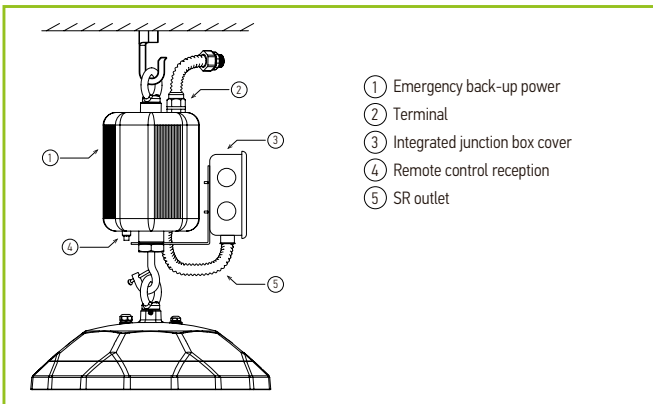

Specifications	
Input Voltage	100-347 V
Input Current	≤ 200 mA
Input Power	15 W Max.
Standby Input Power	< 0.8 W (Finished charging)
Maximum standby time between Recharges	6 Months
Driver Type	Constant power
Output Power (Emergency Mode)	40 W
Output Voltage Range	≤ 175 Vdc
Lumens	6,187 lm
Maximum Load Power	300 W (When dimming to a minimum, the power needs to be less than 36W)
Peak Output Power (Emergency Mode)	100 W (last time 10 seconds)
Number of Output Channels	1 Channel
RFI/EMI	FCC Part 15 Class B
Output Type	LED Class 1
Battery Type	Li-ion
Battery Capacity Available	2600 mAh (96 WH)
Battery Recharge Time	24 Hours
Battery Discharge Time	90 Min.
Maximum lighting fixture weight	44.1 lbs (20 Kg)
Self-Diagnostic Test System	In the normal charging mode, the system performs a self-diagnostic test every 30 days, the system switches to emergency mode for 30S, and then automatically switches back to the normal charging mode.
	In the normal charging mode, the system switches to emergency mode every 360 days (after 11 Monthly self-diagnostic test) and works until the end of discharge. Automatically switches back to normal charging mode after discharge.
Ambient Operating Temperature Range	-22°F to 140°F (30°C to 60°C)
Service Life	50,000 hours
Maximum mounting height	36 FT (11 m)
Input Surge Protection	2 KV
Protections	Battery Over Discharge Protection
	Output Short Circuit Protection
Approvals/Class	RoHS, UL924 Listed, CEC Title 20 Dry, Wet Locations

REMOTE TEST SWITCH RN1 sold separately:



- ▶ Press the ON button to switch battery to the back-up mode. The indicator light will turn off and fixture will decrease light output.
- ▶ Press OFF to switch the fixture to normal operation mode.

For most up-to-date spec sheets please refer to asd-lighting.com



LED UFO NSF HIGH BAY

INSTALLATION GUIDE

IMPORTANT SAFETY INFORMATION:

Please read all the instructions below before installation.

- ▶ Make sure that the supply voltage corresponds to the rated product voltage.
- ▶ The product must be installed by a qualified electrician in accordance with the National Electrical Code and corresponding local codes.
- ▶ If the product is damaged, do not use it.

⚠ WARNING

RISK OF PERSONAL INJURY – READ and follow all WARNINGS and installation instructions.

Keep or give to the owner for future reference.

Risk of cuts: Wear gloves to prevent cuts or abrasions when removing from carton, handling, installing, and maintaining this product.

Risk of electric shock: This product must be installed in accordance with the applicable installation code by a person familiar with the construction and operation of the product and the hazards involved.

Risk of Fire: Minimum 194°F supply conductors. Consult a qualified electrician to ensure correct branch circuit conductor.

ASD® assumes no responsibility for claims arising out of improper or careless installation or handling of this product.

INSTALLATION STEPS:

1. Screw the mounting ring into the top of the fixture.
2. Hang the fixture from the ceiling or other surface using a hook or chain (not provided).
3. Connect the wires: Black to Black, White to White, Green to Green. If you are not using the dimming wires cap them off but not together.

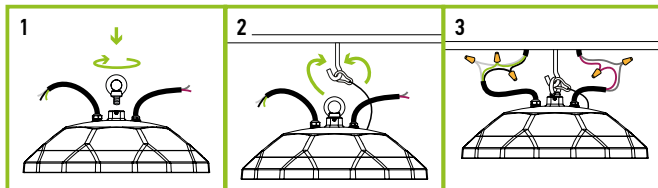

ELECTRICAL SCHEMATIC DIAGRAM:

UHB2-FS

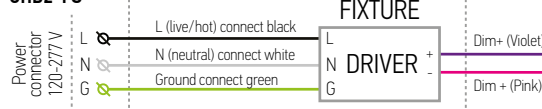

UHB2HV-FS high voltage

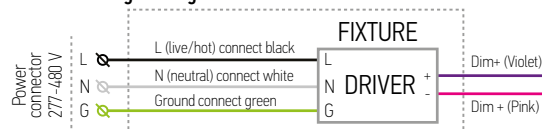

UHB2-FS with battery back-up kit

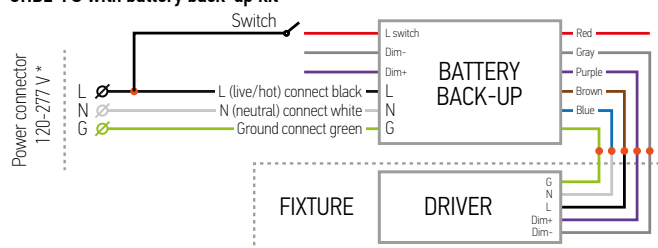

BATTERY BACK-UP KIT INSTALLATION

BLD-UM40R sold separately:

1. Attach the emergency back-up ring to the ceiling hook.
2. Loosen the screw on the enclosed hook on the bottom of emergency back-up, attach the ring on the fixture to the hook and tighten screw back.
3. Loosen the screw on the cover of the junction box, open knock-out hole on the bottom, plug the fixture's power input cable and male wiring as shown on wiring schematic diagram. Close cover of the junction box and tighten screw.

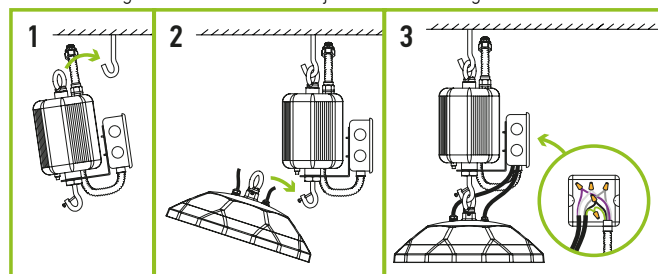

ORDERING INFORMATION

Model	Pcs. per Carton	Carton Size	Carton Weight	GTIN 14
ASD-UHB-FS-100D50-PRM	1	15.1" x 15.1" x 7.8"	14.6 lb	819201026036
ASD-UHB2-FS-150D50	1	18.7" x 18.7" x 7.5"	15.7 lb	810050734424
ASD-UHB2-FS-200D50	1	18.7" x 18.7" x 7.5"	17.9 lb	810050734431
UHB2HV-FS HIGH VOLTAGE				
ASD-UHB2HV-FS-150D50	1	18.7" x 18.7" x 7.5"	16.1 lb	810050737388
ASD-UHB2HV-FS-200D50	1	18.7" x 18.7" x 7.5"	19.2 lb	810050737395

ACCESSORIES:

Model	Name	Weight	Dimensions (LxWxH)	Pcs. per Carton	Carton Size	Carton Weight	UPC	GTIN 14 for Carton
BLD-UM40R	Battery back-up kit 40 W	7.3 lb	4 9/16" x 4 9/16" x 12 3/16"	2	18.1" x 16.9" x 7.1"	16.4 lb	810050735216	20810050735210
RN1	Remote test switch for BLD-UM40R	0.1 lb	5 1/8" x 1 1/4" x 5/8"	20	5.9" x 8.5" x 4.5"	2.4 lb	810050735223	10810050735220

For most up-to-date spec sheets please refer to asd-lighting.com

ASD LIGHTING CORP

E-mail: orders@asd-lighting.com | Web site: www.asd-lighting.com

