

ASD[®] LED SLIM CANOPY

► **DESIGN** - LED SLIM CANOPY has a die-cast aluminum housing with excellent heat dissipation and anti-glare PC lens with even light distribution. It is designed to operate on 120-277 circuits.

► **MOTION SENSOR** - The built-in microwave motion sensor will turn off the fixture automatically when no motion is detected.

► Surge protection 5kV protects the fixture from voltage spikes and current surges.

► **INSTALLATION** - The fixture is Wet Locations rated and can be either surface mounted or pole mounted. Perfect commercial or industrial solution for parking garages, gas stations, stairwells, passageways, underpasses, and many other applications.

► **ADVANTAGES** - With calculated lifespan up to 141,000 hours, these fixtures are made to last decades under normal operation! ASD provides a 10-year limited warranty along with ETL and DLC Premium certifications to guarantee top quality products and safety!

Catalog number	
Notes	
Type	

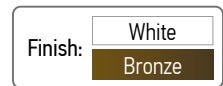

Model	Watts	Voltage	Dimmable	Lumens	CCT	Finish	Dimensions (LxWxH)	Option
ASD-CAN05-45D40-WH-PRM	45W	120-277 V	0-10 V	5,500 lm	4,000 K	White	9-5/8" x 9-5/8" x 3-7/16"	-
ASD-CAN05-45D50-WH-PRM	45W	120-277 V	0-10 V	5,500 lm	5,000 K	White	9-5/8" x 9-5/8" x 3-7/16"	-
ASD-CAN05-45D40-BZ-PRM	45W	120-277 V	0-10 V	5,500 lm	4,000 K	Bronze	9-5/8" x 9-5/8" x 3-7/16"	-
ASD-CAN05-45D50-BZ-PRM	45W	120-277 V	0-10 V	5,500 lm	5,000 K	Bronze	9-5/8" x 9-5/8" x 3-7/16"	-
ASD-CAN05-70D40-WH-PRM	70W	120-277 V	0-10 V	8,400 lm	4,000 K	White	9-5/8" x 9-5/8" x 3-7/16"	-
ASD-CAN05-70D50-WH-PRM	70W	120-277 V	0-10 V	8,400 lm	5,000 K	White	9-5/8" x 9-5/8" x 3-7/16"	-
ASD-CAN05-70D40-BZ-PRM	70W	120-277 V	0-10 V	8,400 lm	4,000 K	Bronze	9-5/8" x 9-5/8" x 3-7/16"	-
ASD-CAN05-70D50-BZ-PRM	70W	120-277 V	0-10 V	8,400 lm	5,000 K	Bronze	9-5/8" x 9-5/8" x 3-7/16"	-
ASD-CAN05-100D50-WH-PRM	100W	120-277 V	0-10 V	12,050 lm	5,000 K	White	11" x 11" x 3-5/8"	-
ASD-CAN05-100D50-BZ-PRM	100W	120-277 V	0-10 V	12,050 lm	5,000 K	Bronze	11" x 11" x 3-5/8"	-
CAN05-MS WITH MOTION SENSOR								
ASD-CAN05-45D50-BZ-MS-PRM	45W	120-277 V	0-10 V	5,500 lm	5,000 K	Bronze	9-5/8" x 9-5/8" x 3-7/16"	Motion sensor
ASD-CAN05-70D50-BZ-MS-PRM	70W	120-277 V	0-10 V	8,400 lm	5,000 K	Bronze	9-5/8" x 9-5/8" x 3-7/16"	Motion sensor

PRODUCT SPECIFICATIONS:

Construction & Materials						
Housing	Aluminum					
Reflector	Aluminum					
Lens	PC					
Finish	White, Bronze					
Weight	5.1 lbs (2.3 kg) for ASD-CAN05-100D50-WH-PRM and ASD-CAN05-100D50-BZ-PRM models: 5.5 lbs (2.5 kg)					
Environmental system						
Work environment	Suitable for Wet Locations, IP65					
Operating temperature	-4°F to 104°F (-20°C to 40°C)					
L-70 Life	R > 54,000 hrs; C > 141,000 hrs for MS models: R > 36,000 hrs; C > 141,000 hrs					
Optical system						
Luminous flux	ASD-CAN05-45D40-WH-PRM ASD-CAN05-45D50-WH-PRM ASD-CAN05-45D40-BZ-PRM ASD-CAN05-45D50-BZ-PRM	5,500 lm	ASD-CAN05-70D40-WH-PRM ASD-CAN05-70D50-WH-PRM ASD-CAN05-70D40-BZ-PRM ASD-CAN05-70D50-BZ-PRM	8,400 lm	ASD-CAN05-100D50-WH-PRM ASD-CAN05-100D50-BZ-PRM ASD-CAN05-45D50-BZ-MS-PRM ASD-CAN05-70D50-BZ-MS-PRM	12,050 lm 5,500 lm 8,400 lm
	Color temperature	4,000K; 5,000 K				
	CRI	> 70				

For most up-to-date spec sheets please refer to asd-lighting.com

ASD LIGHTING CORP

E-mail: orders@asd-lighting.com | Web site: www.asd-lighting.com





LED SLIM CANOPY

Electrical system						
Input voltage	120-277 V					
Max input current	ASD-CAN05-45D40-WH-PRM	0.4 A	ASD-CAN05-70D40-WH-PRM	0.6 A	ASD-CAN05-100D50-WH-PRM	0.9 A
	ASD-CAN05-45D50-WH-PRM		ASD-CAN05-70D50-WH-PRM		ASD-CAN05-100D50-BZ-PRM	
	ASD-CAN05-45D40-BZ-PRM		ASD-CAN05-70D40-BZ-PRM		ASD-CAN05-45D50-BZ-MS-PRM	0.4 A
	ASD-CAN05-45D50-BZ-PRM		ASD-CAN05-70D50-BZ-PRM		ASD-CAN05-70D50-BZ-MS-PRM	0.6 A
Inrush current (Action time)	35 A (0.11 S)					
Off state power	0W					
Power consumption	ASD-CAN05-45D40-WH-PRM	45W	ASD-CAN05-70D40-WH-PRM	70W	ASD-CAN05-100D50-WH-PRM	100W
	ASD-CAN05-45D50-WH-PRM		ASD-CAN05-70D50-WH-PRM		ASD-CAN05-100D50-BZ-PRM	
	ASD-CAN05-45D40-BZ-PRM		ASD-CAN05-70D40-BZ-PRM		ASD-CAN05-45D50-BZ-MS-PRM	45W
	ASD-CAN05-45D50-BZ-PRM		ASD-CAN05-70D50-BZ-PRM		ASD-CAN05-70D50-BZ-MS-PRM	70W
Power factor	> 0.9					
Surge protection DM/CM	5 kV / 5 kV					

Dimming compatible controls										
Brand	Lutron								Leviton	
Models	DVSTV-WH	DVSTV-BR	DVSTV-GR	DVSTV-LA	DVSTV-BL	DVSTV-AL	DVSTV-IV	AWSMT-7DW	DS 710-10Z	

Regular and voluntary certifications

10-year limited warranty (for models ASD-CAN05-100D50-BZ-PRM and ASD-CAN05-100D50-WH-PRM 5-year limited warranty)

DesignLights Consortium (DLC) listed (Classification: Premium)
Main: Outdoor luminaires; General application: Mid output;
Primary use: Parking garage luminaires

UL certified E473804
(for models ASD-CAN05-100D50-BZ-PRM and ASD-CAN05-100D50-WH-PRM)

cETLus certified 4008281

PACKAGE CONTENTS:

Description	Q-ty
LED Slim Canopy	1
Mounting plate (A)	1
Wire nut (B)	3
Screw M4*40 (C)	2
Screw M4*20 (D)	2
Box	1

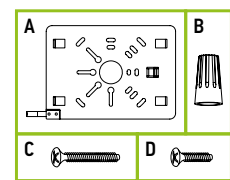

* The list of dimmers is relevant for models without a motion sensor.

BUILT-IN MOTION SENSOR INFORMATION

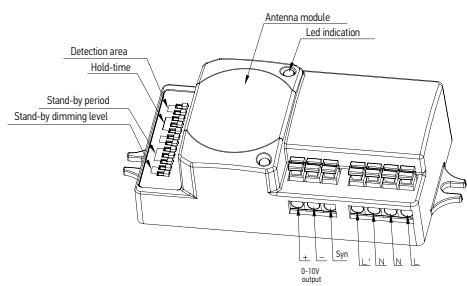

1. Make sure the fixture is cut off from the power supply. Remove 4 screws and detach the diffuser, remove 2 screws and take out the reflector.
2. Set up the motion sensor according to the specification.
3. Attach the reflector, the diffuser, tighten all the screws then mount the fixture.

Specifications				
Operating voltage	120-277 V			
Switched power	max capacitive load: 800W @ 277 V, 400W @ 120 V			
Standby power	Approx 0.5W			
Warm time	20 S			
Detection area	100 %/75 %/50 %/10 %, can be customized			
Hold time	5 S / 30 S / 1 min / 5 min / 10 min / 20 min / 30 min, can be customized			
Standby period	0 S/10 S/1 min/5 min/10 min/30 min/1 h/+ can be customized			
Standby dimming level	10 %/20 %/30 %/50 % can be customized			
Sensor principle	Microwave motion detector			
Microwave frequency	5.8 GHz + / - 75 MHz			
Microwave power	< 0.2 mW			
Detection range	max 59 ft x 33 ft			
Detection angle	30° - 150°			
Mounting height	max 33 ft			
Operating temperature	-31° to 158° F			
IP rating	IP20			
Default settings				
	Detection area	Hold time	Stand-by period	Stand-by dimming
	100 %	10 min	0 S	10 %

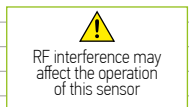

ON ↑	1	2	
I	ON	ON	100%
II	ON	-	75%
III	-	ON	50%
IV	-	-	10%

Detection area:
Detection area can be reduced by selecting the combination on the DIP switches to fit precisely for each specific application.

ON ↑	3	4	5	
I	ON	ON	ON	5s
II	ON	ON	-	30s
III	ON	-	ON	1min
IV	ON	-	-	5min
V	-	ON	ON	10min
VI	-	ON	-	20min
VII	-	-	-	30min

Hold time:
Hold-time means the time period you would like to keep the lamp on 100% after the person has left the detection area.

ON ↑	8	9	10	
I	ON	ON	ON	0S
II	ON	ON	-	10S
III	ON	-	ON	1min
IV	ON	-	-	5min
V	-	ON	ON	10min
VI	-	ON	-	30min
VII	-	-	ON	1h
	-	-	-	+∞

Stand by period:
This is the time period you would like to keep at the low light output level before it is completely switched off in the long absence of people.

ON ↑	11	12	
I	ON	ON	10%
II	ON	-	20%
III	-	ON	30%
IV	-	-	50%

Stand by dimming level:
This is the dimmed low light output level you would like to have after the hold-time in the absence of people.

For most up-to-date spec sheets please refer to asd-lighting.com



LED SLIM CANOPY

INSTALLATION GUIDE

IMPORTANT SAFETY INFORMATION:

Please read all the instructions below before installation.

- ▶ Make sure that the supply voltage corresponds to the rated product voltage.
- ▶ The product must be installed by a qualified electrician in accordance with the National Electrical Code and corresponding local codes.
- ▶ If the product is damaged, do not use it.

⚠ WARNING

RISK OF PERSONAL INJURY – READ and follow all WARNINGS and installation instructions. Keep or give to the owner for future reference.

Risk of cuts: Wear gloves to prevent cuts or abrasions when removing from carton, handling, installing, and maintaining this product.

Risk of electric shock: This product must be installed in accordance with the applicable installation code by a person familiar with the construction and operation of the product and the hazards involved.

Risk of Fire: Minimum 194°F supply conductors. Consult a qualified electrician to ensure correct branch circuit conductor.

ASD® assumes no responsibility for claims arising out of improper or careless installation or handling of this product.

POLE MOUNTING INSTALLATION:

1. Connect the wires: Black to Black, White to White, Green to Green. Carefully tuck all wires back into the pole.
2. Screw the fixture to the G1/2" threaded conduit.

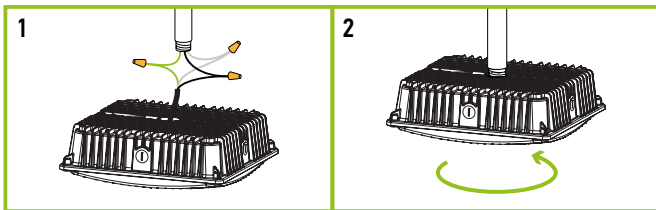

ELECTRICAL SCHEMATIC DIAGRAM:

CAN05

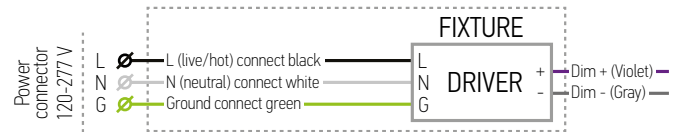

CAN05-MS with motion sensor

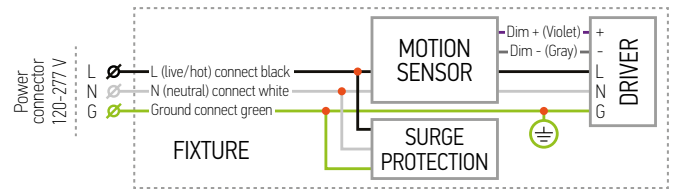

SURFACE MOUNT WITH A MOUNTING PLATE:

1. Turn off the power supply. Remove the securing screw out of the mounting plate, detach the mounting plate from the fixture housing and attach the plate to a j-box on your ceiling. If the fixture is equipped with a motion sensor, set up the motion sensor before mounting the fixture.
2. Hang the fixture on the plate with the hook. Connect the wires according to the wiring diagram, if the dimming line is not in use, cap the dimming wires, but not connect them.
3. Slide the fixture into the mounting plate clamps and fix it with the securing screw. Turn on the power supply.

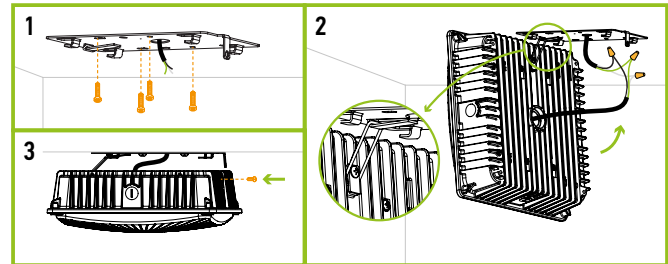

ORDERING INFORMATION

Model	Pcs. per carton	Carton size	Carton weight	UPC
ASD-CAN05-45D40-WH-PRM	1	12" x 10.6" x 5.5"	5.7 lbs	810050734127
ASD-CAN05-45D50-WH-PRM	1	12" x 10.6" x 5.5"	5.7 lbs	819201027316
ASD-CAN05-45D40-BZ-PRM	1	12" x 10.6" x 5.5"	5.7 lbs	810050734387
ASD-CAN05-45D50-BZ-PRM	1	12" x 10.6" x 5.5"	5.7 lbs	810050734394
ASD-CAN05-70D40-WH-PRM	1	12" x 10.6" x 5.5"	5.7 lbs	810050734134
ASD-CAN05-70D50-WH-PRM	1	12" x 10.6" x 5.5"	5.7 lbs	810050734417
ASD-CAN05-70D40-BZ-PRM	1	12" x 10.6" x 5.5"	5.7 lbs	810050734400
ASD-CAN05-70D50-BZ-PRM	1	12" x 10.6" x 5.5"	5.7 lbs	819201027323
ASD-CAN05-100D50-WH-PRM	1	12.6" x 12.6" x 5.1"	6.6 lbs	810050735056
ASD-CAN05-100D50-BZ-PRM	1	12.6" x 12.6" x 5.1"	6.6 lbs	810050735063
CAN05-MS WITH MOTION SENSOR				
ASD-CAN05-45D50-BZ-MS-PRM	1	12" x 10.6" x 5.5"	5.7 lbs	819201027330
ASD-CAN05-70D50-BZ-MS-PRM	1	12" x 10.6" x 5.5"	5.7 lbs	819201027347

For most up-to-date spec sheets please refer to asd-lighting.com

ASD LIGHTING CORP

E-mail: orders@asd-lighting.com | Web site: www.asd-lighting.com

