

ASD[®] LED WRAP FIXTURE

► **DESIGN** - LED WRAP FIXTURE has durable commercial grade housing resistant to rust and impact along with an anti-glare PMMA lens provide many years of use. It is designed to operate on 120-277V circuits.

► **DIMMING** - Smooth 0-10V dimming capabilities ranging from 10% to 100% with modern LED dimmers allow you to control the look and feel of your space.

► **COLOR AND POWER SELECTABLE** - You can choose either a 3,500K neutral white, 4,000K cool white or 5,000K daylight color temperature, and change the power with a simple switch.

► **APPLICATION** - Perfect commercial or industrial solution for office buildings, schools, hospitals, hallways, stairwells, workshops, and many other applications. It is also Damp Locations rated.

► **ADVANTAGES** - With calculated lifespan up to 190,000 hours, these fixtures are made to last decades under normal operation! ASD provides a 5-year limited warranty along with UL and DLC Standard certifications to guarantee top quality products and safety!

Catalog number	
Notes	
Type	



WRL

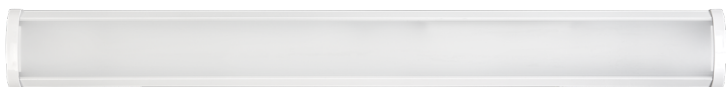

WRL2



PRODUCT PRESENTATION:

Model	Type	Power	Voltage	Dimmable	Lumens	CCT	Finish	Dimensions	Cord	Pre-installed	Certification
ASD-WRL-4A48AC	4 ft	32/40/48W	120-277 V	0-10 V	up to 5,583 lm	3CCT (3,500/4,000/5,000 K)	White	47-5/8" x 5-5/16" x 2-1/8"	1.5 ft	-	UL, DLC Standard
ASD-WRL2-4A45AC	4 ft	34/38/45W	120-277 V	0-10 V	up to 6,312 lm	3CCT (3,500/4,000/5,000 K)	White	46" x 9-3/4" x 3-7/16"	1.5 ft	-	UL, DLC Premium
WRL-EM WITH BATTERY BACK-UP											
ASD-WRL-4A48AC-8EM	4 ft	32/40/48W	120-277 V	0-10 V	up to 5,583 lm	3CCT (3,500/4,000/5,000 K)	White	47-5/8" x 5-5/16" x 2-1/8"	1.5 ft	6W Battery back up	UL, DLC Standard

For detailed luminous flux information please refer to Annex 1, page 2.

TECHNICAL PARAMETERS:

Application area	Series	Model	Work environment	Operating temperature	Power factor	Housing	Lens	CRI
COMMERCIAL	WRL	ASD-WRL-4A48AC	Damp location	-4°F to 122°F (-20°C to 50°C)	> 0,9	Steel	PMMA	> 80
		ASD-WRL2-4A45AC	Damp location	-4°F to 122°F (-20°C to 50°C)	> 0,9	Steel	PMMA	> 80
		WRL-EM WITH BATTERY BACK-UP						
		ASD-WRL-4A48AC-8EM	Damp location	-4°F to 122°F (-20°C to 50°C)	> 0,9	Steel	PMMA	> 80

DIMMING COMPATIBLE CONTROLS:

Brand	Eaton	Cooper	Lutron
Models	DF10P	SF10P	Arrow Hart Diva DVSTV

PACKAGE CONTENTS:

Description	Quantity
LED Wrap Fixture	1
Box	1

For most up-to-date spec sheets please refer to asd-lighting.com

ASD® LED WRAP FIXTURE

BUILT-IN BATTERY BACK-UP INFORMATION

Power	Lumen	Battery capacity	Emergency time	Charging time
8W	1,265 lm	2,500 mAh	90 minutes	≥ 24 hours

ANNEX 1

Model	Watts	3,500 K	4,000 K	5,000 K
ASD-WRL-4A48AC	32W	3,981 lm	4,149 lm	4,053 lm
	40W	4,781 lm	5,020 lm	4,869 lm
	48W	5,483 lm	5,796 lm	5,583 lm
ASD-WRL2-4A45AC	34W	4,795 lm	4,965 lm	4,840 lm
	38W	5,390 lm	5,605 lm	5,444 lm
	45W	6,257 lm	6,524 lm	5,444 lm

INSTALLATION GUIDE

IMPORTANT SAFETY INFORMATION:

Please read all the instructions below before installation!

- ▶ Make sure that the supply voltage corresponds to the rated product voltage.
- ▶ The product must be installed by a qualified electrician in accordance with the National Electrical Code and corresponding local codes.
- ▶ If the product is damaged, do not use it.

ELECTRICAL SCHEMATIC DIAGRAM:

WRL

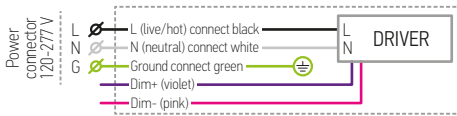

WRL multiple fixture connection

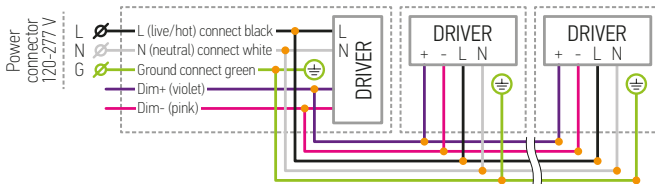

MAXIMUM NUMBER OF LINKABLE ITEMS:

Model	Watts	Voltage	Multiple
ASD-WRL-4A48AC	32W	120 V	17 pcs
		277 V	37 pcs
	40W	120 V	14 pcs
		277 V	33 pcs
48W	120 V	11 pcs	
	277 V	28 pcs	
ASD-WRL2-4A45AC	34W	120 V	16 pcs
		277 V	39 pcs
	38W	120 V	14 pcs
		277 V	31 pcs
	45W	120 V	12 pcs
		277 V	26 pcs

⚠ WARNING

Risk of personal injury – read and follow all warnings and installation instructions. Keep or give to the owner for future reference.

Risk of cuts: Wear gloves to prevent cuts or abrasions when removing from carton, handling, installing, and maintaining this product.

Risk of electric shock: This product must be installed in accordance with the applicable installation code by a person familiar with the construction and operation of the product and the hazards involved.

Risk of Fire: Minimum 194°F supply conductors. Consult a qualified electrician to ensure correct branch circuit conductor.

ASD® assumes no responsibility for claims arising out of improper or careless installation or handling of this product.

SURFACE MOUNT INSTALLATION:

1. Secure the baffle onto the back of the fixture with screws.
2. Open the fixture by pressing the area between the narrow rectangular hole and snap-lock. Connect the wires: Black to Black, White to White, Green to Green.
3. Secure the luminaire to the ceiling with the plastic anchors and screws (not included). Choose needed power and color temperature by adjusting the switch. Assemble lighting fixture.

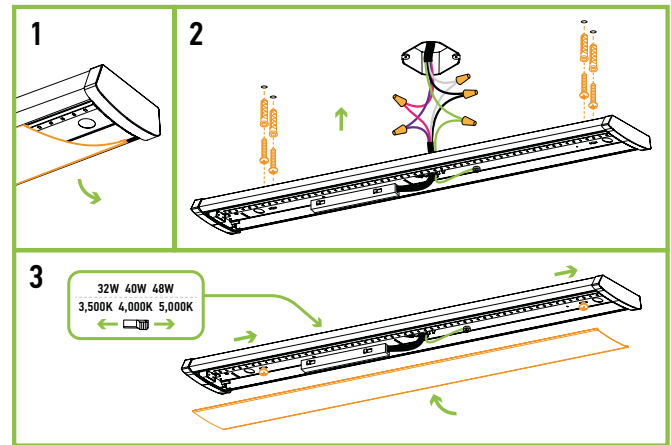

TRANSPORTATION DATA

Application area	Series	Model	Product dimensions	Weight	UPC	Pcs. per carton	Carton size	Carton weight	GTIN 14	
COMMERCIAL	WRL	ASD-WRL-4A48AC	47-5/8" x 5-5/16" x 2-1/8"	4.7 lbs (2.1 kg)	810128114523	4	49.1" x 10.6" x 6.3"	20.9 lbs	10810128114520	
		ASD-WRL2-4A45AC	46" x 9-3/4" x 3-7/16"	7 lbs (3.2 kg)	810128115476	1	48.1" x 10.9" x 4"	11 lbs	-	
		WRL-EM WITH BATTERY BACK-UP								
		ASD-WRL-4A48AC-8EM	47-5/8" x 5-5/16" x 2-1/8"	4.7 lbs (2.1 kg)	810128119672	4	49.1" x 10.6" x 6.3"	20.9 lbs	10810128119679	

For most up-to-date spec sheets please refer to asd-lighting.com